



Day & Co  
ESTATE AGENTS

28 Cavendish Street  
Keighley  
BD21 3RG



5 Harden Croft, Harden Road,  
Keighley, West Yorkshire, BD21  
4FD

£235,000

T: 01535 664609

W: [www.dayandcoestateagents.co.uk](http://www.dayandcoestateagents.co.uk)

E: [keighley@dayandcoestateagents.co.uk](mailto:keighley@dayandcoestateagents.co.uk)

- Spacious Modern Semi-Detached
- Accommodation Over Three Floors
- Rear Artificial Lawn & Patio

- Four Bedrooms & Master En-Suite
- Drive & Integral Garage
- Far Reaching Views/Excellent Access To The Primary School

## SUMMARY

**\*\*A SPACIOUS 4 BEDROOM (MASTER EN-SUITE) MODERN SEMI-DETACHED FAMILY HOME, FAR REACHING VIEWS IN POPULAR LOCATION OF LONG LEE!\*\*** Having accommodation over 3 floors, Drive, integral garage, well maintained enclosed rear artificial lawn, far reaching views - EXCELLENT ACCESS TO THE LOCAL PRIMARY SCHOOL!! Awaiting EPC.

## FULL DESCRIPTION

An ideal purchase for the growing family is this spacious modern four bedroom (master en-suite) semi-detached property situated in a pleasant cul-de-sac position in the ever popular location of Long Lee. The three storey property comprises of an entrance hall giving access to a cloaks WC and the integral garage. The master bedroom is on this level having double glazed patio doors to the rear and an en-suite shower room with shower cubicle, WC, wash hand basin. To the first floor is a superb open plan living room and kitchen diner, with a range of modern base and wall mounted units, integrated appliances to include fridge, freezer, dishwasher, five ring gas hob, double glazed patio doors to a Juliet balcony enjoying far reaching views to the rear. To the second floor there are a further three bedrooms, and the house bathroom which has a three piece suite comprising a bath with shower over, WC, wash hand basin, double glazed Velux window. Externally the property has a drive to the front leading to the integral garage, to the rear is a well maintained artificial lawn and patio with gate giving access to the front of the property. Viewing essential to fully appreciate, awaiting EPC.

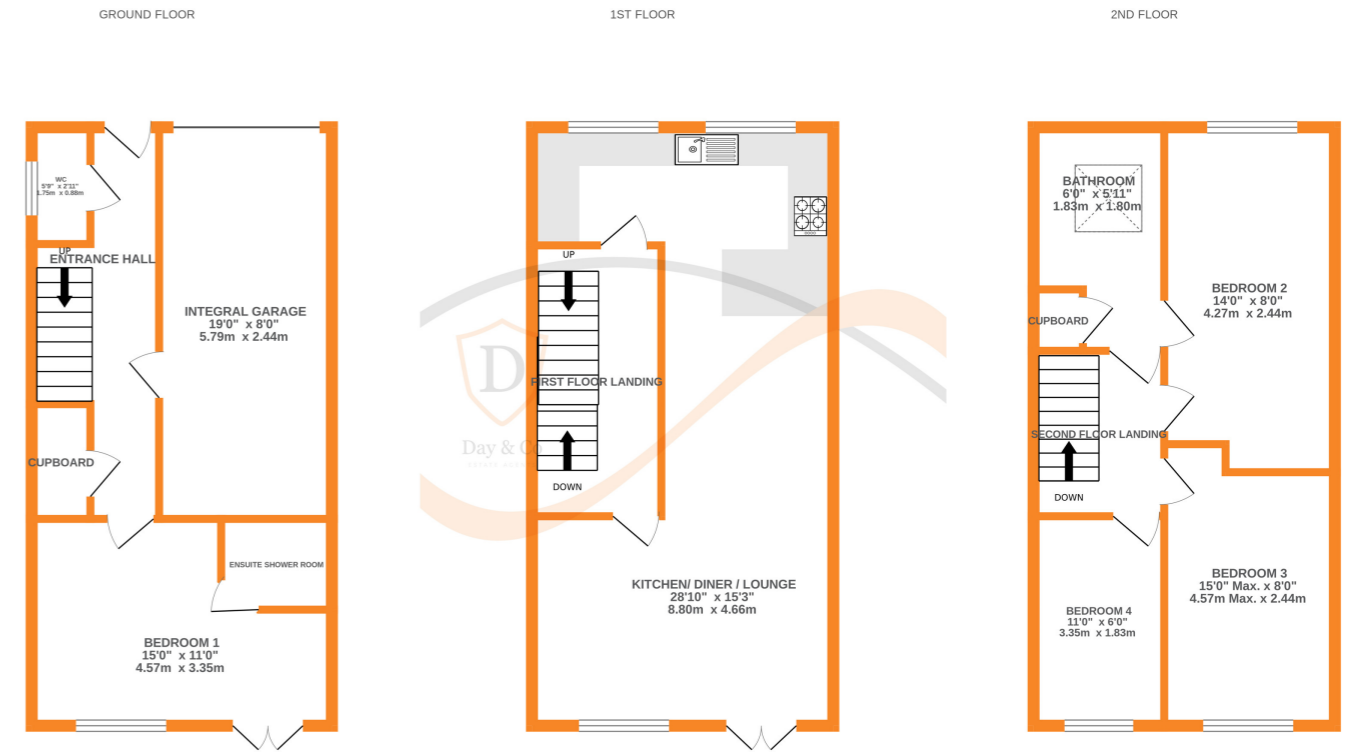

Whilst every attempt has been made to ensure the accuracy of the floorplan contained here, measurements of doors, windows, rooms and any other items are approximate and no responsibility is taken for any error, omission or mis-statement. This plan is for illustrative purposes only and should be used as such by any prospective purchaser. The services, systems and appliances shown have not been tested and no guarantee as to their operability or efficiency can be given.  
Made with Metropix 62024