



This four bedroom semi-detached property, located a short distance to Heathrow terminal 5, has been largely extended creating a family home that stretches across 1467 square ft.

The property comprises two reception rooms that include an impressive 23ft living room, and separate dining room that opens to a conservatory. A galley-style kitchen lies down the left hand side of the house and offers access to a convenient downstairs cloakroom.

The first floor features three bedrooms, all with fitted wardrobes, and a family bathroom, whilst the loft space has been converted to provide a 14ft master bedroom with plenty of storage options.

Externally, the property benefits driveway parking, garage to the rear, and a south-facing garden that enjoys lots of sunlight throughout the day.

Nearby schools including Colnbrook CofE Primary are within walking distance however the historic village of Colnbrook sits a commutable distance from Langley where many popular schools including Langley Grammar School are situated.

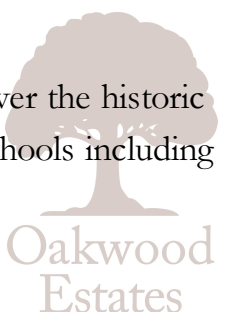

Property Information

-  FOUR BEDROOM EXTENDED SEMI-DETACHED HOUSE
-  DOWNSTAIRS CLOAKROOM
-  LARGE KITCHEN
-  FITTED WARDROBES TO ALL BEDROOMS
-  GARAGE AND DRIVEWAY PARKING
-  SHORT COMMUTE TO HEATHROW T5
-  TWO RECEPTION ROOMS PLUS CONSERVATORY
-  14FT LOFT ROOM
-  SOUTH-FACING REAR GARDEN
-  1467 SQUARE FT

x4
Bedrooms

x2
Reception Rooms

x2
Bathrooms

x2
Parking Spaces

Y
Garden

Y
Garage

Transport Links

NEAREST STATIONS:

- Heathrow Terminal 5 - 1.4 miles
- Iver - 1.8 miles
- Sunnymeads - 2 miles
- Wraysbury - 2 miles
- Langley - 2.1 miles

Local Schools

PRIMARY SCHOOLS:

- Colnbrook Church of England Primary School
550 yards
- Pippins School
560 yards
- Foxborough Primary School
1.4 miles
- Harmondsworth Primary School
1.6 miles
- Holy Family Catholic Primary School
1.6 miles
- The Langley Heritage Primary
1.6 miles
- Marish Primary School
1.8 miles

Langley Hall Primary Academy
1.9 miles

SECONDARY SCHOOLS:

- Langley Grammar School
1.9 miles
- The Langley Academy
2.2 miles
- Langley Hall Arts Academy
2.3 miles
- Ditton Park Academy
2.6 miles
- Churchmead Church of England (VA) School
2.7 miles
- St Bernard's Catholic Grammar School
2.9 miles
- Upton Court Grammar School
3.1 miles

Council Tax

Band D

Floor Plan

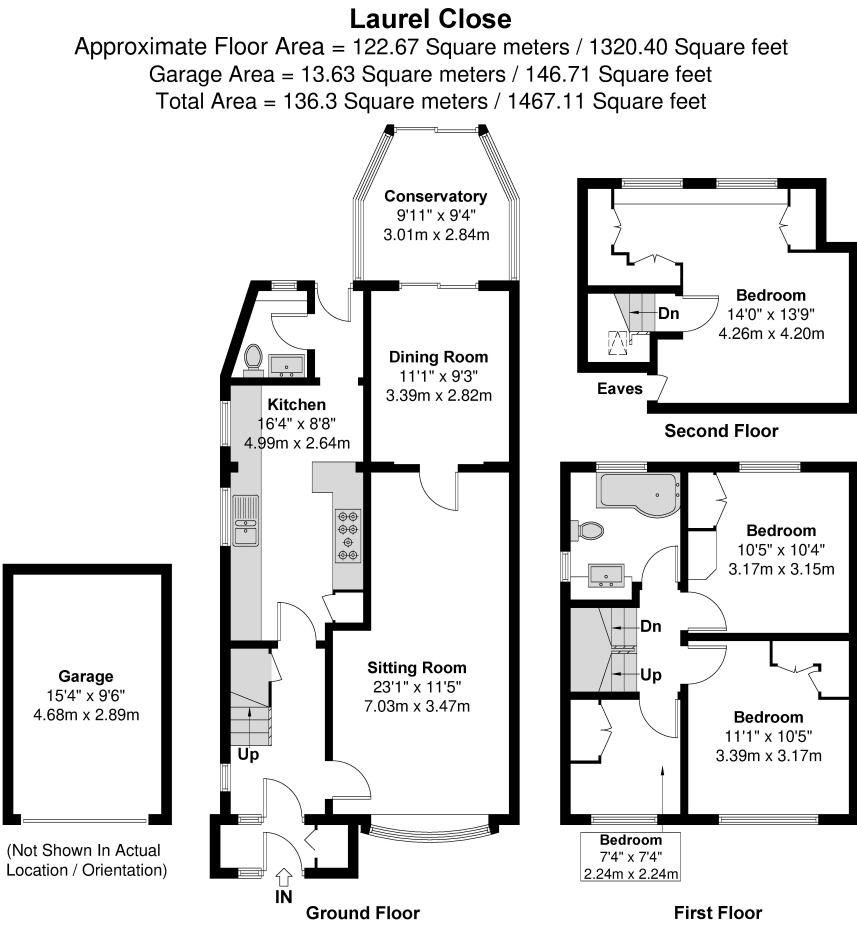

Prospective purchasers should be aware that these sales particulars are intended as a general guide only and room sizes should not be relied upon for carpets or furnishing. We have not carried out any form of survey nor have we tested any appliance or services, mechanical or electrical. All maps are supplied by Goview.co.uk from Ordnance Survey mapping. Care has been taken in the preparation of these sales particulars, which are thought to be materially correct, although their accuracy is not guaranteed and they do not form part of any contract.

