



- Three Bedroom Family Home
- Semi Detached
- Corner Plot With Potential To Extend (STPP)
- Sought After Village Of Bocking
- Well Presented Throughout
- Ground Floor Cloakroom
- Garage & Driveway Parking
- Porch & Hallway
- Gas Central Heating & UPVC Windows
- Quiet Location

29 Dorewards Avenue, Braintree, Essex. CM7 5LT.

Michaels Property Consultants are delighted to bring to the market this well established and deceptively spacious three bedroom semi detached house, occupying a fabulous corner plot with the potential for a double-storey extension (STPP), located within the ever sought after village of Bocking. New to the market and offered for sale with a complete onward chain, we feel this superb property lends itself perfectly to a buyer seeking their forever family home. The well presented accommodation comprises an entrance porch & hallway, a ground floor cloakroom, a spacious lounge/diner with French doors out to the rear garden, three well appointed bedrooms, and a family bathroom.



Property Details.

Ground Floor

Entrance Hall

Cloakroom



Living Room/Diner



21' 5" x 11' 5" (6.53m x 3.48m)

Kitchen



8' 9" x 8' 2" (2.67m x 2.49m)

First Floor

Bedroom One



12' 3" x 10' 6" (3.73m x 3.20m)

Property Details.

Bedroom Two



10' 7" x 9' 0" (3.23m x 2.74m)

Bedroom Three

7' 6" x 7' 1" (2.29m x 2.16m)

Bathroom



Outside

Rear Garden



Garage & Driveway

Property Details.

Floorplans

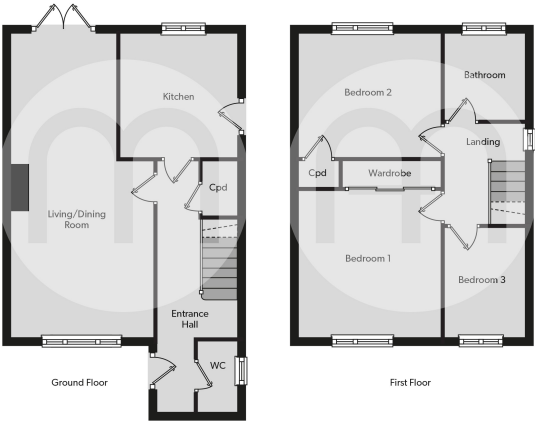

Location

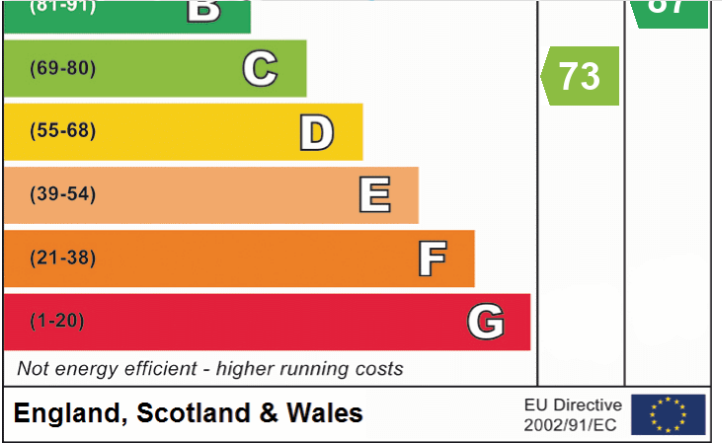

We have not carried out a structural survey and the services, appliances and specific fittings have not been tested. All photographs, measurements, floor plans and distances referred to are given as a guide only and should not be relied upon for the purchase of carpets or any other fixtures or fittings. Gardens, roof terraces, balconies and communal gardens as well as tenure and lease details cannot have their accuracy guaranteed for intending purchasers. Lease details, service ground rent (where applicable) are given as a guide only and should be checked and confirmed by your solicitor prior to exchange of contracts.