

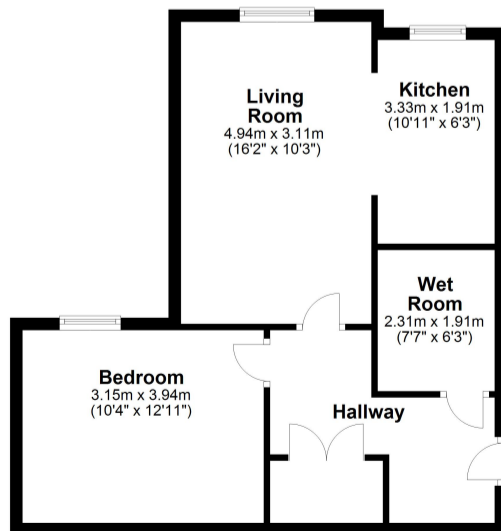

Floor Plan

Approx. 49.6 sq. metres (533.4 sq. feet)



Total area: approx. 49.6 sq. metres (533.4 sq. feet)

All measurements shown are approximate and for guidance only. Garages and workshops are not included in any gross floor areas unless integral to the main building where they will be included.
Plan produced using PlanUp.

Agents note: All measurements are approximate and whilst every attempt has been made to ensure accuracy they are for general guidance only and must not be relied on. The fixture and fittings referred to have not been tested and therefore no guarantee can be given that they are in working order. Internal photographs are reproduced for general information and it must not be inferred that any item shown is included with the property.



A rare opportunity to acquire this well-presented assisted living first floor one bedroom retirement apartment situated within the corner of the sought after Archers Court development close to the centre of Hitchin.

Surrounded by attractive, well maintained gardens and offering a reassuring combination of retirement living together with a dedicated care team available round the clock, the apartment offers a fully fitted kitchen with a washer/dryer, a wet room, fitted wardrobes to the bedroom and overlooks playing fields to the rear.

Set within walking distance of the town centre, a church, health centre and a supermarket.



- First Floor Retirement Apartment
- Assisted Living
- 24 Hour Assistance
- Secure Entry System
- Town Centre Location
- Communal Lounge with Kitchen
- Communal Gardens and Parking
- Lift to all Floors