



**Ripon Road, Stevenage, Hertfordshire, SG1**

**£1,200 pcm**

- AVAILABLE NOW on an unfurnished basis
- Ground floor ONE bedroom apartment
- Refurbished to a SUPERB high specification
- MODERN fitted shower room
- New flooring throughout
- Allocated OFF ROAD parking space
- Just over 2 and a half miles to Stevenage MAINLINE Train Station and Town Centre
- Great road links - Just over 2 and a half miles to the A1(M)





| Beautifully presented ONE bedroom apartment | Fantastic MODERN interior | Large open plan living space | MODERN fitted kitchen | Good Size DOUBLE Bedroom | MODERN shower room | OFF ROAD PARKING |

This brand new one bedroom modern apartment has a clean bright finish and has been finished to a high standard.

Inside on the ground floor the front door open through to a good size open living space, there is a MODERN fitted kitchen, a modern shower room and a good size bedroom.

Nestled in the heart of North Hertfordshire and combining the benefits of town living with the natural beauty of the surrounding countryside, STEVENAGE is an incredibly popular town with great road and rail links.

View ASAP and secure this lovely home before someone else does!

#### | ADDITIONAL INFORMATION

Unfurnished

Available NOW

Deposit - £1,384

Council Tax Band - TBC

EPC Rating - B

Electric Heating

#### | GROUND FLOOR

Open Plan Living: Approx 23' 9" x 10' 4" (7.24m x 3.15m)

Bedroom: Approx 14' 8" x 11' 2" (4.47m x 3.40m)

Shower Room: Approx 7' 6" x 3' 9" (2.29m x 1.14m)

#### | OUTSIDE

Allocated parking space

| Unfurnished GROUND FLOOR Apartment | Newly refurbished | Large open plan living space | Good Size DOUBLE Bedroom | Private OFF ROAD Parking |





### Ground Floor

Approx. 42.7 sq. metres (460.1 sq. feet)

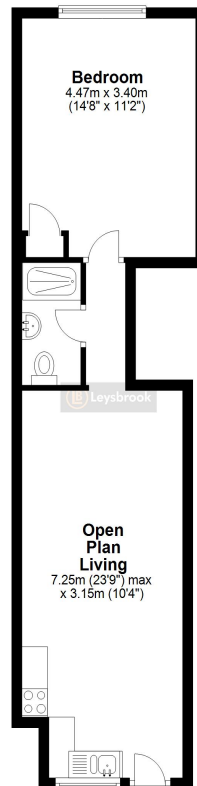

Total area: approx. 42.7 sq. metres (460.1 sq. feet)

Created by Leysbrook for guide purposes only. This plan is NOT TO SCALE and is intended to illustrate the general layout of the property and should be used as such by any prospective purchaser. Whilst every attempt has been made to ensure the accuracy of the floor plan, measurements of doors, windows, rooms and any other items are approximate and no responsibility is taken for any error, omission or mis-statement. The services, systems and appliances shown have not been tested and no guarantee of their operability can be given. Plan produced using PlanUp.

Energy Efficiency Rating		
	Current	Potential
Very energy efficient - lower running costs		
(92+) <b>A</b>		
(81-91) <b>B</b>		
(69-80) <b>C</b>		<b>77</b>
(55-68) <b>D</b>	<b>67</b>	
(39-54) <b>E</b>		
(21-38) <b>F</b>		
(1-20) <b>G</b>		
Not energy efficient - higher running costs		
<b>England, Scotland &amp; Wales</b>	EU Directive 2002/91/EC	