



Darkes Lane, Potters Bar, Hertfordshire, EN6 1BW

£1,150,000

- CONTEMPORARY DETACHED HOUSE
- GARAGE
- MOMENTS FROM POTTERS BAR MAINLINE STATION
- CLOSE TO SHOPS / RESTAURANTS / AMENITIES
- SIX BEDROOMS
- PRIVATE REAR GARDEN
- WALKING DISTANCE TO LOCHINVER AND STORMOUNT SCHOOL
- GATED DRIVEWAY WITH OFF STREET PARKING

108, High Street, Potters Bar, EN6 5AT

01707 245 555

www.home-counties.com

Darkes Lane, Potters Bar, Hertfordshire, . EN6 1BW

£1,150,000 Freehold

Potterswood House Potterswood House is a contemporary, gated six-bedroom detached family home, originally built over 20 years ago and extensively modernized by the current owners. This property is ideally situated near Potters Bar Station and High Road, offering an excellent combination of convenience and accessibility.

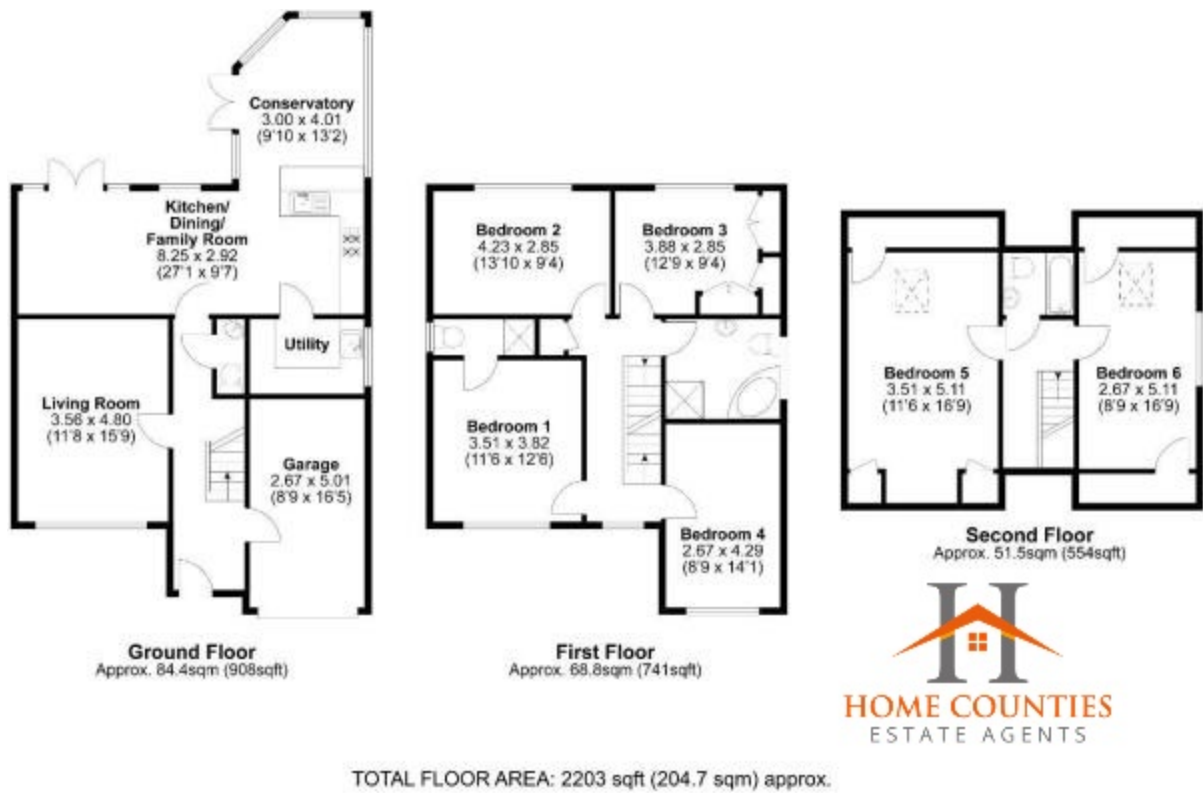

Energy Efficiency Rating		
	Current	Potential
Very energy efficient - lower running costs		
(92+) A		
(81-91) B		
(69-80) C	78	85
(55-68) D		
(39-54) E		
(21-38) F		
(1-20) G		
Not energy efficient - higher running costs		
England, Scotland & Wales		
EU Directive 2002/91/EC		

