



Two Bedroom End of Terrace House  
Woodbury Road, Walderslade Woods, Chatham, Kent, ME5 9HS

Offers Over £310,000  
Freehold



Woodbury Road, Walderslade Woods, Chatham, Kent, ME5 9HS

Offers Over £310,000

Freehold

## Description

Located in the sought after Walderslade Woods area, excellent for local walks and quick access to M2/M20 motorway links. This lovely house is beautifully presented throughout and would make a brilliant first home or investment. Occupying a corner position, the property lends itself to further extending (subject to relevant planning permission).

Accommodation comprises: entrance lobby with door into the light and airy lounge. The kitchen/dining room has a tiled floor and an array of storage cupboards and work surfaces. There is an integrated 5 ring gas hob, electric oven and microwave. An integrated dishwasher is a handy addition. Upstairs are two generously proportioned bedrooms, the main bedroom benefitting from built in wardrobes. A contemporary bathroom with triple size walk-in shower completes the internal space. The rear garden has a sunny aspect and is a private space in which to entertain. Side gate access leads to the driveway for two vehicles. Exceptional property, must be viewed.

## Key Features

- End of Terrace House
- Corner Position
- Two Bedrooms
- Potential to Extend (STRPP)
- Walderslade Woods
- Excellent Order Throughout
- Driveway for 2 Vehicles
- Ideal First Buy or Investment

## Local Area

Walderslade Woods is within reach of Tunbury local primary school along with a variety of secondary schools, shopping parades, doctors surgery, dentist and chiropodist. The area offers good transport links to the A2/M2 M20 and M25. It is close to Chatham and Maidstone town centres as well as railways links. Ebbsfleet International is approximately 15 minutes away by car.

GROUND FLOOR  
438 sq.ft. (40.7 sq.m.) approx.

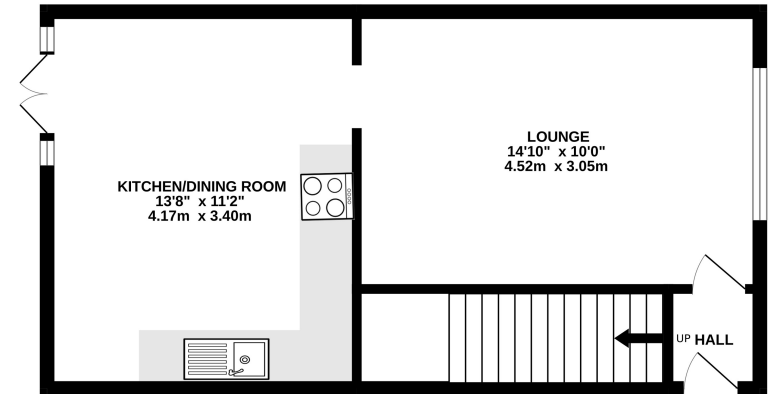

1ST FLOOR  
438 sq.ft. (40.7 sq.m.) approx.

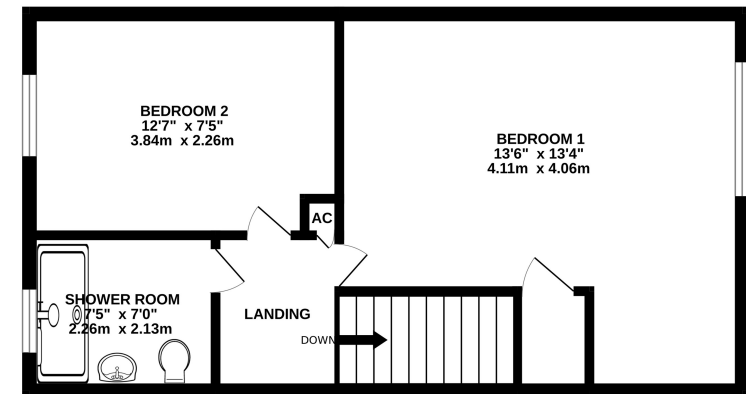

TOTAL FLOOR AREA: 876 sq.ft. (81.4 sq.m.) approx.

Whilst every attempt has been made to ensure the accuracy of the floorplan contained here, measurements of doors, windows, rooms and any other items are approximate and no responsibility is taken for any error, omission or mis-statement. This plan is for illustrative purposes only and should be used as such by any prospective purchaser. The services, systems and appliances shown have not been tested and no guarantee as to their operability or efficiency can be given.  
Made with Metropix ©2025



## Property Location

Woodbury Road, Walderslade Woods, Chatham, Kent, ME5 9HS

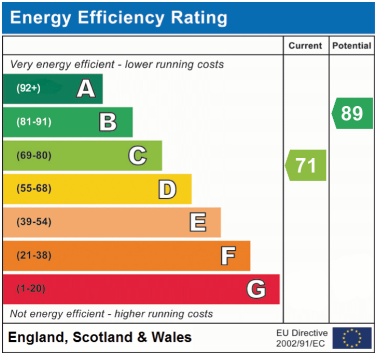
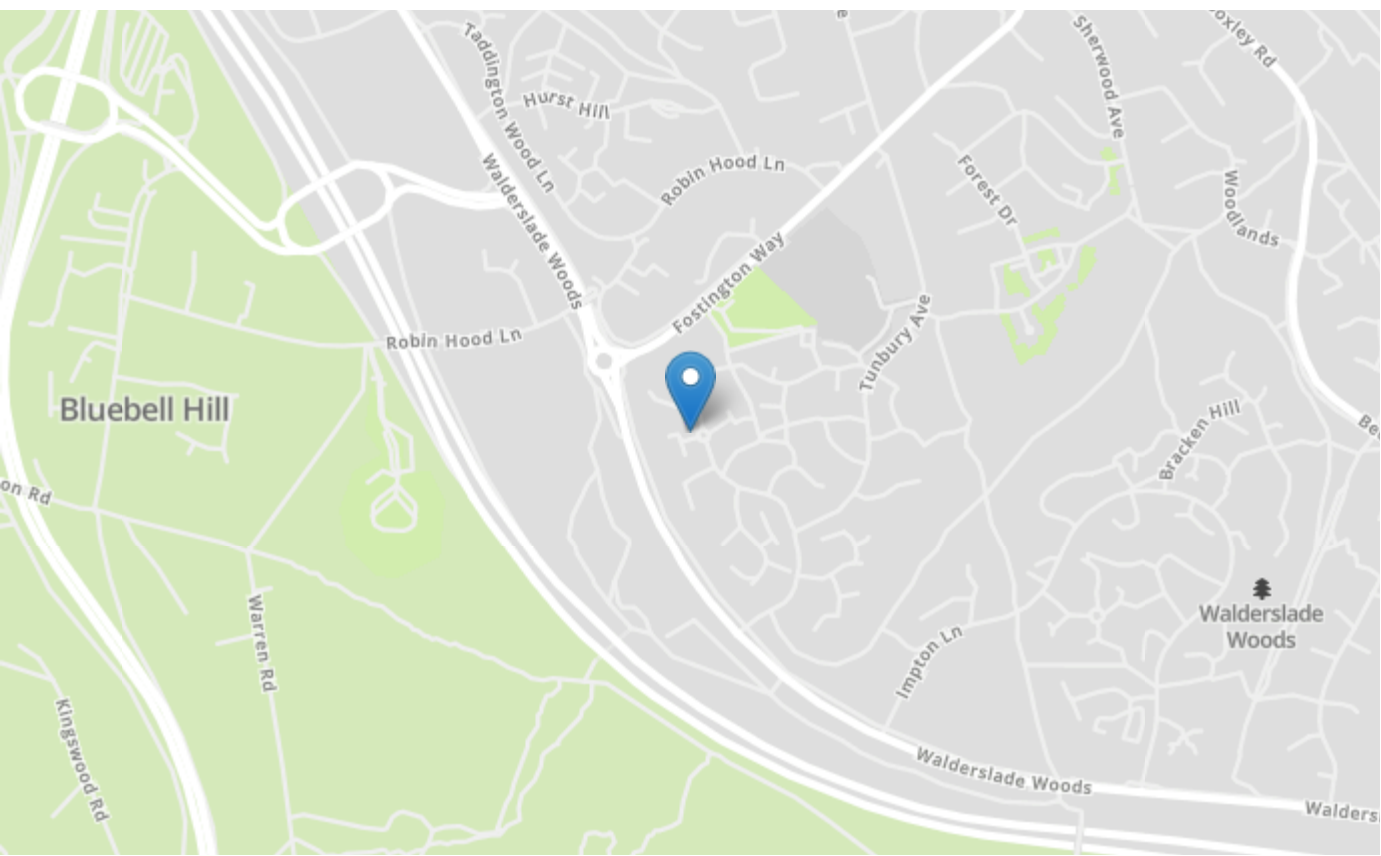

Tenure	Freehold
Lease Term	N/A
Ground Rent	N/A
Service Charge	N/A
Local Authority	Tonbridge & Malling
Council Tax	Band C

**Greyfox Walderslade**  
Unit 2, Thetford House  
Walderslade Village Centre  
Walderslade Road  
Chatham  
Kent  
ME5 9LR  
Tel: 01634 672227 Email:  
walderslade@greyfox.co.uk

**Greyfox Rainham**  
67C High Street  
Rainham  
Kent  
ME8 7HS  
Tel: 01634 377737 Email:  
rainham@greyfox.co.uk

**Agent Notes**  
These particulars are prepared as a general guide to a broad description of the property and should not be relied upon as a statement or representation of fact and do not constitute part of an offer or contract. The seller does not make or give nor do our employees or Greyfox have authority to make or give any representation or warranty to the property. We have not carried out a structural survey and the services, appliances and specific fittings have not been tested. All photographs, measurements, floorplans and distances referred to are given as a guide only and should not be relied upon for the purchase of carpets or any other fixtures or fittings. Lease details, service charges and ground rent (where applicable) and council tax are given as a guide only and should be checked and confirmed by you on inspection and your solicitor prior to exchange of contracts. If there are any points of particular importance to you we will be pleased to check the information for you and to confirm that the property remains available. This is particularly important should you be travelling some distance to view and where statements have been made by us to the effect that the information has not been verified. The copyright of all details, photographs and floorplans remain exclusive to Greyfox. For details of our privacy policy and referral fee arrangements with any of our selected partner companies please visit <https://www.greyfox.co.uk/legal/privacy> and <https://www.greyfox.co.uk/referral-fees>.