



Flat 2, 50 Amherst Road, Bexhill-on-Sea, East  
Sussex, TN40 1QW

£225,000



- 1st Floor Garden Flat
- Modern Fitted Kitchen
- Spacious Master Bedroom With Fitted Wardrobes
- Modern fitted Bathroom
- Private Area of Rear Garden
- Immaculately Presented Throughout
- Double Glazed & Gas Central Heated
- Sought After Town Centre Location
- Sold With No Onward Chain
- Viewing Highly Recommended





**1ST FLOOR**  
602 sq.ft. (56.0 sq.m.) approx.

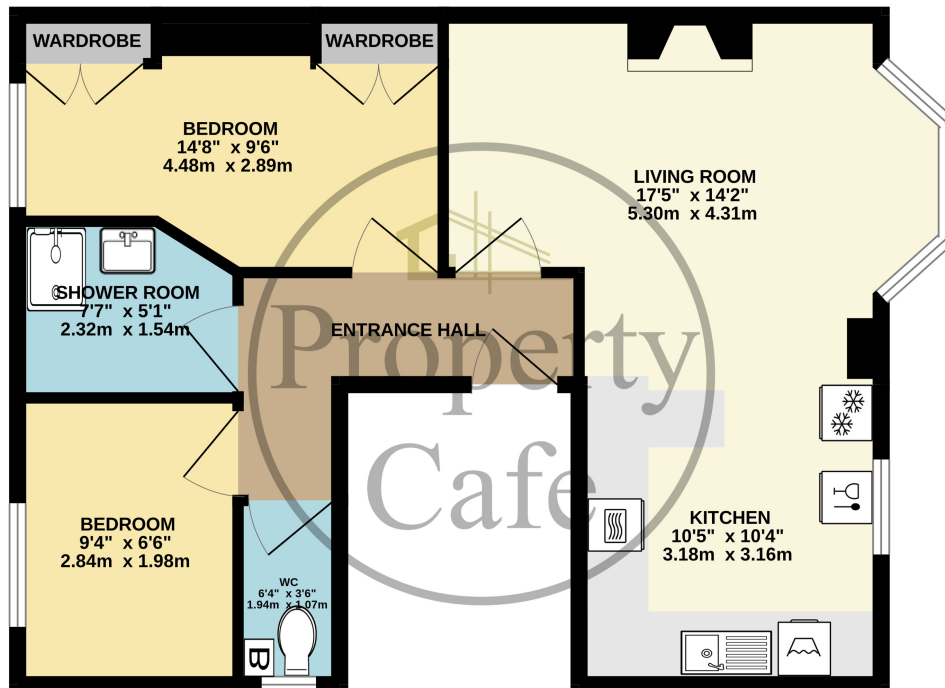

TOTAL FLOOR AREA : 602 sq.ft. (56.0 sq.m.) approx.

Whilst every attempt has been made to ensure the accuracy of the floorplan contained here, measurements of doors, windows, rooms and any other items are approximate and no responsibility is taken for any error, omission or mis-statement. This plan is for illustrative purposes only and should be used as such by any prospective purchaser. The services, systems and appliances shown have not been tested and no guarantee as to their operability or efficiency can be given.

Made with Metropix ©2024