



45 Town Moor Lane, Thurstonland,
Huddersfield. HD4 6XF.

belong 
by James White

£365,000 Freehold





If you are in the market for a four bedroom family home, in an outstanding semi-rural village, then this is where you might belong.

- Four bedroom semi detached house
- Superb semi rural village location
- Modernised by our client in recent years
- Attractive kitchen, bathroom and en-suite fittings
- Attractive internal doors, and appealing standard of decoration
- Lawned gardens, driveway and integral garage
- Gas central heating & double glazing, bathroom with underfloor heating
- Lovely local walks and scenery, village pub, church cricket club and school
- Viewing is essential to avoid disappointment
- View our 3D Virtual Reality Tour and Video on Belong's own website









Located in Thurstonland, one of the area's most sought after locations, which sits conveniently between Holmfirth and Huddersfield; this extended semi detached house offers easy to move into accommodation.

With the added benefit of easy to maintain lawned gardens and a large patio for alfresco dining, as well as having driveway providing off road parking.

The house is well appointed, having been extended and modernised by our clients in recent years, to include a stylish fitted kitchen, and attractive family bathroom and en-suite fittings as depicted in our photographs.

The accommodation briefly comprises:

Reception Hall with stylish entrance door, and stairs rising to the first floor; Spacious Lounge with decorative fireplace; Large Dining Kitchen with double doors leading out onto the rear patio, and fitted with a range of attractive cabinets and worktops with integrated cooking appliances and dishwasher.

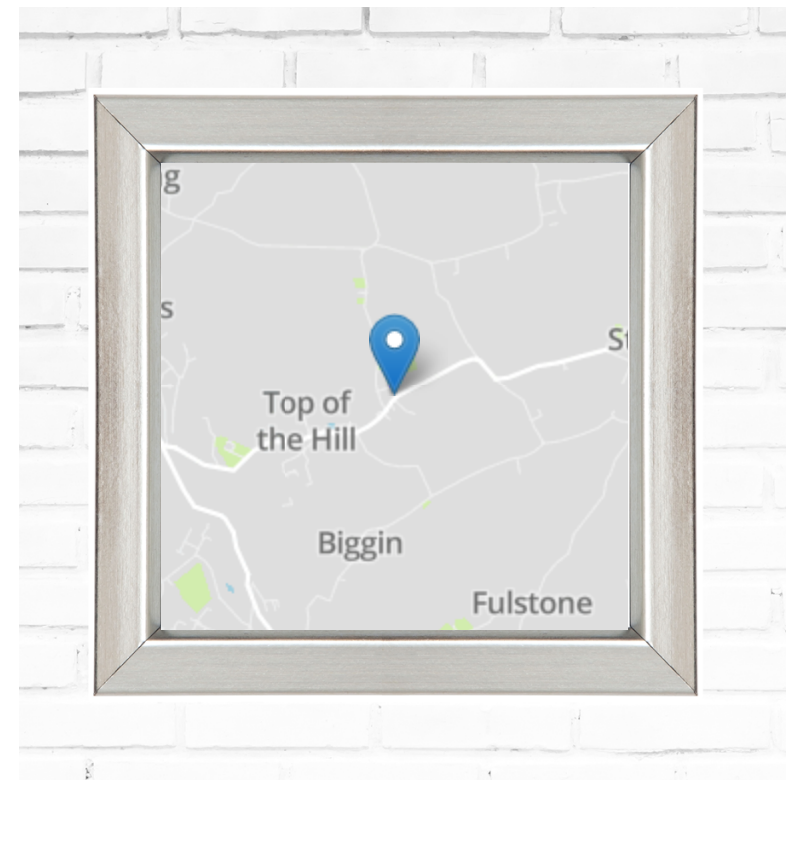
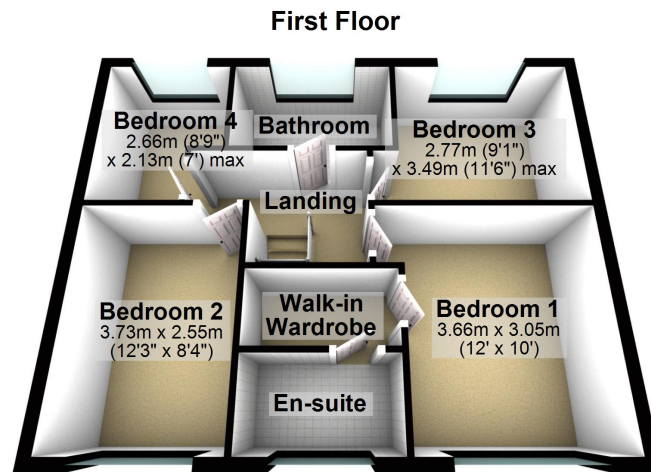
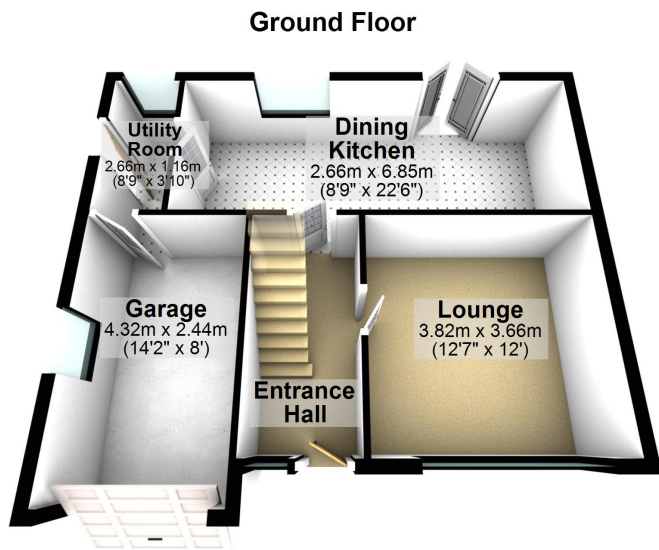

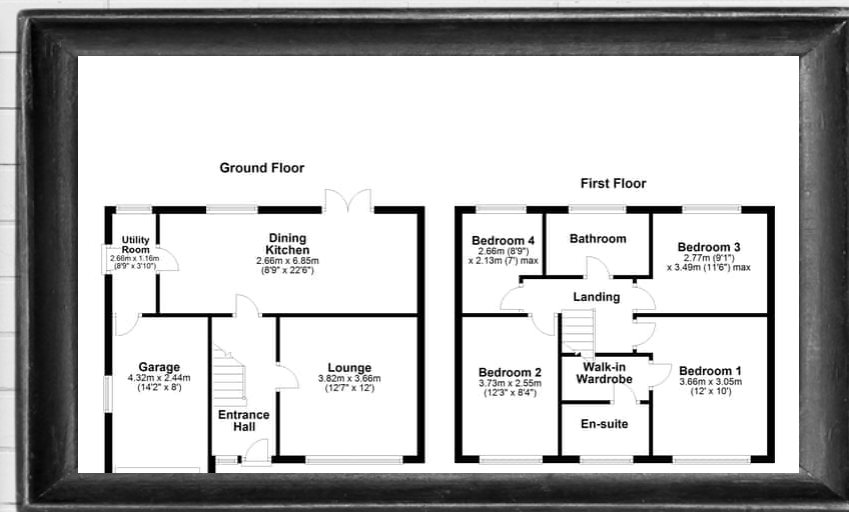

belong 
by James White

www.wherewebelong.co.uk

Belong By James White
Fairfield House, 23a Westgate
Honley, Holmfirth HD9 6AA
T 01484 444567 E info@wherewebelong.co.uk