

Approx. Gross Internal Floor Area (Including Garage) 788 sq. ft / 73.19 sq. m
 Approx. Gross Internal Floor Area (Excluding Garage) 633 sq. ft / 58.85 sq. m
 Illustration for identification purposes only, measurements approximate, not to scale.
 Copyright and Produced by MS Property Marketing.

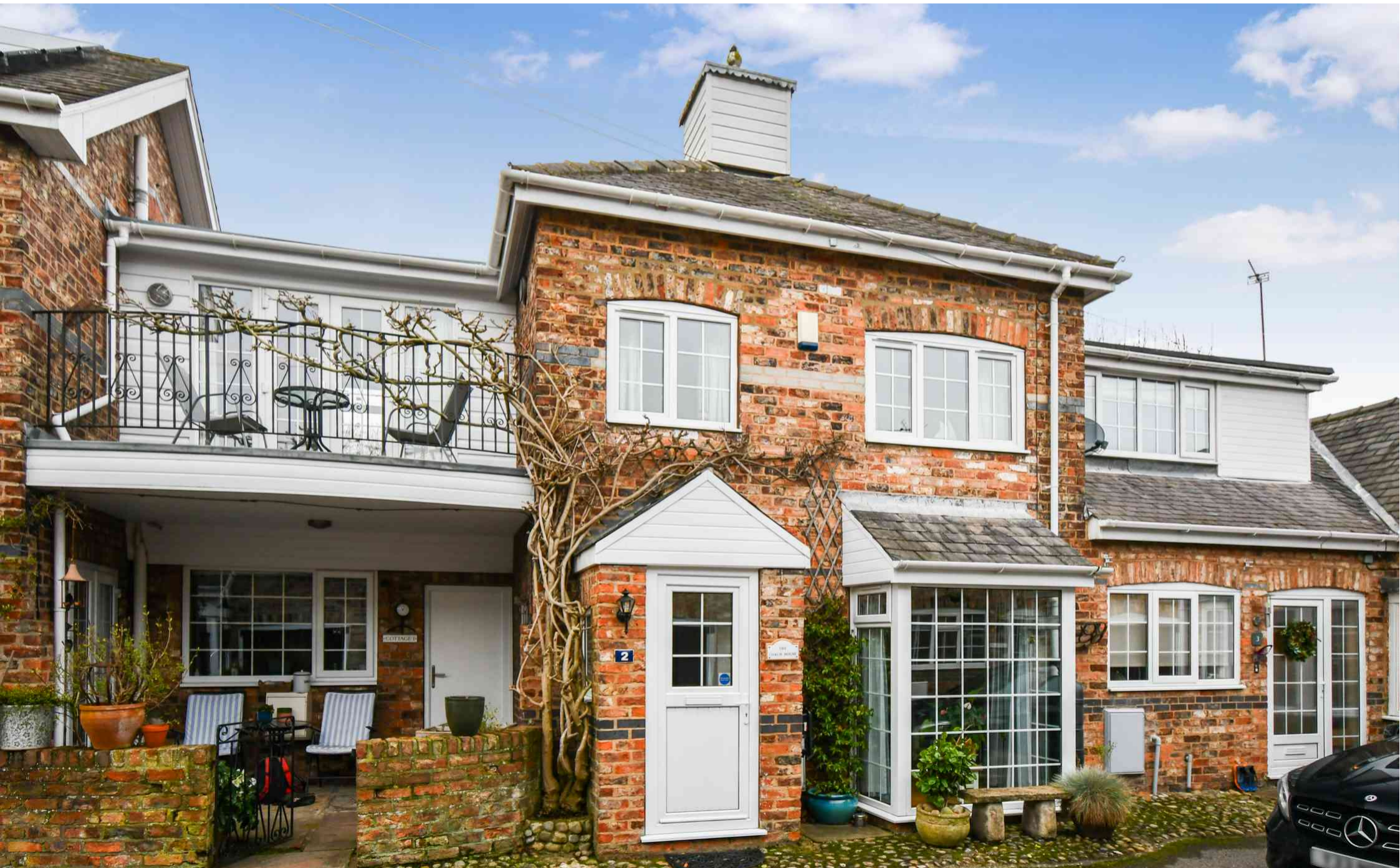
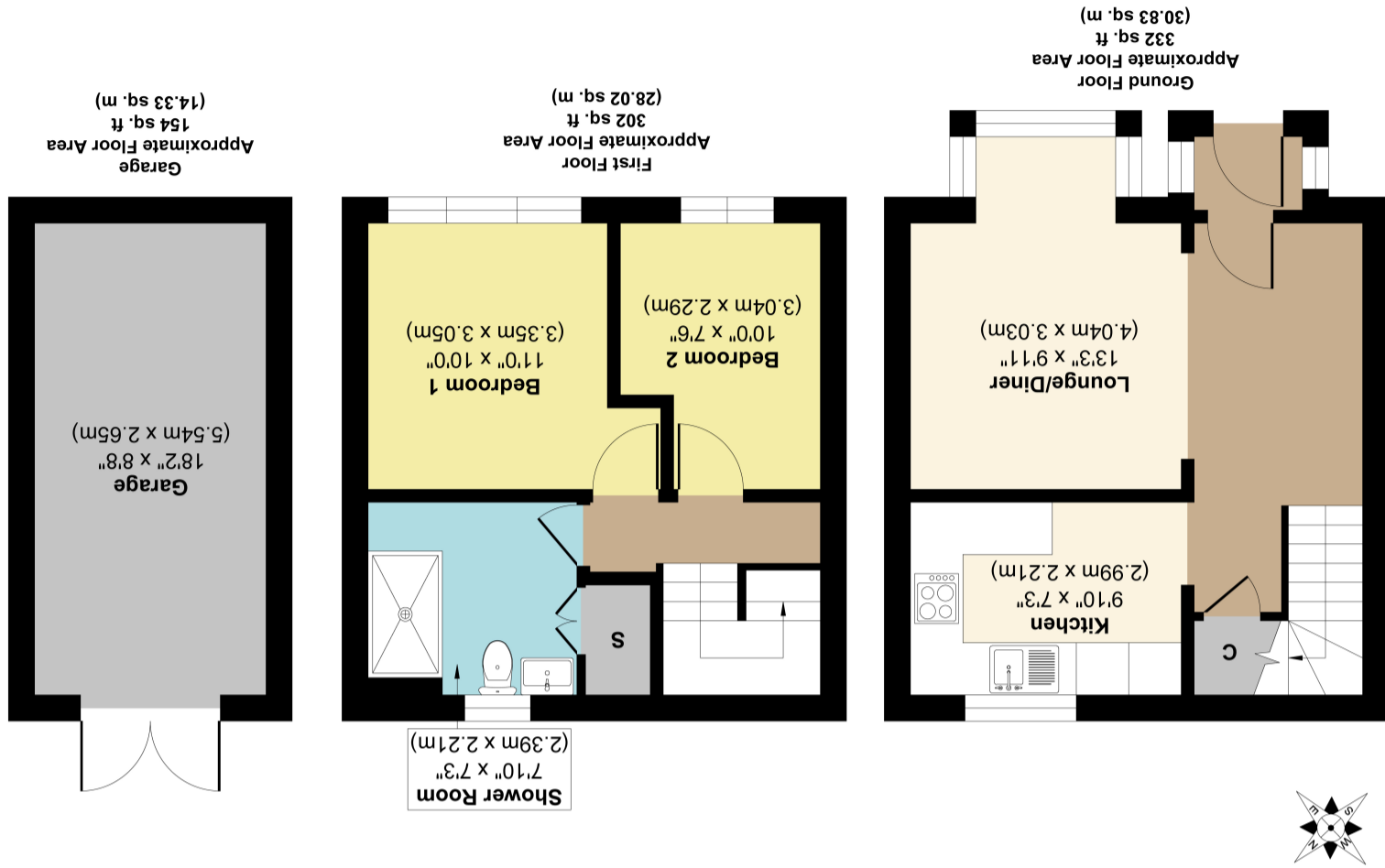

Cottage Mews, Burnholme Drive, York YO31 0LE

An extremely rare opportunity to purchase this unique cottage set within a well kept private courtyard in the popular area of Burnholme. Boasting an entrance hall, bright and spacious living / dining room and a well equipped kitchen to the ground floor. To the first floor are two good sized bedrooms and a modern shower room. Externally the property benefits from off street parking and a garage.

This property is currently used as a successful holiday let business however would also suit first time buyers or those wanting a bolthole close to the city centre.

Sympathetically converted from a stable yard by the renowned Hogg The Builder in the 1970s and you now have the opportunity to own one.

Viewing is highly recommended to appreciate the accommodation on offer here.

- Two Bedrooms
- Allocated Parking
- Unique Development
- Local Amenities Nearby
- Modern Shower Room
- Garage
- Desirable Location
- Large Living / Dining Room

Travelling from Heworth Village on Hempland Lane onto Burnholme Drive. Cottage Mews can be found on the left hand side and can be identified by our for sale sign.

An ideal location for access into York by public transport, foot, car or bike. Local shopping facilities can also be found in Heworth to include a Deli, Chemist and Florist. Plus Monks Cross, Vangarde and various supermarkets. The A64 which in turn leads to the road networks is easily accessible from the property. The outstanding Hempland Primary is the local Primary school and Archbishop Holgate is the Secondary.

