

TARGET CLOSE

£215,000



Key Features

- ✓ Set in a popular residential location.
- ✓ A mid-terraced modern house.
- ✓ Two Bedrooms.
- ✓ Two Bathrooms.
- ✓ Enclosed Garden.
- ✓ Off road parking for two vehicles.

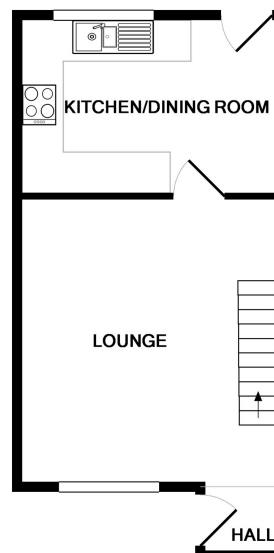

GROUND FLOOR
APPROX. FLOOR
AREA 303 SQ.FT.
(28.2 SQ.M.)

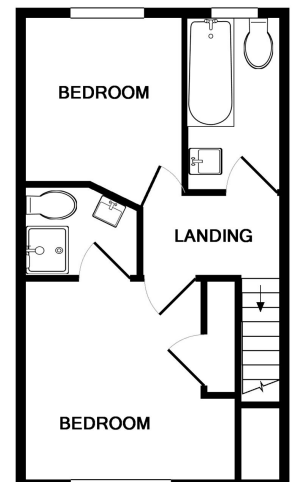

1ST FLOOR
APPROX. FLOOR
AREA 289 SQ.FT.
(26.8 SQ.M.)

TOTAL APPROX. FLOOR AREA 592 SQ.FT. (55.0 SQ.M.)

Made with Metropix ©2014