



Day & Co  
ESTATE AGENTS

28 Cavendish Street  
Keighley  
BD21 3RG



28 Goodley, Oakworth, Keighley,  
West Yorkshire, BD22 7PD

£149,995

T: 01535 664609

W: [www.dayandcoestateagents.co.uk](http://www.dayandcoestateagents.co.uk)

E: [keighley@dayandcoestateagents.co.uk](mailto:keighley@dayandcoestateagents.co.uk)

- CHARACTER STONE SEMI-DETACHED
- SPACIOUS ACCOMMODATION
- REAR ENCLOSED PATIO YARD

- TWO DOUBLE BEDROOMS
- CHARACTER FEATURES
- EPC RATING D

## SUMMARY

\*\* STONE BUILT VICTORIAN SEMI-DETACHED PROPERTY, TWO DOUBLE BEDROOMS, CHARACTER FEATURES, SPACIOUS LIVING ACCOMMODATION, SITUATED ON COLNE ROAD IN THE POPULAR VILLAGE OF OAKWORTH, ENCLOSED REAR YARD, NO CHAIN, EPC RATING D \*\*

## FULL DESCRIPTION

Well worthy of an internal viewing is this spacious, stone built Victorian semi-detached property situated on Colne Road in the popular village of Oakworth. The property has a date stone 1893 (South View) and internally has character features such a picture rails, coving and Yorkshire Stone Flagged floor. In brief the accommodation comprises of a Spacious Living Room with feature tiled fireplace with open fire, coving, picture rail, recess cupboards. Delightful Kitchen Diner with range of modern units, sink, worktops, recess cupboard, coving, Yorkshire stone flagged floor, cellar. First floor landing, Two double bedrooms and completing the accommodation is the bathroom. Gas Central Heating & Double Glazing. Outside - Frontage and rear patio yard. No Chain. Epc Rating D

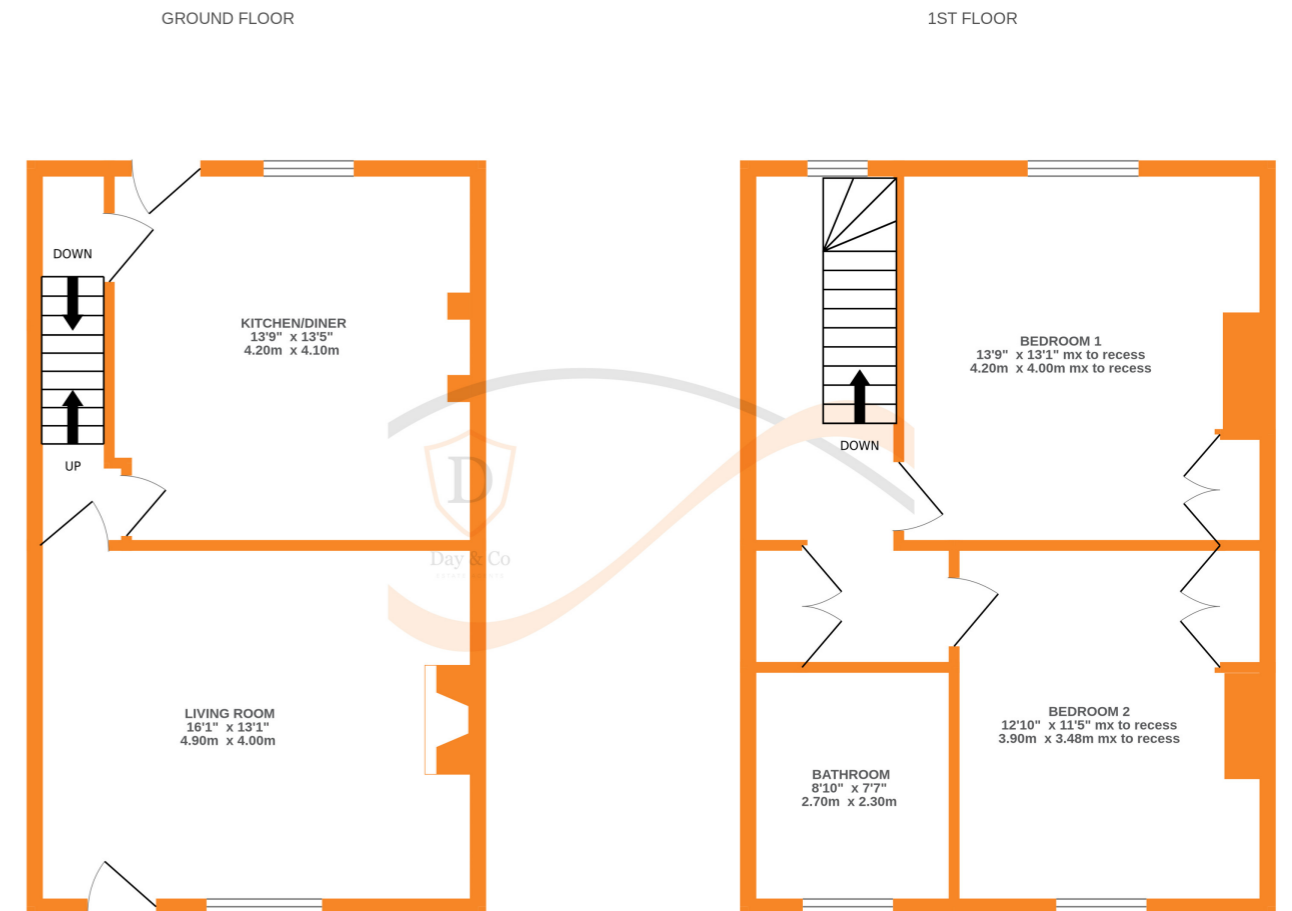

Whilst every attempt has been made to ensure the accuracy of the floorplan contained here, measurements of doors, windows, rooms and any other items are approximate and no responsibility is taken for any error, omission or mis-statement. This plan is for illustrative purposes only and should be used as such by any prospective purchaser. The services, systems and appliances shown have not been tested and no guarantee as to their operability or efficiency can be given.  
Made with Metropix 62024