



Whiteleaf, Thornhill Park, Ramsey, Isle of Man. IM8 3NB

Beautifully presented and fully modernised detached true bungalow situated in the highly sought after residential area of Thornhill Park. The property is situated within easy reach of Ramsey town centre, schools, beach and Mooragh Park.



£585,000 Freehold

PROPERTY DESCRIPTION

This impressive bungalow provides deceptively spacious accommodation throughout which has been extensively renovated by the current owner. The accommodation comprises; welcoming entrance hall, impressive dual aspect living room with large picture window providing an abundance of natural light. There is a stunning ultra modern dining kitchen with ample space for a large dining table. The sun room provides additional reception space and a perfect place for a home office. There are three good sized bedrooms with main bedroom complemented by a stylish ensuite and there is a further luxury family bathroom with separate bath and shower. There is integral access to a large double garage and large utility room. Recent upgrades include a new oil fired central heating boiler plus oil storage tank.

Externally, the gardens are set up for low maintenance but features private lawned areas which enjoy day long sunshine, an impressive outdoor kitchen and decking plus summerhouse with patio area. One of the stand out features of this lovely home is the driveway and off road parking areas, providing parking for numerous vehicles and or motorhome.

FEATURES

- Immaculate Detached True Bungalow
- Highly Regarded Residential Location
- Generous Corner Plot with Wrap Around Gardens
- Large Principal Lounge with Dual Aspect Windows
- Stunning Kitchen/Diner with Centre Island
- Sun Room plus Large Utility Room
- Master Bedroom with En Suite Shower Room
- 2 Additional Double Bedrooms plus Modern Family Bathroom
- Integral Double Garage plus Ample Off Road Parking



Property Images



FLOORPLAN



GROUND FLOOR
2035 sq.ft. (189.1 sq.m.) approx.

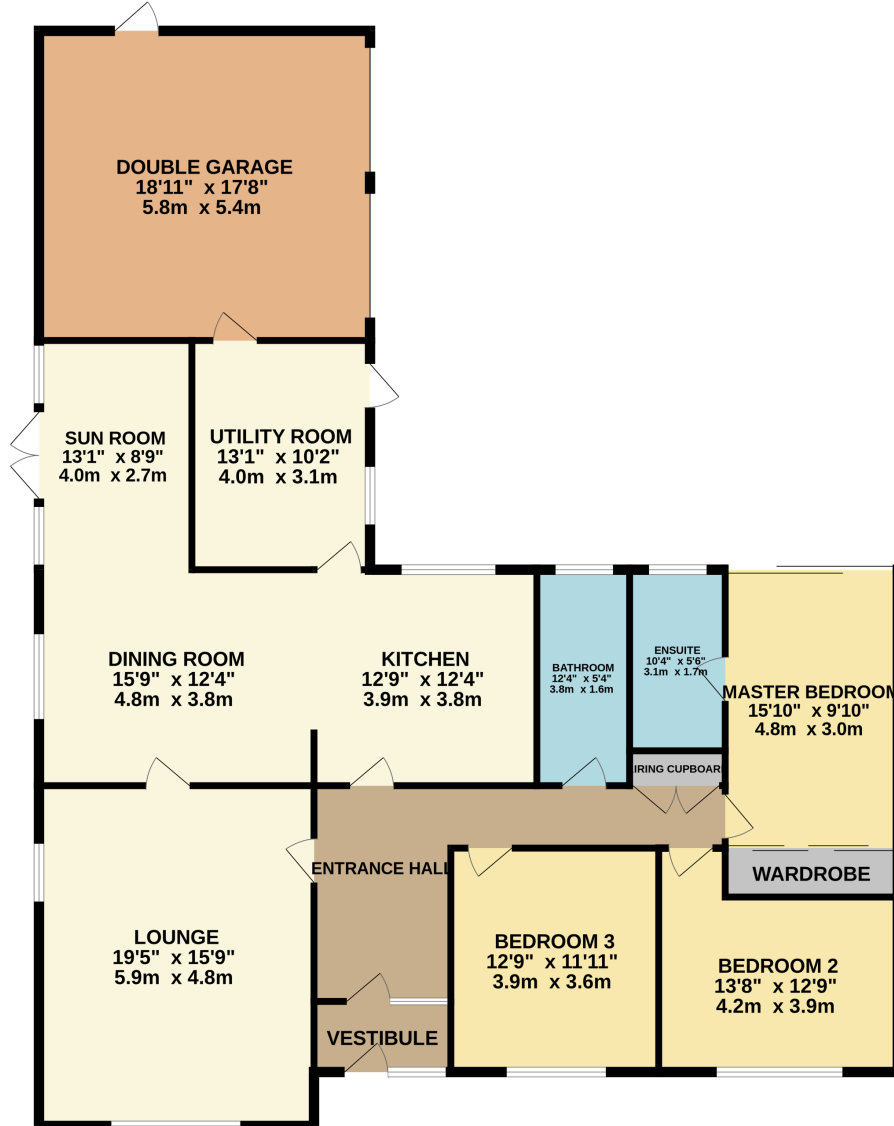

TOTAL FLOOR AREA : 2035 sq.ft. (189.1 sq.m.) approx.

Whilst every attempt has been made to ensure the accuracy of the floorplan contained here, measurements of doors, windows, rooms and any other items are approximate and no responsibility is taken for any error, omission or mis-statement. This plan is for illustrative purposes only and should be used as such by any prospective purchaser. The services, systems and appliances shown have not been tested and no guarantee as to their operability or efficiency can be given.
Made with Metropix ©2025

DISCLAIMER: Whilst Manxmove Ltd believe that these details are correct, neither Manxmove Ltd or their clients guarantee their accuracy in any way. Consequently, these details are not to be used to form part of any legally binding contract. Prospective purchasers or tenants are advised to visit this property to satisfy themselves as to the correctness of these details. Please note, we use wide angle camera lenses in order to show as much of each room as possible. This is not intended to mislead any prospective purchasers or tenants in any way and an honest verbal description is always available prior to viewing if required.

Manxmove Estate Agents - Douglas
Victoria Road, Douglas, IM2 4HD
01624 619966
info@manxmove.im