



Day & Co
ESTATE AGENTS

28 Cavendish Street

Keighley

BD21 3RG



**39 Oakmoor Avenue, Keighley,
West Yorkshire, BD21 4FL**

£79,800

T: 01535 664609

W: www.dayandcoestateagents.co.uk

E: keighley@dayandcoestateagents.co.uk

- 42% SHARED OWNERSHIP
 - PARKING, PLEASANT GARDENS
 - EPC RATING B
- THREE BED SEMI-DETACHED
 - DISTANT VIEWS TO REAR

SUMMARY

** 42% SHARED OWNERSHIP PROPERTY, MODERN THREE BEDROOM SEMI-DETACHED HOUSE, PLEASANT GARDENS, DISTANT VIEWS TO THE REAR, DRIVEWAY FOR TWO CARS, EPC RATING B **

FULL DESCRIPTION

A modern Three Bedroom semi-detached house available to purchase on a 42% shared ownership basis situated in the popular area of Long Lee. In brief the accommodation comprises of an Entrance Hallway, Downstairs W.c. with toilet and wash basin. Living room, Dining Kitchen with a modern range of fitted wall and base units, window and French Doors to the rear. First Floor - Landing, Three Bedrooms, House Bathroom comprising of a bath with screen and shower over, w.c., wash basin. Gas Central Heating & Double Glazing. Outside - Front Garden, Driveway to side with electric charge point, Pleasant enclosed rear garden with water feature and shed. EPC Rating B

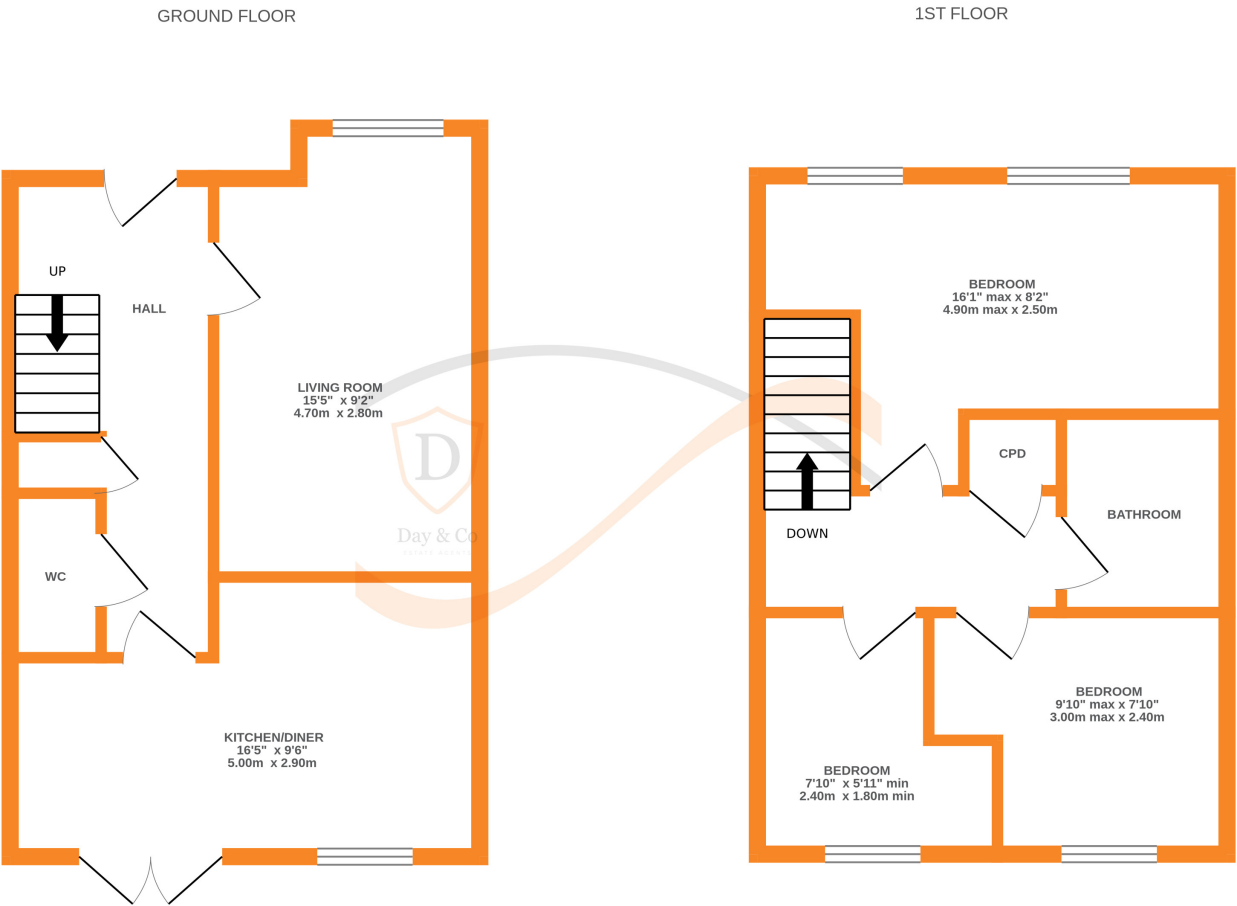

Whilst every attempt has been made to ensure the accuracy of the floorplan contained here, measurements of doors, windows, rooms and any other items are approximate and no responsibility is taken for any error, omission or mis-statement. This plan is for illustrative purposes only and should be used as such by any prospective purchaser. The services, systems and appliances shown have not been tested and no guarantee as to their operability or efficiency can be given.
Made with Metropix ©2025