

FOR
SALE



14 Taylor Crescent, Woodsetts, Worksop, Nottinghamshire S81 8SG

£230,000 -

78, Bridge Street, Worksop, S80 1JA 01909 509001 info@bartropanddilks.co.uk



PROPERTY SUMMARY

Set within the ever popular village of Woodsetts in a sought after cul de sac location is this well presented and decorated four bedroom extended semi detached home that is offered for sale with no chain being involved and has gas central heating plus uPVC double glazed windows. Early viewing is recommended with the accommodation comprising of; entrance porch, lounge with fire surround and gas fire, sitting room, dining room, well fitted kitchen with Stoves gas cooker, utility and shower room. On the first floor; landing, four bedrooms and family bathroom. Outside; attractive, well laid out and stocked front and rear gardens, driveway. The house also benefits from part air conditioning.

POINTS OF INTEREST

- *No Chain Involved*
- *Sought After Village*
- *Cul De Sac Location*
- *Four Bedroom*
- *Extended Semi Detached*
- *Gas Central Heating*
- *uPVC Double Glazed*
- *Three Reception Rooms*
- *Two Bathrooms*
- *Viewing Essential*



ROOM DESCRIPTIONS

Ground Floor

Entrance Porch

With entrance door, coat hanging space, door to the lounge.

Lounge 4.57m x 3.90m (15' 0" x 12' 10")

With fire surround and gas fire, oak flooring, central heating radiator, front facing window.

Sitting Room 3.78m x 2.37m (12' 5" x 7' 9")

With a front facing window, air con unit, central heating radiator, oak flooring.

Dining Room 5.33m x 4.51m (17' 6" x 14' 10")

Rear facing sliding patio doors, central heating radiator.

Inner Lobby

Stairs to the first floor.

Kitchen 3.20m x 2.48m (10' 6" x 8' 2")

With a good range of fitted wall and base units, Quartz worksurfaces, rear window and door, stoves gas cooker, sink unit, tiling, central heating radiator.

Utility Room

With plumbing for an automatic washing machine, side facing window.

Shower Room

With double shower cubicle and electric shower, wash hand basin, heated towel rail.

First Floor

Landing

With loft access and cylinder airing cupboard.

Bedroom One 4.55m x 2.90m (14' 11" x 9' 6")

With a front facing window, air con unit, central heating radiator.

Bedroom Two 3.87m x 2.47m (12' 8" x 8' 1")

With a front facing window, central heating radiator.

Bedroom Three 4.19m x 2.57m (13' 9" x 8' 5")

With a rear facing window, air con unit, central heating radiator, loft access.

Bedroom Four 3.87m x 2.10m (12' 8" x 6' 11")

With fitted bed area over the stairs, rear facing window, central heating radiator.

Bathroom

With a white suite that comprises of; panelled bath, wash hand basin, low flush w.c, rear facing window, central heating radiator.

Outside

Gardens

To the front and rear being well laid out and stocked, the rear also enclosed and not overlooked.

Driveway

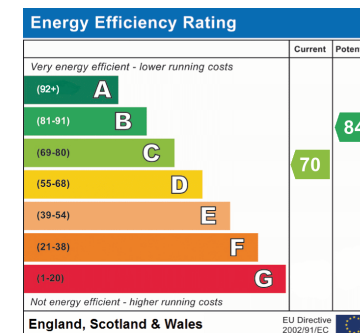

GROUND FLOOR

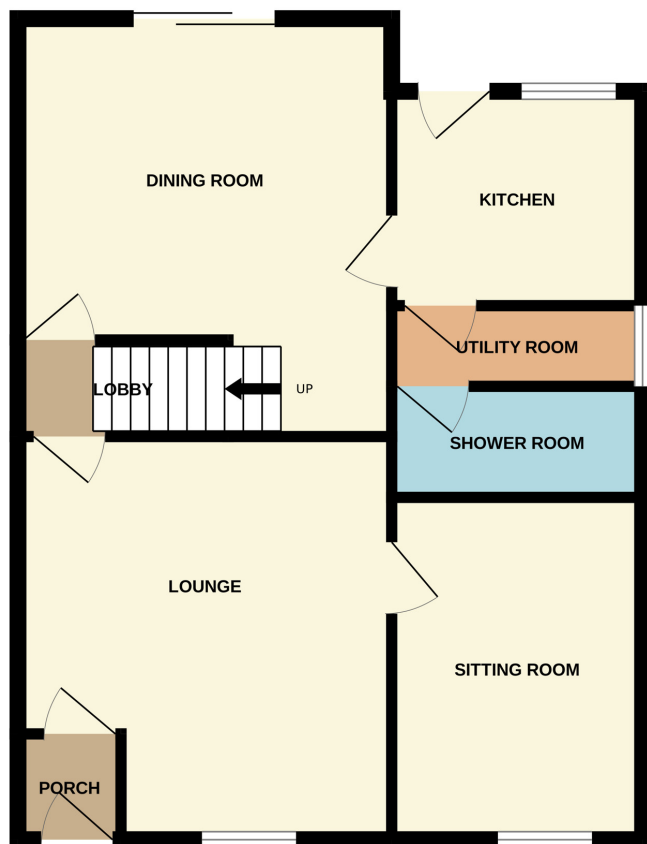

1ST FLOOR

