

# Truuli



## Vita Apartments, Caithness Walk, Croydon, Surrey, CR0 2WD

£350,000 Leasehold

- Two double bedrooms
- Large private balcony
- Seventh floor apartment
- Chain free
- Moments away from East Croydon Rail Station & Box Park
- Well maintain communal areas
- Stylish open plan living

Southbridge Place, Surrey, CR0 4HA

Tel: 0330 043 0002

Email: [save@truuli.co.uk](mailto:save@truuli.co.uk) Web: [www.truuli.co.uk](http://www.truuli.co.uk)

# Vita Apartments, Caithness Walk, Croydon, Surrey, CR0 2WD

£350,000 Leasehold

\*\*\*Vendor's comments:\*\*\* "When we had our newborn, we needed to find a suitable property and fell in love with this home as soon as we saw it. We will miss the incredible transport links that have made our daily commute so convenient, the vibrant local amenities and the friendly community are also aspects we will fondly remember."

## Vita Apartments, Caithness Walk

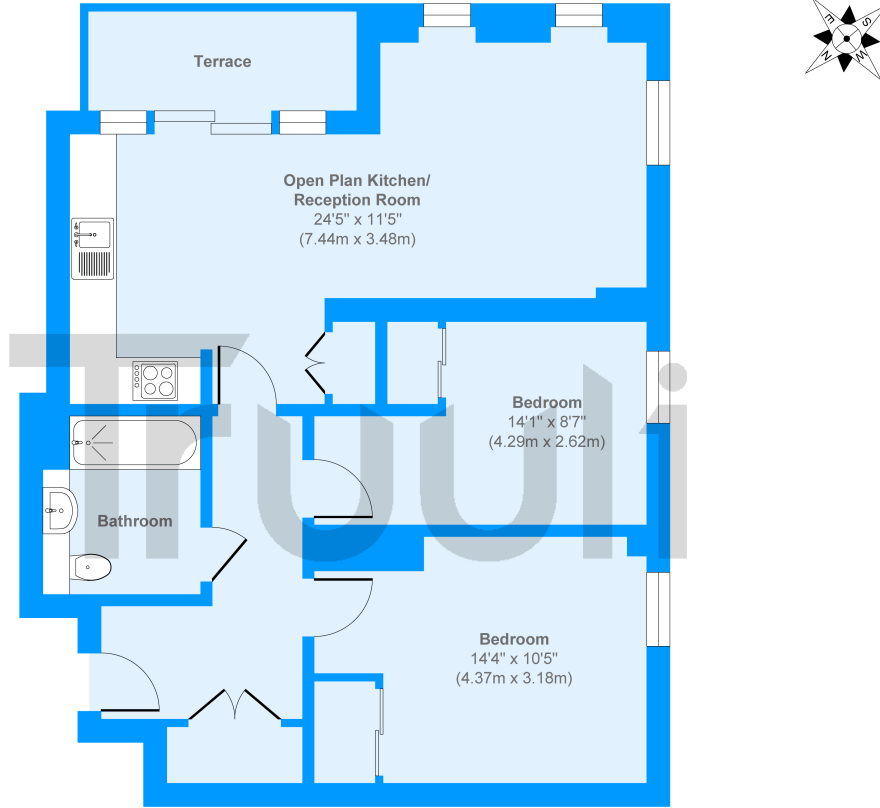

Seventh Floor

Approx. Gross Internal Floor Area 721 sq. ft / 67.00 sq. m

Produced by Elements Property

Energy Efficiency Rating		Current	Potential
Very energy efficient - lower running costs			
(92+)	<b>A</b>		
(81-91)	<b>B</b>	82	82
(69-80)	<b>C</b>		
(55-68)	<b>D</b>		
(39-54)	<b>E</b>		
(21-38)	<b>F</b>		
(1-20)	<b>G</b>		
Not energy efficient - higher running costs			
England, Scotland & Wales		EU Directive 2002/91/EC	

