



**Six Bedroom Terraced House**  
Balmoral Road, Gillingham, Kent, ME7 4QG

**Guide Price £350,000**  
Freehold

# Balmoral Road, Gillingham, Kent, ME7 4QG

Guide Price £350,000

Freehold

## Description

\*Guide Price £350,000 - £375,000\*

An extended and generously proportioned five/six-bedroom Victorian terrace, ideally positioned in the heart of Gillingham, offering versatile accommodation, period charm and a highly convenient location. This impressive home opens with a welcoming entrance hall leading through to a beautifully proportioned open-plan sitting and dining room, seamlessly connected to create an ideal space for both everyday living and entertaining. To the rear, an extended kitchen provides ample workspace and storage, complemented by a ground floor W.C. and utility area, with direct access out to the garden. The converted cellar adds further flexibility to the home and is currently arranged as a sixth bedroom, though it would also suit use as a family/games room, home office or snug. To the first floor, the property offers three well-proportioned double bedrooms, with the principal bedroom benefitting from a modern en-suite shower room. The remaining two bedrooms are served by a recently updated family bathroom, complete with a shower over the bath. The second floor provides two further double bedrooms, ideal for growing families or those requiring additional space. Externally, the property enjoys a private rear garden extending to approximately 45ft, thoughtfully arranged with decking and artificial lawn for low-maintenance enjoyment. To the front, the property benefits from on-street permit parking. Combining period character, generous living space and a central Gillingham location, this substantial Victorian home is perfectly suited to families and buyers seeking flexible accommodation with enduring appeal. Contact the Greyfox sales team in Rainham for more information!

## Key Features

- Extended Victorian Terrace House
- 5/6 Double Bedrooms
- Family Bathroom, Separate W.C & Ensuite
- Sitting & Dining Rooms
- Utilities area & Extended Kitchen
- Versatile Living Space Across All Floors
- Central Gillingham Location
- Well Presented Throughout

## Local Area

Gillingham is located within the Medway towns and offers railway links to central London and Ebbsfleet International and road connections to the A2/M2, M25 and M20. In addition to its town centre Gillingham offers a host of amenities including ice skating, country parks, an outdoor pool, a golf course, Medway Park Sports Centre and more.

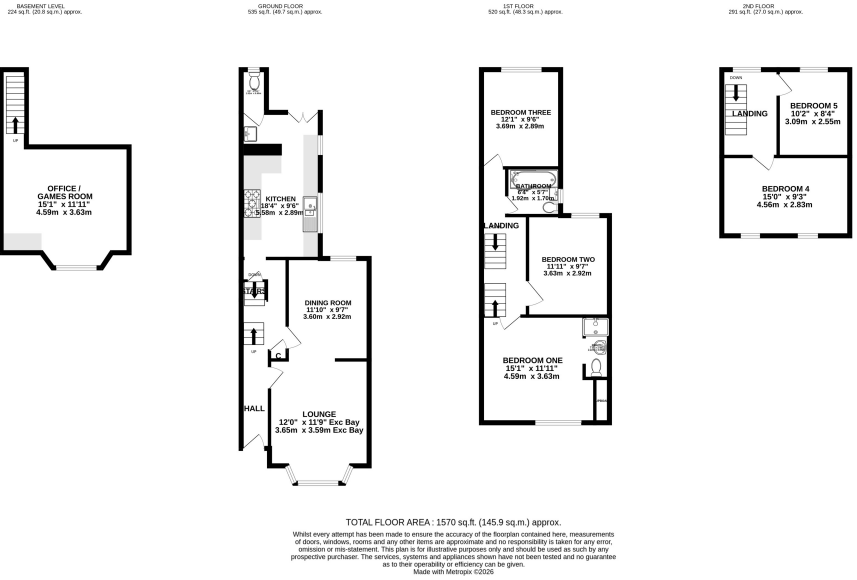







## Property Location

Balmoral Road, Gillingham, Kent, ME7 4QG

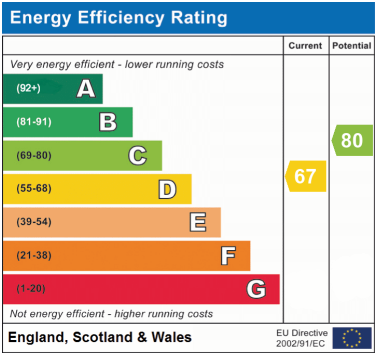
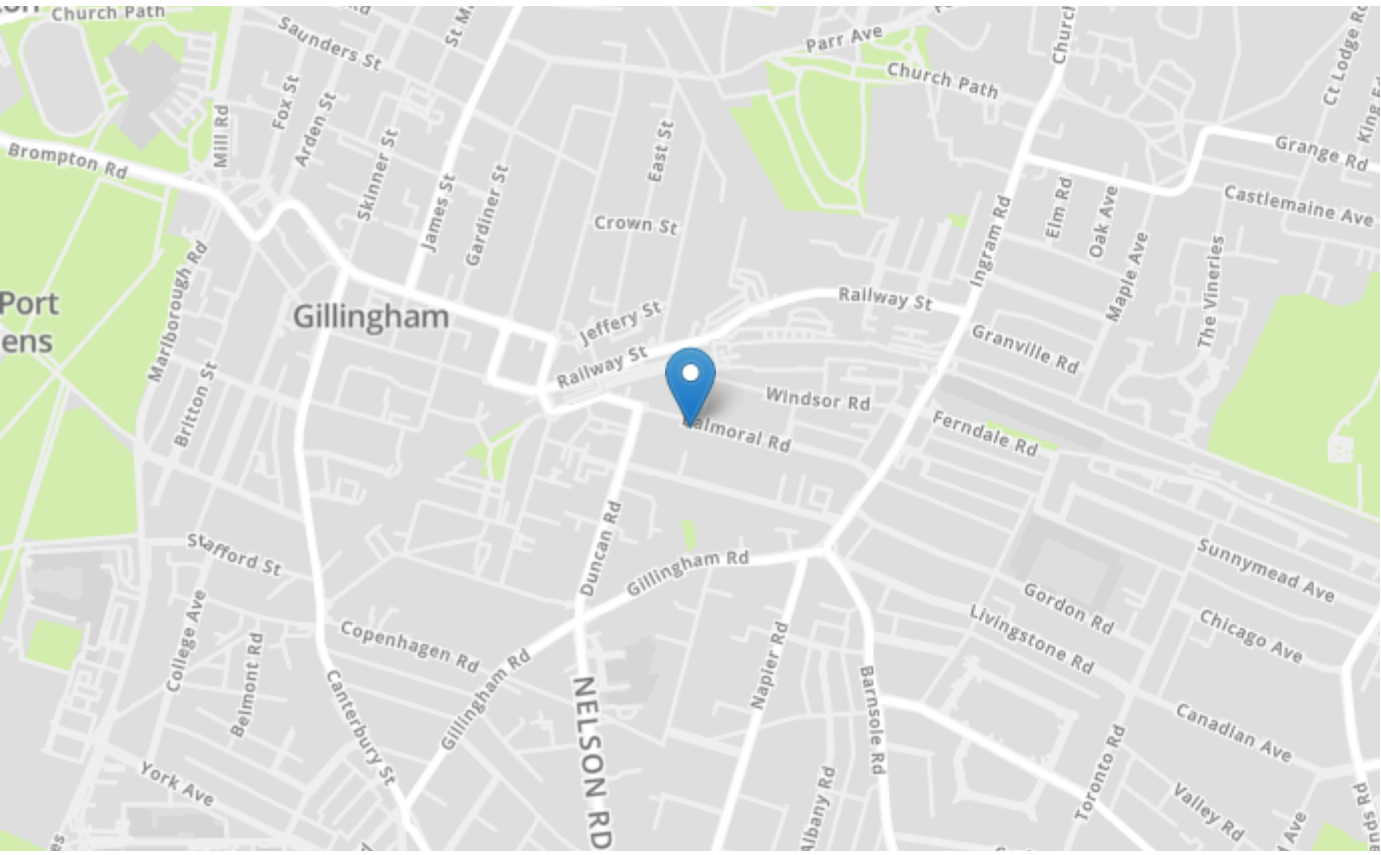

|                 |          |
|-----------------|----------|
| Tenure          | Freehold |
| Lease Term      | n/a      |
| Ground Rent     | n/a      |
| Service Charge  | n/a      |
| Local Authority | Medway   |
| Council Tax     | Band B   |

## Greyfox Walderslade

Unit 2, Thetford House  
Walderslade Village Centre  
Walderslade Road  
Chatham  
Kent  
ME5 9LR  
Tel: 01634 672227 Email:  
walderslade@greyfox.co.uk

## Greyfox Rainham

67C High Street  
Rainham  
Kent  
ME8 7HS  
Tel: 01634 377737 Email:  
rainham@greyfox.co.uk

### Agent Notes

These particulars are prepared as a general guide to a broad description of the property and should not be relied upon as a statement or representation of fact and do not constitute part of an offer or contract. The seller does not make or give nor do our employees or Greyfox have authority to make or give any representation or warranty to the property. We have not carried out a structural survey and the services, appliances and specific fittings have not been tested. All photographs, measurements, floorplans and distances referred to are given as a guide only and should not be relied upon for the purchase of carpets or any other fixtures or fittings. Lease details, service charges and ground rent (where applicable) and council tax are given as a guide only and should be checked and confirmed by you on inspection and your solicitor prior to exchange of contracts. If there are any points of particular importance to you we will be pleased to check the information for you and to confirm that the property remains available. This is particularly important should you be travelling some distance to view and where statements have been made by us to the effect that the information has not been verified. The copyright of all details, photographs and floorplans remain exclusive to Greyfox. For details of our privacy policy and referral fee arrangements with any of our selected partner companies please visit <https://www.greyfox.co.uk/legal/privacy> and <https://www.greyfox.co.uk/referral-fees>.