



# Hampshire Road

Royston,  
Hertfordshire, SG8 9FU  
£495,000

country  
properties



This immaculate home is located on the very sought after and sold out Redrow Development close to Therfield Heath in Royston. The real hub of this home is the generous kitchen/diner which spans the width of the property and enjoys French doors out to the south facing garden, perfect for entertaining.

Within walking distance of the Train Station and Royston's' local amenities and schools, this turn key home offers the best of both worlds: urban convenience and tranquil green spaces.

- › Beautifully presented family home
- › Located on the Sold Out Redrow Development
- › Large Kitchen/Diner
- › Double Aspect Lounge
- › Downstairs Cloakroom
- › Four Bedrooms
- › South Facing Rear Garden
- › Private allocated parking for two vehicles
- › EPC B85
- › Freehold













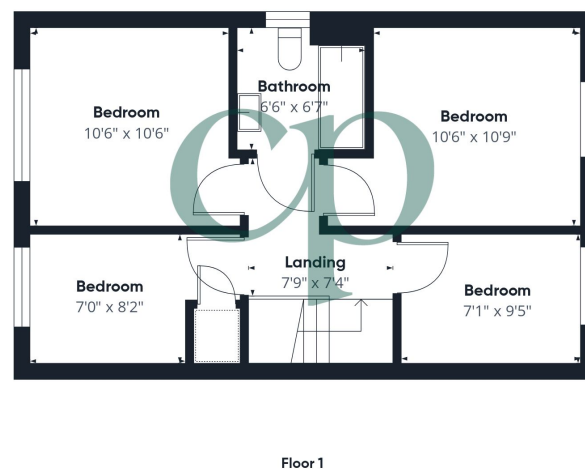
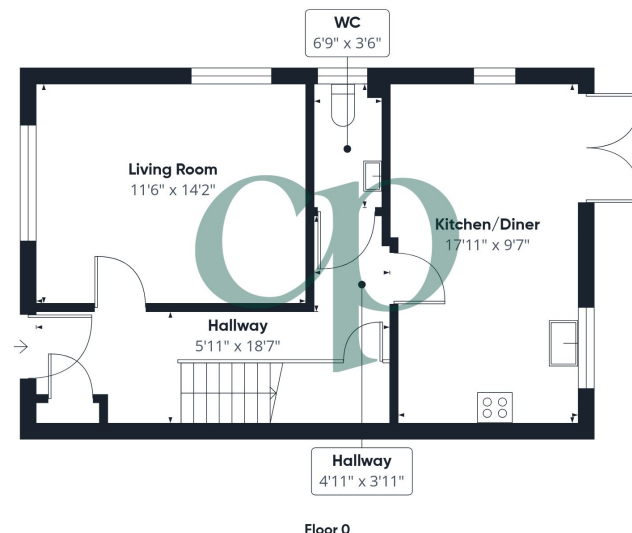

Approximate total area<sup>(1)</sup>  
955 ft<sup>2</sup>

(1) Excluding balconies and terraces

Calculations reference the RICS IPMS 3C standard. Measurements are approximate and not to scale. This floor plan is intended for illustration only.

GIRAFFE360

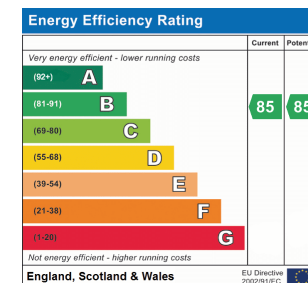

All measurements are approximate and quoted in metric with imperial equivalents and for general guidance only and whilst every attempt has been made to ensure accuracy, they must not be relied on. The fixtures, fittings and appliances referred to have not been tested and therefore no guarantee can be given and that they are in working order. Internal photographs are reproduced for general information and it must not be inferred that any item shown is included with the property. For a free valuation, contact the numbers listed on the brochure

## Viewing by appointment only

Country Properties | 45, High Street | SG8 9AW

T: 01763 245121 | E: royston@country-properties.co.uk

[www.country-properties.co.uk](http://www.country-properties.co.uk)

country  
properties



country  
properties