



Baquba Building, Conington Road, London, SE13 7FG

£1,250 PCM

Situated on the seventh floor of the sought after Silkworks development in Lewisham a modern one bedroom apartment. The property benefits from modern open plan kitchen/reception providing access to balcony with views of The City, double bedroom, bathroom and ample storage. The apartment also boasts 24 hour concierge and on-site gym. The DLR is moments from the apartment and the over ground situated a short distance, these offer excellent access to Canary Wharf, The City and Central London

Viewing by appointment with 1st avenue.

Call: 020 8293 8600

1st avenue, 128 Metcalfe Court, West Parkside, London SE10 0EL
email: info@1stavenue.co.uk

Baquba Building, Conington Road, London, SE13 7FG

£1,250 PCM

1stavenue
Real Estate Services

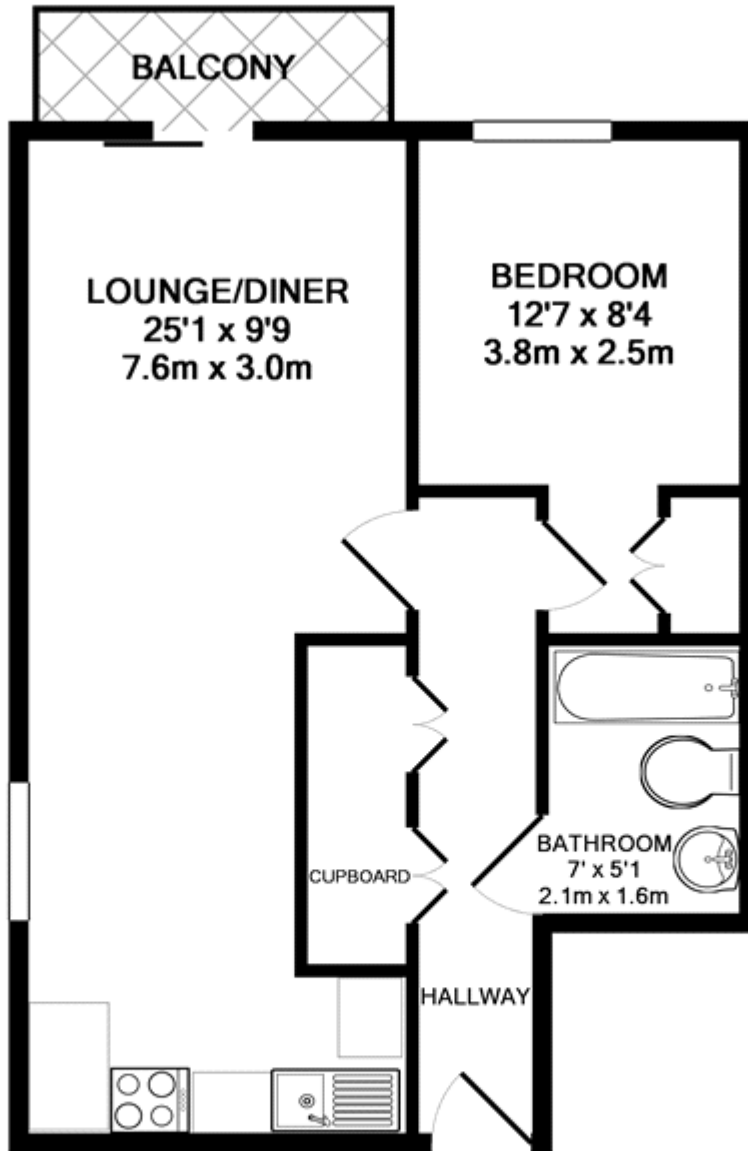

TOTAL APPROX. FLOOR AREA 425 SQ.FT. (39.5 SQ.M.)

Whilst every attempt has been made to ensure the accuracy of the floor plan contained here, measurements of doors, windows, rooms and any other items are approximate and no responsibility is taken for any error, omission, or mis-statement. This plan is for illustrative purposes only and should be used as such by any prospective purchaser. The services, systems and appliances shown have not been tested and no guarantee as to their operability or efficiency can be given

Made with Metropix ©2015

Viewing by appointment with 1st avenue.

Call: 020 8293 8600

1st avenue, 128 Metcalfe Court, West Parkside, London SE10 0EL
email: info@1stavenue.co.uk

1stavenue
Real Estate Services

