



Tenure: Leasehold

2 Bedrooms | 1 Reception Room | 1 Bathroom



Two double bedroom first floor maisonette in need of some updating, benefits, eat in kitchen, garden and garage and driveway parking. The property is within close proximity of local shops and transport links. We are advised that the property will be conveyed with an extended lease and a share of the freehold. EPC Rating: D

Enquiries To:

T: 020 8464 5555

E: brsales@georgeproctor.com

Bromley Office

10-12 Chatterton Road, Bromley, Kent, BR2 9QN

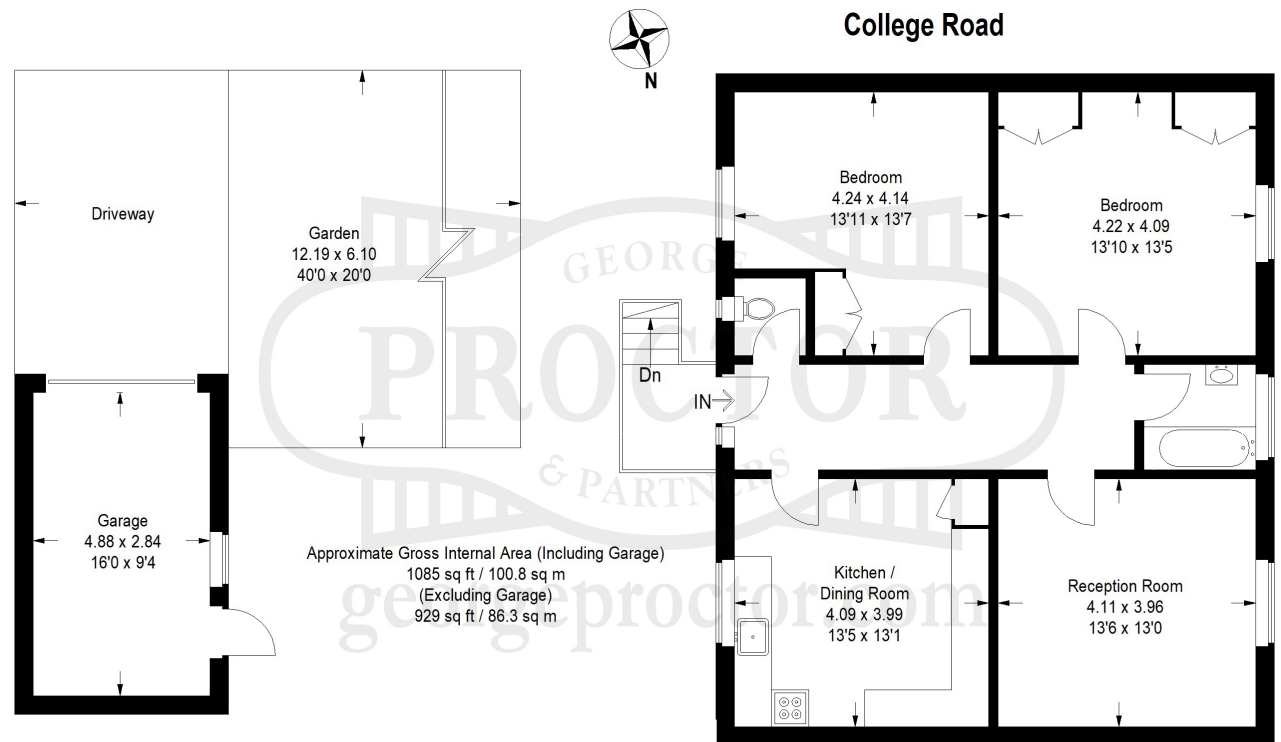

These particulars whilst believed to be accurate are made without responsibility on the part of the vendor or agents, their accuracy is not guaranteed nor do they form part of any contract and no warranty is given. Services or appliances have not been tested and no guarantee can be given as to their operation, buyers should seek professional advice where necessary. All measurements are approximate and may be rounded to the nearest three inches (10 cm). Floor plans, where shown, are indicative only. Any photographs included may be taken with the use of a wide angle lens. If there is a matter of particular interest please contact us for further information, especially before travelling any distance to view. Map reproduced by permission of Geographers A-Z Map Co Ltd. Licence No. A0514. This map is based upon Ordnance Survey maps with the permission of the controller of Her Majesty's Stationary Office.