



Day & Co  
ESTATE AGENTS

28 Cavendish Street

Keighley

BD21 3RG



17 Saxilby Road, East Morton,  
Keighley, West Yorkshire, BD20  
5WB

£395,000

T: 01535 664609

W: [www.dayandcoestateagents.co.uk](http://www.dayandcoestateagents.co.uk)

E: [keighley@dayandcoestateagents.co.uk](mailto:keighley@dayandcoestateagents.co.uk)



- MODERN DETACHED HOUSE
- WELL PRESENTED
- PARKING & INTEGRAL GARAGE

- FOUR/FIVE BEDROOMS
- PLEASANT GARDENS
- EPC RATING C

## SUMMARY

\*\* SPACIOUS MODERN FOUR/FIVE BED DETACHED HOUSE, WELL PRESENTED ACCOMMODATION IMPROVED BY ITS CURRENT OWNERS, ACCOMMODATION OVER SEVERAL FLOORS, TWO PARKING SPACES, SINGLE INTEGRAL GARAGE, PLEASANT GARDENS, POPULAR LOCATION, INTERNAL VIEWING ADVISED TO APPRECIATE, EPC RATING C \*\*

## FULL DESCRIPTION

If your looking for a well presented, four/five bedroom detached house along with a study then this could be the one for you.

This spacious detached family home has been improved by its current owners and is well worthy of an internal inspection. In brief the well proportioned accommodation - Comprises Entrance Hallway. Study. Utility Room with space for a washing machine and dryer, w.c. and sink. Gym/Bedroom 5 with internal door into the integral garage. A real feature of this property is a stunning Kitchen Diner which has a well appointed range of wall and base units, counter worktops, Island with seating for six and integrated wine rack, fitted appliances that include oven, induction hob, extractor hood, fridge/freezer and a dishwasher. The Living Room has Double Doors opening to the Rear Garden. Main Bedroom with En-Suite Shower Room, Three Further Bedrooms and completing the accommodation is the House Bathroom with modern suite comprising of a rectangular bath with shower over and screen, vanity wash hand basin and w.c.

Gas Central Heating & Double Glazing

Outside - Front garden, Two Parking Spaces one giving access to an Integral Garage. Pleasant enclosed garden to the rear mainly of lawn along with a paved patio area.

EPC Rating C

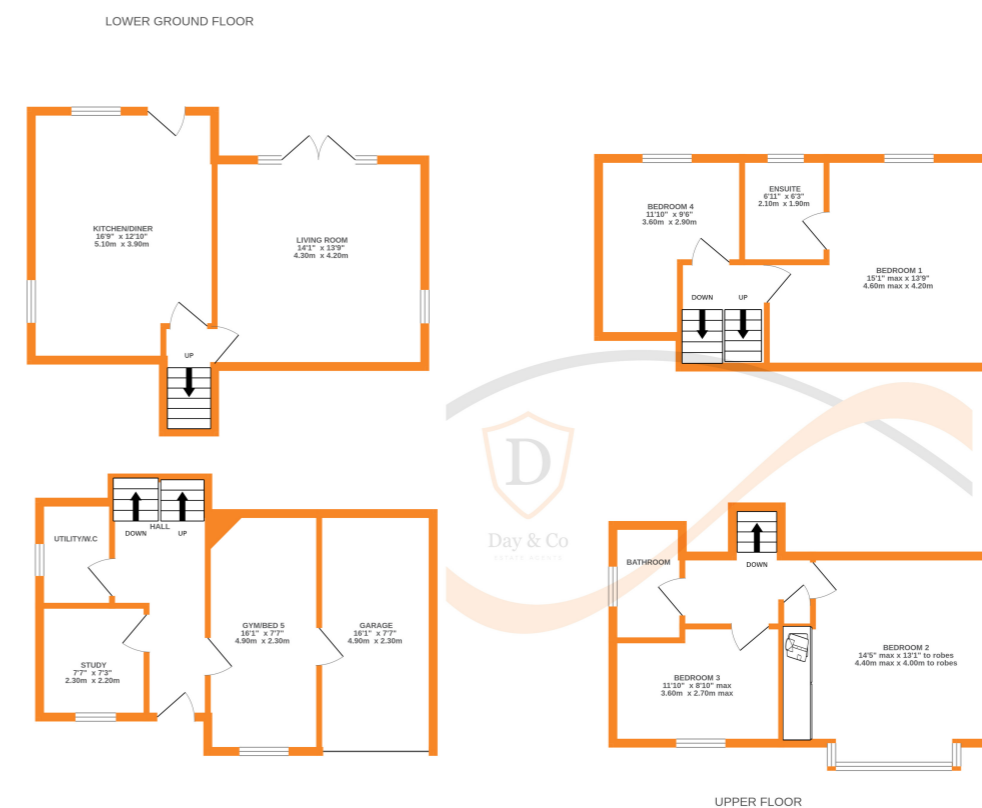

Whilst every attempt has been made to ensure the accuracy of the floorplan contained here, measurements of doors, windows, rooms and any other items are approximate and no responsibility is taken for any error, omission or mis-statement. This plan is for illustrative purposes only and should be used as such by any prospective purchaser. The services, systems and appliances shown have not been tested and no guarantee as to their operability or efficiency can be given.  
Made with Metropix ©2024