



Day & Co
ESTATE AGENTS

28 Cavendish Street
Keighley
BD21 3RG



45 Sun Street, Haworth,
Keighley, West Yorkshire, BD22
8BS

£199,995

T: 01535 664609

W: www.dayandcoestateagents.co.uk

E: keighley@dayandcoestateagents.co.uk

- SEMI-DETACHED HOUSE
 - WELL PRESENTED ACCOMMODATION
 - NO VENDOR CHAIN
- THREE BEDROOMS
 - ENCLOSED REAR GARDEN
 - EPC RATING D

SUMMARY

** SEMI-DETACHED STONE PROPERTY, THREE BEDROOMS, ACCOMMODATION OVER THREE FLOORS, SPACIOUS LOUNGE, REAR GARDEN, GAS CENTRAL HEATING, DOUBLE GLAZING, POPULAR VILLAGE OF HAWORTH, NO VENDOR CHAIN, EPC RATING D **

FULL DESCRIPTION

A well presented 3-bedroom double-fronted stone semi-detached property situated only a short stroll to the cobbles of Main Street, Haworth. This property may appeal to a variety of buyers, is offered for sale with no vendor chain and an internal viewing is highly recommended. In brief the accommodation which is arranged over three floors briefly comprises -

Ground Floor - Entrance Vestibule, Spacious Lounge with windows to both the front and rear along with a glazed door opening to the rear patio deck, Compact galley Kitchen with breakfast bar, range of modern wall and base units,

First Floor - Landing, Two Bedrooms, Small Shower Room, Separate W.c.

Second Floor - Double attic bedroom with two gable windows and roof window.

Gas Central Heating & Double Glazing.

Outside - Enclosed, rear garden with raised composite decking.

No Vendor Chain, EPC Rating D

GROUND FLOOR

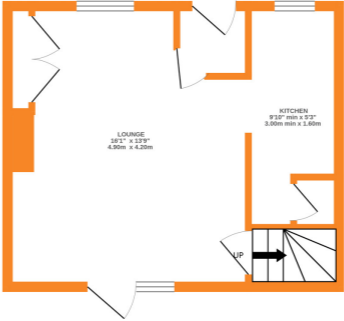

1ST FLOOR

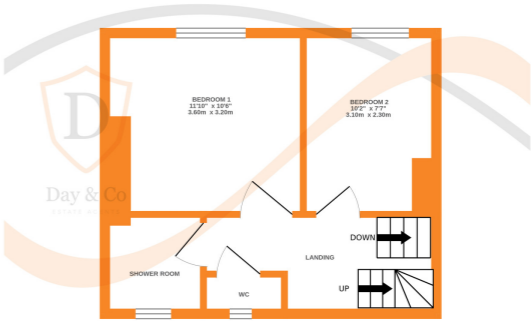

2ND FLOOR

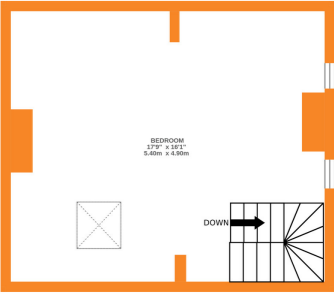

Whilst every attempt has been made to ensure the accuracy of the floorplan contained here, measurements of doors, windows, rooms and any other items are approximate and no responsibility is taken for any error, omission or mis-statement. This plan is for illustrative purposes only and should be used as such by any prospective purchaser. The services, systems and appliances shown have not been tested and no guarantee as to their operability or efficiency can be given.
Made with Metropix ©2025