



Retail Property (High Street)

High Street, Sittingbourne, Kent, ME10 4PL

£27,000

EPC Rating: E

High Street, Sittingbourne, Kent, ME10 4PL

£27,000

Description

Large shop in prominent location on the High Street – To Let or For Sale

This larger than average ground floor shop is situated in a busy location in the town centre, close to the entrance of the Forum Shopping Centre with major retailers including Boots, Santander, HSBC, Wilkinsons and many others.

With a good sized frontage and currently laid out as a large retail area, there are offices, open plan storage space, cold stores and staff room all to the rear, giving this unit the flexibility to create a fantastic retail opportunity. It could suit many other uses, subject to planning. There is also access from the rear via the service road and this includes the benefit of a car port and garage for 3 vehicles allowing customers to collect from the rear or alternatively there is free street parking to the front for 20 minutes.

Total Approximately 2,305 sq.ft. (214.1sq. M approx)

This is a great opportunity to either rent the ground floor shop on a new lease at at rental of £27,000 Per annum exclusive alternatively the shop is available for sale or indeed the whole building including the flats which are tenanted / income producing.

Please contact Paula Horton at Greyfox for further information on prices etc.

Legal Costs: Each party to be responsible for their own legal costs.

Business Rates: RV £28,500 (this is not the rates payable). Please contact Swale Council for further detail

Key Features

- Primary Town Centre Location
- Larger than average Shop
- Rear Access
- Good shop frontage
- Other Uses (subject to planning)
- To rent or For sale

GROUND FLOOR
2305 sq.ft. (214.1 sq.m.) approx.

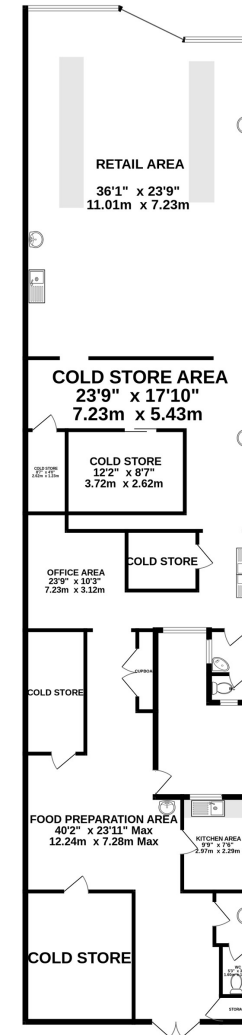

FOR ILLUSTRATION ONLY

TOTAL FLOOR AREA : 2305 sq.ft. (214.1 sq.m.) approx.

Whilst every attempt has been made to ensure the accuracy of the floorplan contained here, measurements of doors, windows, rooms and any other items are approximate and no responsibility is taken for any error, omission or mis-statement. This plan is for illustrative purposes only and should be used as such by any prospective purchaser. The services, systems and appliances shown have not been tested and no guarantee as to their operability or efficiency can be given.

Made with Metropix ©2023



Property Location

High Street, Sittingbourne, Kent, ME10 4PL

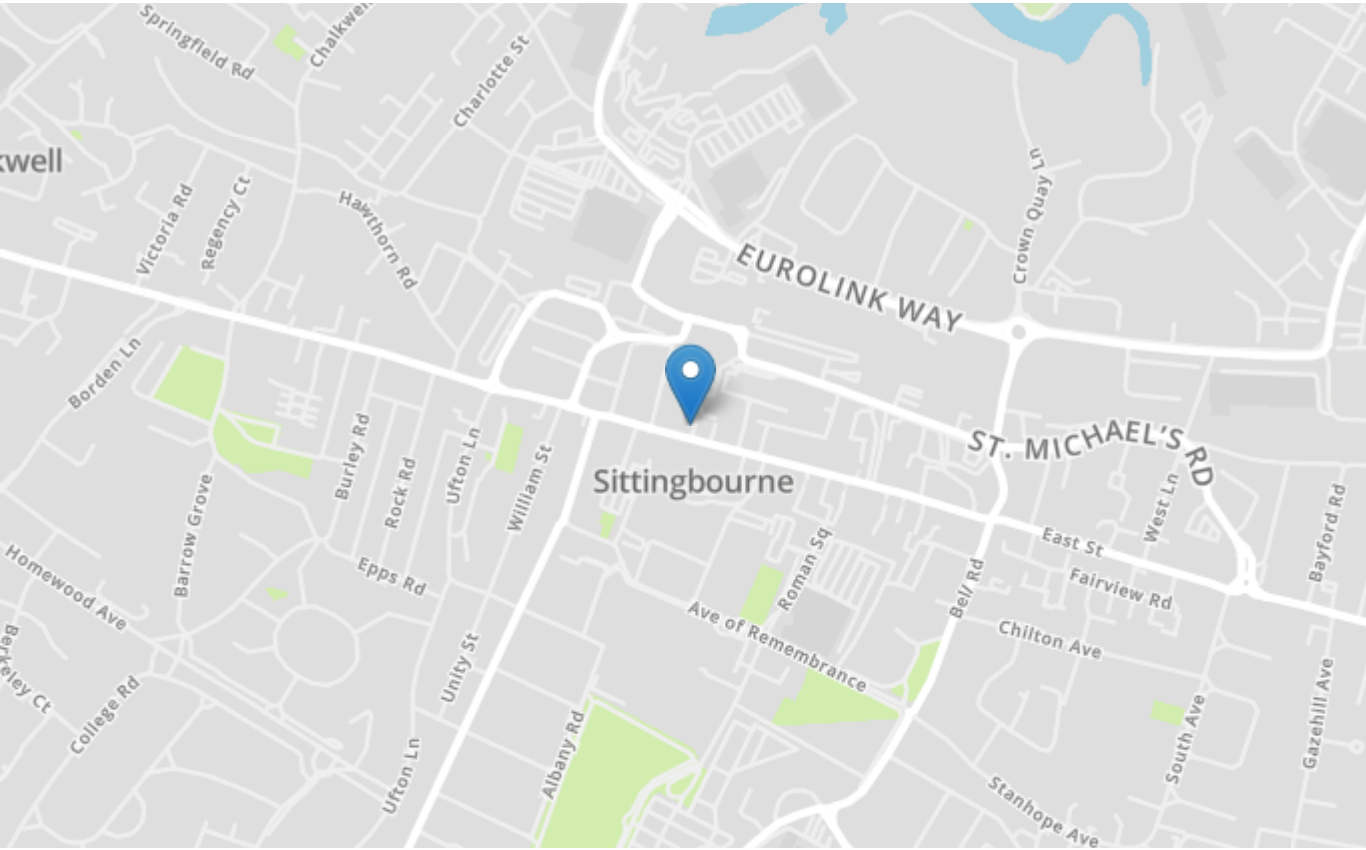

Tenure

Leasehold

Lease Term

Ground Rent

Service Charge

Local Authority

Council Tax

Greyfox Walderslade

Unit 2, Thetford House
Walderslade Village Centre
Walderslade Road
Chatham
Kent
ME5 9LR
Tel: 01634 672227 Email:
walderslade@greyfox.co.uk

Greyfox Rainham

67C High Street
Rainham
Kent
ME8 7HS
Tel: 01634 377737 Email:
rainham@greyfox.co.uk

Agent Notes

These particulars are prepared as a general guide to a broad description of the property and should not be relied upon as a statement or representation of fact and do not constitute part of an offer or contract. The seller does not make or give nor do our employees or Greyfox have authority to make or give any representation or warranty to the property. We have not carried out a structural survey and the services, appliances and specific fittings have not been tested. All photographs, measurements, floorplans and distances referred to are given as a guide only and should not be relied upon for the purchase of carpets or any other fixtures or fittings. Lease details, service charges and ground rent (where applicable) and council tax are given as a guide only and should be checked and confirmed by you on inspection and your solicitor prior to exchange of contracts. If there are any points of particular importance to you we will be pleased to check the information for you and to confirm that the property remains available. This is particularly important should you be travelling some distance to view and where statements have been made by us to the effect that the information has not been verified. The copyright of all details, photographs and floorplans remain exclusive to Greyfox. For details of our privacy policy and referral fee arrangements with any of our selected partner companies please visit <https://www.greyfox.co.uk/legal/privacy> and <https://www.greyfox.co.uk/referral-fees>.