

£175,000
Leasehold





Features

- SECOND FLOOR APARTMENT
- NO CHAIN
- PARKING
- READY TO MOVE INTO

Summary of Property

Mason's Residential are delighted to offer this immaculate one bedroom apartment.

The property is situated in Central Milton Keynes with shops, amenities and a variety of restaurants close by, with the Grand Union Canal within walking distance. This apartment is situated close to Central Milton Keynes Train station with easy access to the M1.

The property offers a good size double bedroom with a balcony off the sitting room offering extra outside space.

An allocated parking space for one car is offered behind gated secure access.

Ground rent is payable of £250.00 per month and service charges are £220.98 per month which includes chargeable water rates.

The Lease assigned has 150 years commencing from 2013.

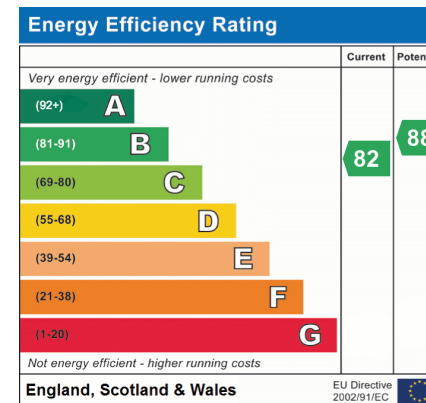

Room Descriptions

SECOND FLOOR APARTMENT

SITTING ROOM

7' 7" x 21' 0" (2.31m x 6.40m)

KITCHEN

7' 5" x 7' 7" (2.26m x 2.31m)

BEDROOM ONE

9' 0" x 15' 0" (2.74m x 4.57m)

BATHROOM

5' 4" x 8' 4" (1.63m x 2.54m)

PARKING FOR ONE CAR BEHIND GATED ACCESS

PLEASE NOTE

These property particulars do not constitute part or all of an offer or contract. All measurements are stated for guidance purposes only and may be incorrect. Details of any contents mentioned are supplied for guidance only and must also be considered as potentially incorrect. Mason's Residential advise perspective buyers to check all measurements prior to committing to any expense. Mason's Residential confirm we have not checked any appliances, equipment, apparatus, fixtures or fittings at the property and any prospective buyer should conduct their own checks before exchange of contracts. Mason's Residential has not sought to verify the legal title of the property and any prospective buyers must obtain verification and confirmation from their solicitor.



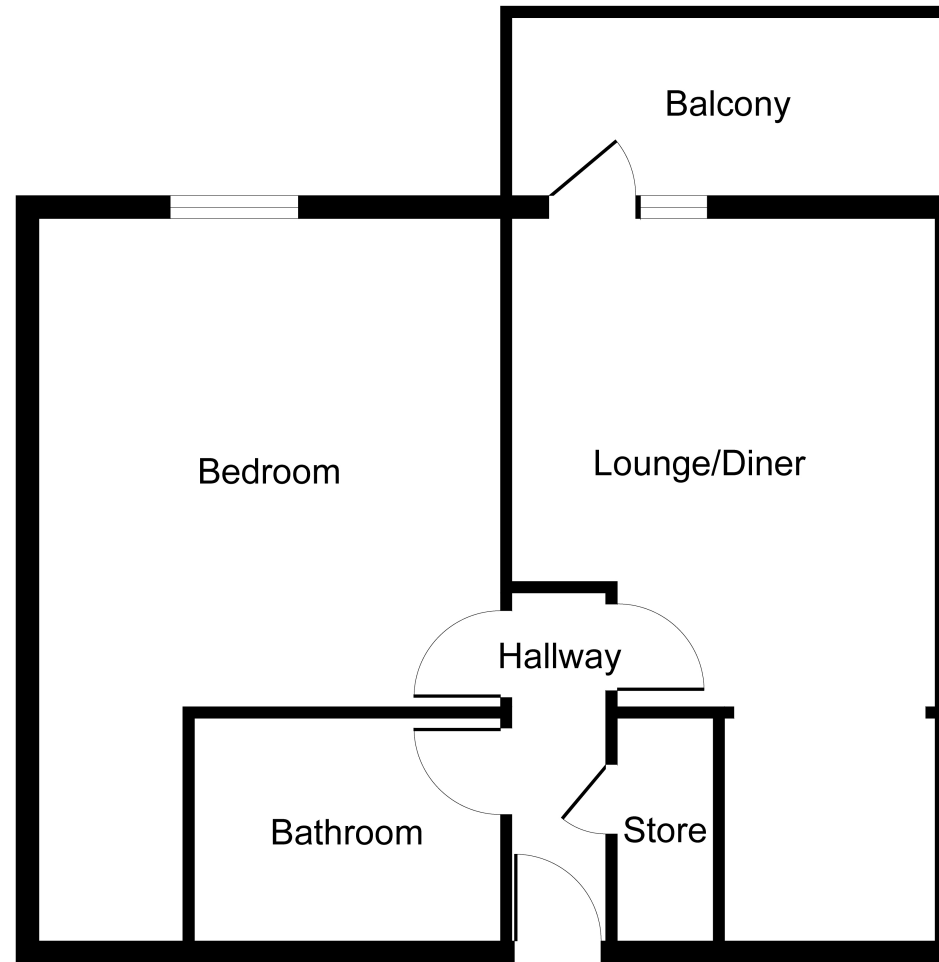

Second Floor Apartment

Whilst every attempt has been made to ensure the accuracy of the floor plan contained here, measurements of doors, windows, rooms and any other items are approximate and no responsibility is taken for any error, omission, or mis-statement. The measurements should not be relied upon for valuation, transaction and/or funding purposes. This plan is for illustrative purposes only and should be used as such by any prospective purchaser or tenant.

The services, systems and appliances shown have not been tested and no guarantee as to their operability or efficiency can be given.

Copyright V360 Ltd 2024 | www.houseviz.com