



Day & Co
ESTATE AGENTS

28 Cavendish Street
Keighley
BD21 3RG



69 Redcliffe Street, Keighley,
West Yorkshire, BD21 2PX

£115,000

T: 01535 664609

W: www.dayandcoestateagents.co.uk

E: keighley@dayandcoestateagents.co.uk

- THROUGH TERRACE
- GAS CENTRAL HEATING & DOUBLE GLAZING
- NO CHAIN

- THREE BEDROOMS
- REAR YARD
- EPC RATING C

SUMMARY

** A THREE BEDROOM STONE THROUGH TERRACE, ACCOMMODATION OVER THREE FLOORS, CELLARS, GAS CENTRAL HEATING, DOUBLE GLAZING, REAR YARD, NO CHAIN, EPC RATING C **

FULL DESCRIPTION

Offered for sale is this three bedroom stone through terrace situated in this popular residential location with excellent access to Keighley town centre. The three storey accommodation comprises of a lounge with front entrance door and window, Kitchen which has a range of wall and base units, worktops sink, window and door to the rear. Cellars. First Floor - Landing with window to the rear, doors to the first floor rooms and staircase to the upper floor. Two Bedrooms, Bathroom with three piece suite. Upper Floor - Bedroom Three with double glazed roof window. Gas Central Heating & Double Glazing. Outside rear yard with storage sheds. No Chain. EPC Rating C.

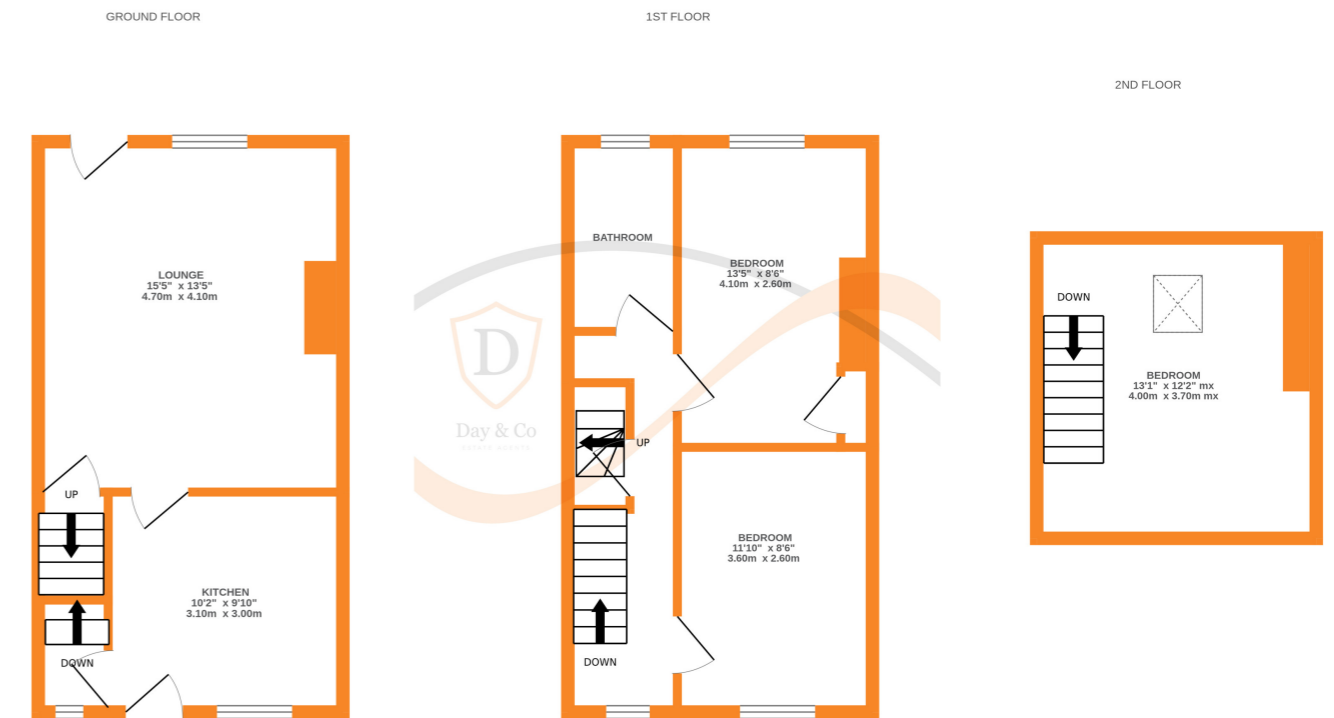

Whilst every attempt has been made to ensure the accuracy of the floorplan contained here, measurements of doors, windows, rooms and any other items are approximate and no responsibility is taken for any error, omission or mis-statement. This plan is for illustrative purposes only and should be used as such by any prospective purchaser. The services, systems and appliances shown have not been tested and no guarantee as to their operability or efficiency can be given.
Made with Metropix ©2024