



3/4 Leamington Road, Edinburgh, EH3 9PD

Well-Presented & Bright, One-Bedroom, First-Floor Flat

Up to date price and viewing info at mov8realestate.com/property

espc rightmove  **Zoopla**
find your happy

Property Description

Well-presented and bright, one bedroom, first-floor flat, forming part of a traditional stone built tenement. Set on a quiet side street, conveniently located adjacent to the Union Canal, in the popular Bruntsfield area, just west of Edinburgh's city centre.

Comprises an entrance hall, living room, kitchen, double bedroom, and a shower room.

Features include a fitted kitchen with appliances, period cornice work, wood panelled doors, contemporary flooring, double glazing, gas central heating, tall ceilings, TV and telephone points.

Ideally placed for the business district, it also offers a secure entry system, a shared garden, and zoned on-street parking to the front and surrounding streets.

The entrance hall provides access throughout and includes a secure entry handset. A spacious front-facing living room boasts period cornice work, wood-effect flooring, and an open-shelved press, with ample space for lounge and dining furniture. The well-equipped, internally set kitchen features stone-effect worktops, a stainless steel sink with drainer, a tiled surround, a fridge, a washing machine, and an electric cooker.

A generous rear-facing double bedroom benefits from carpeted flooring, a built-in wardrobe, and a store cupboard. Completing the home, the stylish shower room is set internally off the hall, fitted with a modern two-piece suite, an integrated cubicle, and tiled splash walls.

mov⁸ REAL ESTATE Flat 4, 3 Leamington Road, Edinburgh EH3 9PD
Estate Agents and Solicitors Approximate Gross Internal Area: (538 sq ft - 50 sq m.)

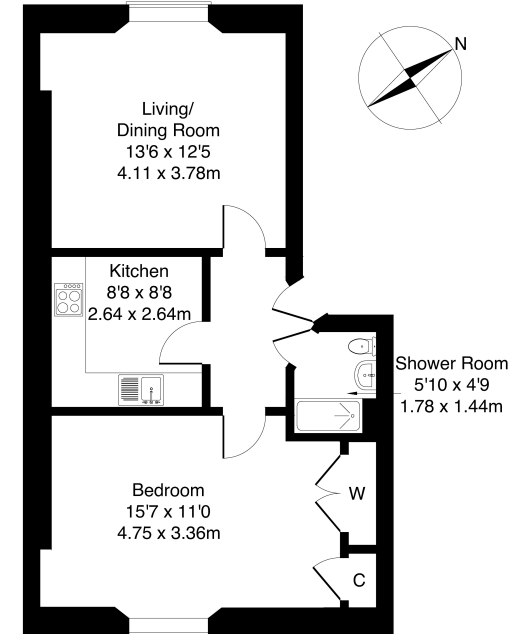

Legal Disclaimer : Floor-plan and measurements are for illustrative guidance only, and not intended to form part of any contract.

Area Description

Located in the sought-after Bruntsfield area, this property offers an excellent city lifestyle, just west of Edinburgh's centre. The nearby Union Canal provides scenic walks, while the area is well-served by independent shops, cafes, bars, and restaurants. Bruntsfield Links and The Meadows offer green spaces for recreation. Excellent

transport links, including bus routes and cycle paths, provide easy access to the city centre and business district. With a vibrant community atmosphere and convenient amenities, Bruntsfield is a prime location for professionals and students alike.





Our Services

- Free pre-sale property valuations
- Great value fixed estate agency fees
- Extensive buyer matching database
- Purchase and sale conveyancing

Contact Us

0345 646 0208

sales@mov8realestate.com

www.mov8.com

Head Office

6 Redheughs Rigg, Edinburgh, EH12 9DQ

Glasgow Office

77 Renfrew Street, Glasgow, G2 3BZ



Estate Agents and Solicitors



These particulars do not form part of any contract and the statements or plans contained herein are not warranted nor are they to scale. All descriptions, dimensions, areas, reference to condition and necessary permissions for use and occupation and other details are given in good faith, and are believed to be correct, but any prospective purchaser should not rely on them as statements or representations of fact, and any prospective purchaser must satisfy themselves by inspection or otherwise as to the correctness of each of them. The Seller shall not be bound to accept the highest or any offer nor to accept a full offer of the Fixed Price where this is applicable. Approximate measurements have been taken by sonic device and measurements are most often taken to the widest point of any room or space. Services and appliances have not been tested for efficiency or safety and no warranty is given as to their compliance with any Regulations. Offers should be made using the Combined Standard Clauses.