



Day & Co  
ESTATE AGENTS

28 Cavendish Street  
Keighley  
BD21 3RG



3 Mayfield Drive, Sandbeds,  
Keighley, West Yorkshire, BD20  
5LS

£250,000

T: 01535 664609

W: [www.dayandcoestateagents.co.uk](http://www.dayandcoestateagents.co.uk)

E: [keighley@dayandcoestateagents.co.uk](mailto:keighley@dayandcoestateagents.co.uk)

- EXTENDED SEMI-DETACHED HOUSE
- POPULAR CUL-DE-SAC
- CUL-DE-SAC

- THREE BEDROOMS, TWO RECEPTION ROOMS
- GARDENS, GARAGE
- EPC Rating E

## SUMMARY

\*\* EXTENDED SEMI-DETACHED HOUSE, THREE BEDROOMS, TWO RECEPTION ROOMS, POPLUAR CUL-DE-SAC, FRONT GARDEN, VEGETABLE GARDEN TO REAR, DRIVEWAY, GARAGE, VIEWING ADVISED, EPC RATING E \*\*

## FULL DESCRIPTION

An attractive, three bedroom extended mature semi detached house situated in a popular cul de sac in Sandbeds. This property benefits from a dining room extension and has been in the same family for over 40 years. This super house does require some elements of upgrading but an internal inspection will justify its appeal and potential. Briefly comprises of an entrance porch, hallway, spacious lounge with views over the front garden, double doors through to a dining room extension. Dining kitchen has a range of fitted units, worktops, sink, understairs cupboard, sink, side entrance door. The first floor provides three bedrooms and completing the accommodation is a bathroom comprising of a bath, w.c., wash basin.

Double glazing and wood fired central/hot water heating.

Outside: pleasant front garden with sitting area, driveway leading to a detached garage. Vegetable garden to the rear with shed.

This desirable cul-de sac lies mid way between Keighley and Bingley, with commuting links either by bus or the train link which can be found in the neighbouring village of Crossflatts.

EPC Rating E

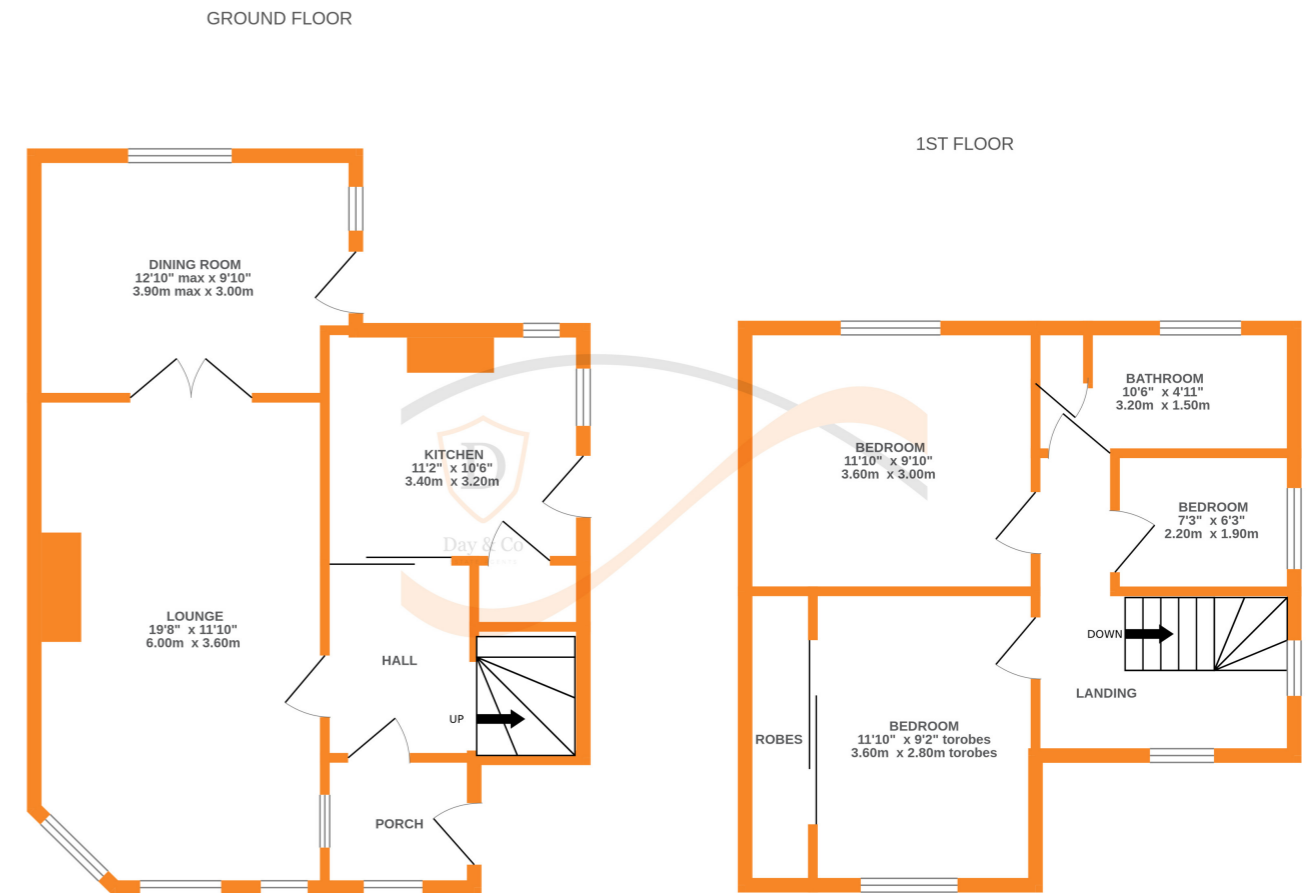

Whilst every attempt has been made to ensure the accuracy of the floorplan contained here, measurements of doors, windows, rooms and any other items are approximate and no responsibility is taken for any error, omission or mis-statement. This plan is for illustrative purposes only and should be used as such by any prospective purchaser. The services, systems and appliances shown have not been tested and no guarantee as to their operability or efficiency can be given.  
Made with Metropix ©2023