



Thorpe Road
Melton Mowbray
Leicestershire
LE13

Offers in Excess of £180,000

bettermove 

Thorpe Road

Melton Mowbray

Bettermove are proud to present this 3 bedroom terrace house in Melton Mowbray, available with no forward chain.

This property benefits from double glazing and gas central heating throughout, with on street parking available, no permit is required.

The council tax band is B.

The interior of this well presented property comprises a spacious living room, dining room, fitted kitchen and bathroom on the ground floor. The first floor consists of three bedrooms and the second bathroom. The exterior boasts a separate outbuilding and a private rear garden, with both lawn and patio areas, perfect for enjoying the summer months.

Located in the popular town of Melton Mowbray, the property is close to a range of amenities, including shops, supermarkets, restaurants and pubs. Excellent transport links can be found from Melton Mowbray Railway Station, a variety of local bus routes, and close access to the A606 and A607.

This exciting opportunity should not be missed! All enquiries can be made through Bettermove on 0330 004 0050.



GROUND FLOOR
579 sq.ft. (53.8 sq.m.) approx.

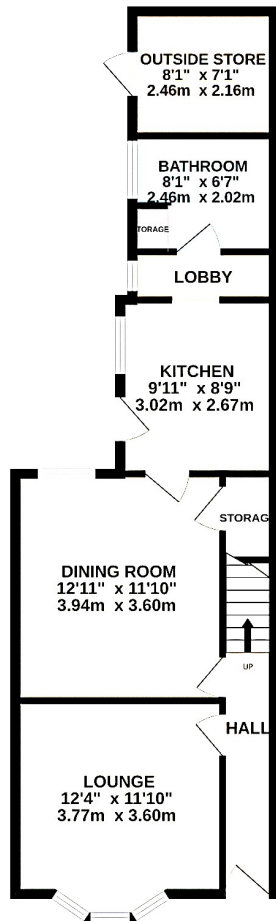

1ST FLOOR
479 sq.ft. (44.5 sq.m.) approx.

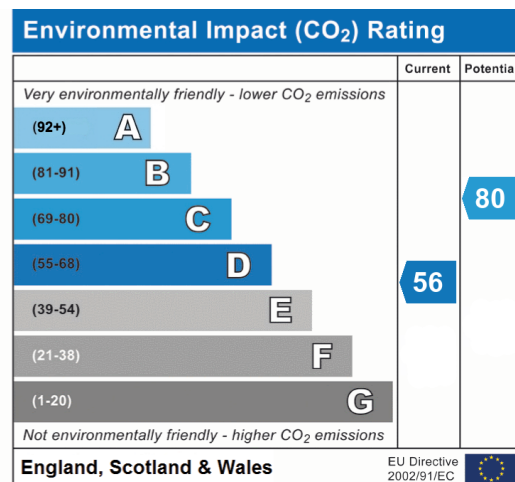
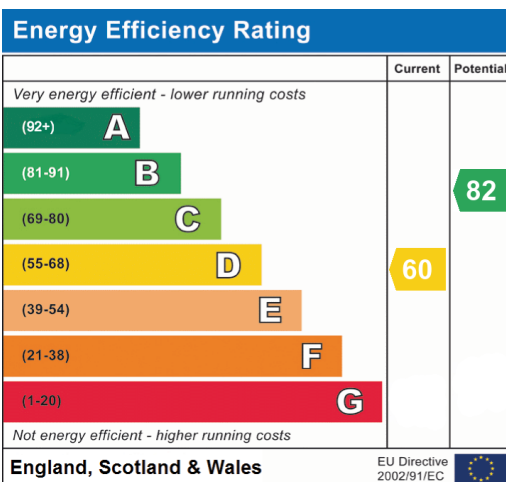
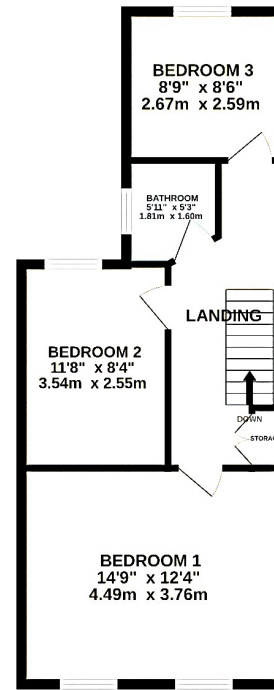



20-22 Bridge End, Leeds, LS1 4DJ
t: 0330 004 0050 e: hello@bettermove.co.uk
www.bettermove.co.uk