

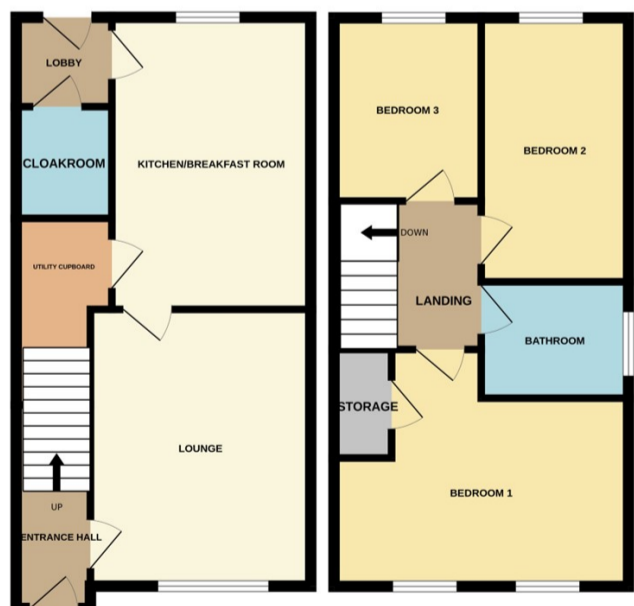

Bourne

£117,500



*****50% SHARED OWNERSHIP***** Rosedale are delighted to offer to the market this show home condition property with a spacious South facing garden and off road parking next to the property. The property has been well maintained throughout and offers three bedrooms, main with fully fitted wardrobe and family bathroom. Downstairs there is a lounge to the front, kitchen/breakfast, under stairs utility cupboard, rear lobby and cloakroom. The rear garden has also been well maintained with lawned area, patio and mature shrubs. To fully appreciate this property viewings are highly recommended. EPC Energy Rating B/Council Tax Band B.