



HILTON KING & LOCKE
SPECIALISTS IN PROPERTY



16a Blumfield Crescent, Slough, Berkshire.

£675,000 Freehold

A chance to purchase this excellent four bedroom, two reception, two bathroom detached family house, situated in popular Blumfield Crescent on the Slough/Burnham border. In total there is over 1200 square ft of accommodation on offer.

The ground floor includes a 14'8 x 11'10 front aspect living room, which leads directly into a dining room that in turn has french doors leading out to the garden.

There is also an impressive 17'10 x 9'2 kitchen/breakfast room which features a breakfast bar, ample modern eye and base level units, while also having a delightful twin rear aspect overlooking the garden. Completing the ground floor and located directly off the kitchen is a handy utility with built in storage.

Upstairs, is an 14'4 x 9'2 master bedroom that has its own ensuite shower room and offers a rear aspect over the garden, a 14'0 x 11'11 second bedroom that has double wardrobes, plus there are two more front aspect bedrooms, both of which also have built in wardrobes.

A modern, contemporary styled bathroom which



has a panel bath with screen and shower over, completes the first floor.

Outside, the rear garden is low maintenance and is mainly laid to lawn with a patio, plus to the rear of the garden is your own parking space.

THE AREA

Burnham High Street is found locally which offers a range of day to day needs and facilities, while more extensive shopping can be found at either Slough or Maidenhead.

The M4 (Junction 7) is less than two miles away as is the M40, which in turn provides access to the M3 and M25. Cross rail (Elizabeth Line) can be found locally at Burnham Station which is 0.5 miles away, plus also within easy reach are both Slough & Maidenhead Stations.



Important Notice

Particulars: These particulars are not an offer or contract, nor part of one. You should not rely on statements by Hilton King & Locke Ltd in the particulars or by word of mouth or in writing as being factually accurate about the property, its condition or its value. Hilton King & Locke Ltd does not have any authority to make any representations about the property, and accordingly any information given is entirely without responsibility on the part of the agents, seller(s) or lessor(s).

Photographs etc: The photographs show only certain parts of the property as they appeared at the time they were taken. Areas, measurements and distances given are approximate only.



The Broadway
Farnham Common Buckinghamshire SL2 3QH

Tel: 01753 643555
fc@hklhome.co.uk

16A Blumfield Crescent

Approximate Gross Internal Area

Ground Floor = 56.4 sq m / 607 sq ft

First Floor = 55.9 sq m / 602 sq ft

Total = 112.3 sq m / 1,209 sq ft

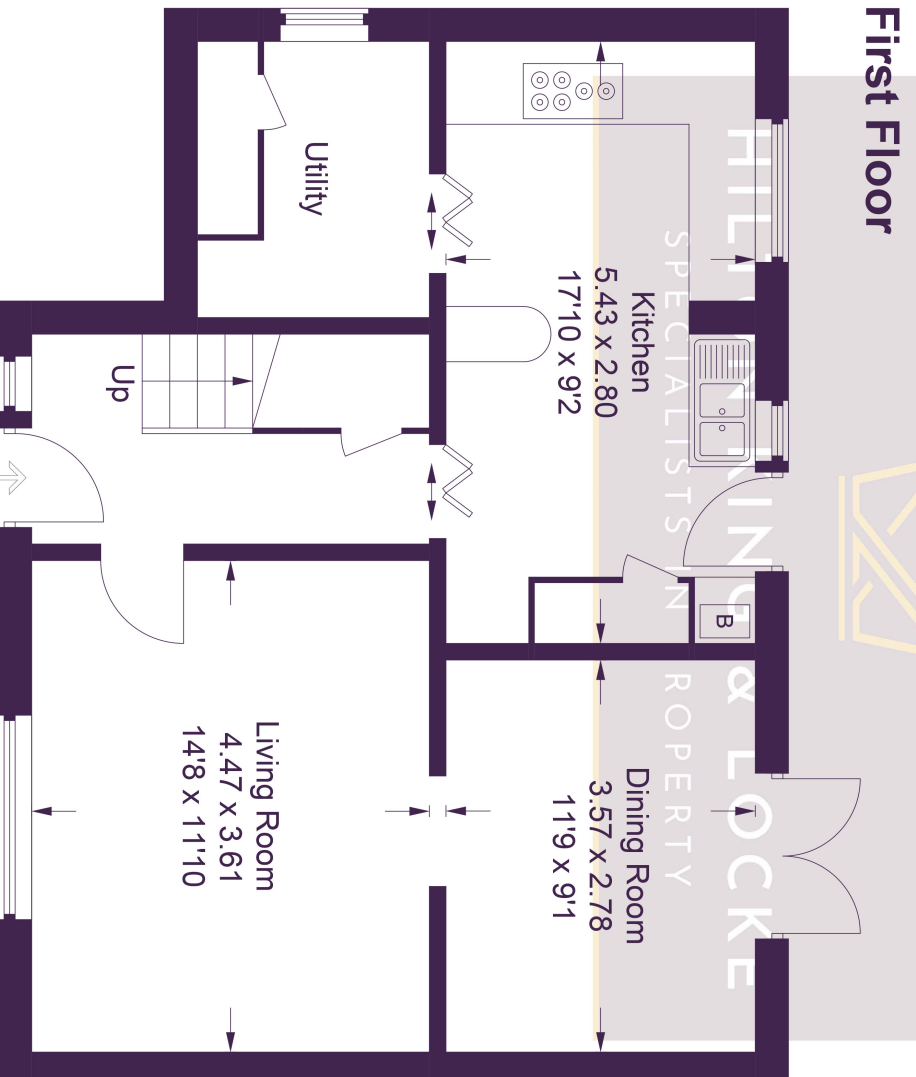
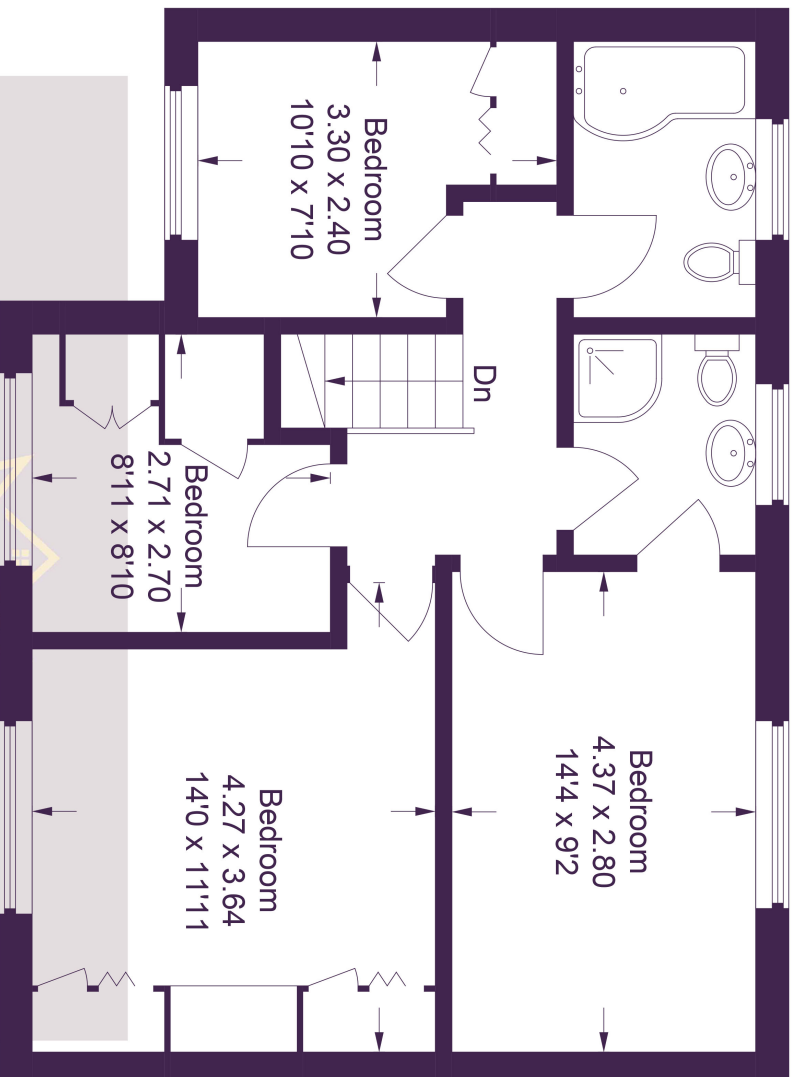

Ground Floor

This plan is for layout guidance only. Not drawn to scale unless stated. Windows and door openings are approximate. Whilst every care is taken in the preparation of this plan, please check all dimensions, shapes and compass bearings before making any decisions reliant upon them.