

FOR  
SALE



15 Beaufort Way, Worksop, Nottinghamshire S81 7NF

£220,000 - Freehold



78, Bridge Street, Worksop, S80 1JA 01909 509001 [info@bartropanddilks.co.uk](mailto:info@bartropanddilks.co.uk)



## PROPERTY SUMMARY

Of possible interest for first time buyers with an internal inspection being most highly recommended is this well presented and decorated three bedroom semi detached home that has gas central heating and uPVC double glazed windows. Being set within this much sought after area, the accommodation comprises of; entrance porch, lounge/dining room with fire surround and gas fire, well fitted kitchen with hob, double oven and extractor. On the first floor; landing, three bedrooms and bathroom with modern white four piece suite. Outside; gardens to the front and rear, the rear with patio and being enclosed, driveway and garage. Viewing Advised.

## POINTS OF INTEREST

- *Of Interest FTB's*
- *Well Presented & Decorated*
- *Highly Popular Area*
- *Three Bedroom*
- *Semi Detached*
- *GFCH & uPVC DG*
- *Driveway & Garage*
- *Bathroom with separate shower*
- *Enclosed Rear Garden*
- *Viewing Highly Advised*



## ROOM DESCRIPTIONS

### GROUND FLOOR

#### Entrance Porch

With entrance door, door to the lounge.

#### Lounge/Dining Room 7.00m x 3.66m (23' 0" x 12' 0")

Max measurements with front window, rear French doors, fire surround and gas fire, two central heating radiators.

#### Kitchen 2.92m x 2.20m (9' 7" x 7' 3")

Modern kitchen with wall and base fitted units, worksurfaces, sink unit, rear window and door, gas hob with extractor, double oven, enclosed boiler, plumbing for an automatic washing machine.

### First Floor

#### Landing

With loft access and loft ladder.

#### Bedroom One 3.72m x 2.65m (12' 2" x 8' 8")

With a front facing window, central heating radiator.

#### Bedroom Two 3.11m x 2.60m (10' 2" x 8' 6")

With a rear facing window, central heating radiator.

#### Bedroom Three 2.86m x 2.49m (9' 5" x 8' 2")

With a front facing window, central heating radiator.

#### Bathroom

Quality four piece suite with shower cubicle and electric shower, panelled bath, low flush w.c, wash hand basin, central heating radiator, cylinder airing cupboard, tiling, rear facing window.

### OUTSIDE

#### Gardens

Front and rear lawned gardens. The rear with patio and being enclosed.

#### Driveway

#### Garage

GROUND FLOOR

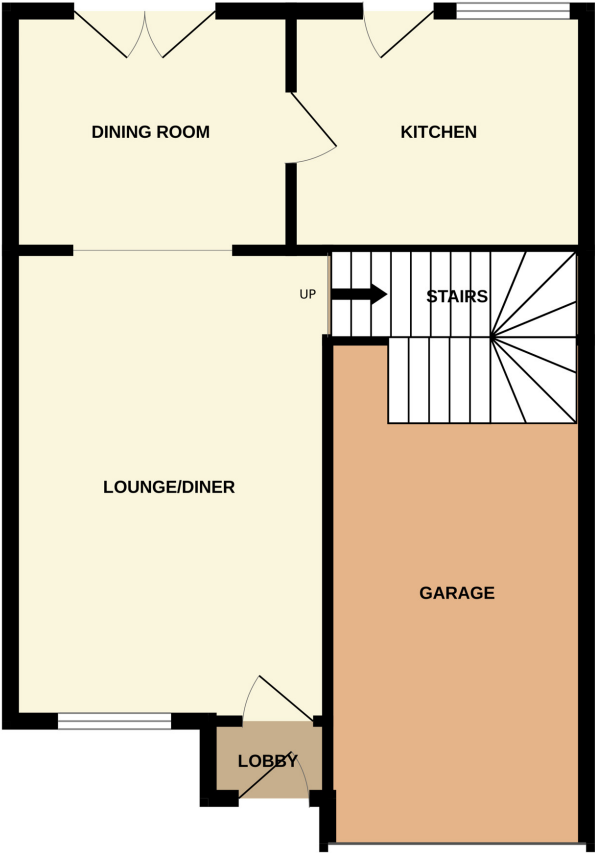

1ST FLOOR

