

# Truuli



## Gloucester Road, Croydon, Surrey, CR0 2DH

£375,000 Freehold

- Perfect home to start a family
- Two bedroom terraced house
- No onward chain
- Spacious garden
- Close to transport & local amenities
- Good order throughout

Southbridge Place, Surrey, CR0 4HA

Tel: 0330 043 0002

Email: [save@truuli.co.uk](mailto:save@truuli.co.uk) Web: [www.truuli.co.uk](http://www.truuli.co.uk)

# Gloucester Road, Croydon, Surrey, CR0 2DH

£375,000 Freehold

\*\*\*Vendor comments\*\*\* "This delightful 19th Century railway worker's cottage, with its new slate roof and period features, has been my cherished home for over 15 years. It's a blend of history and modern comfort."

Gloucester Road

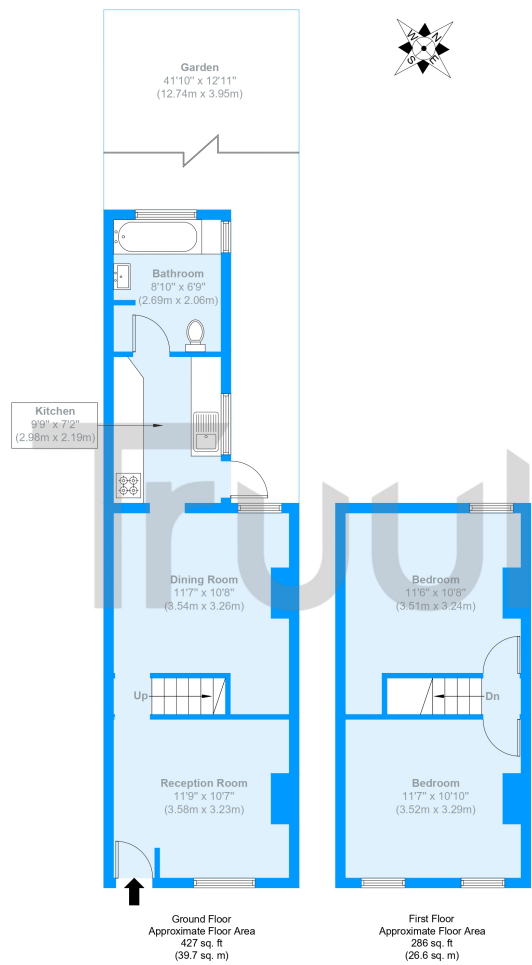

Approximate Gross Internal Area = 66.3 sq m / 714 sq ft

The Floor plan is not to scale and measurements and areas shown are approximate and therefore should be used for illustrative purposes only. The plan has been prepared in accordance with the RICS code of Measuring Practice and whilst we have confidence in the information produced it must not be relied on. Maximum lengths and widths are represented on the floor plan. If there is any aspect of particular importance, you should carry out or commission your own inspection of the property.  
Copyright @ BleuPlan

