

FOR SALE

Cobbold Road,
Shepherd's Bush, W12

Terraced House
Askew Village

£1,400,000 fh

5  3  2 



**horton
and garton**

SALES / LETTINGS / PROPERTY MANAGEMENT

hortonandgarton.co.uk | Sales 020 8819 0510 | Lettings 020 8819 0511
172 King Street, Hammersmith, W6 0QU



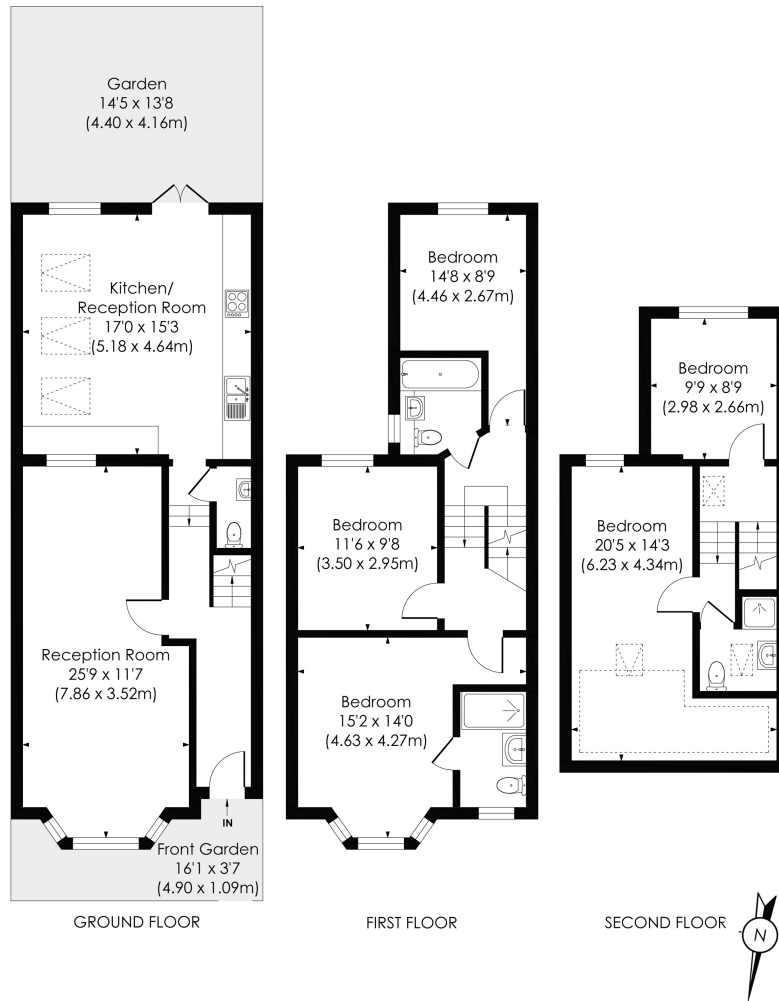

COBBOLD ROAD, W12

Approx. Gross Internal Floor Area
1551 Sq'/144.09 SqM (Including Reduced Height)
1477 Sq'/137.19 SqM (Excluding Reduced Height)

© Pixangle Property Marketing Ltd. info@pixangle.com Tel: 0208 870 2118

**horton
andgarton**

This floor plan has been prepared for the purpose of illustration only in accordance with the latest RICS code of measuring practice and is not to scale. All measurements and areas are approximate and whilst every effort has been made to ensure the accuracy of the plan contained here, no responsibility is taken for any error, omission or misstatement.



Victorian terraced house | Five bedrooms - Three
bathrooms | 1551 Sq' - 144 SqM | Recently refurbished |
EPC rating C | Askew Village



hortonandgarton.co.uk
Sales 020 8819 0510
Lettings 020 8819 0511

172 King Street, Hammersmith, W6 0QU