



Stile Hall Gardens, London, W4 3BS

Cow & Co
LONDON



A beautifully presented and imposing semi-detached, five/six bedroom Victorian family house with off road parking and a large private garden situated just north of the river.

Boasting two south facing interconnecting reception rooms, five double bedrooms, boot room, store room, open plan kitchen/dining room, utility room, cellar, family bathroom, shower room, mature garden with studio building, exceptional built in storage and stunning period features throughout.

Stile Hall Gardens is a short walk from both Gunnersbury tube (district line) and railway station offering easy transport into central London and to Richmond, as well as Kew Bridge Railway station with regular connections to Waterloo. The area also offers easy access to central London via the A4 and to Heathrow and the West via the M4 as well as the A316 for Richmond and the South.



- Stunning Victorian house
- 5/6 bedrooms
- Double reception with lovely feature fireplaces
- Over 2,240 sqft
- Off road parking for 3 cars
- Period features throughout
- Gunnersbury Underground and Kew Bridge mainline stations
- Excellent schools within walking distance

Stile Hall Gardens, London, W4

Approximate Area = 2142 sq ft / 199 sq m

Outbuilding = 100 sq ft / 9.3 sq m

Total = 2242 sq ft / 208.2 sq m

For identification only - Not to scale

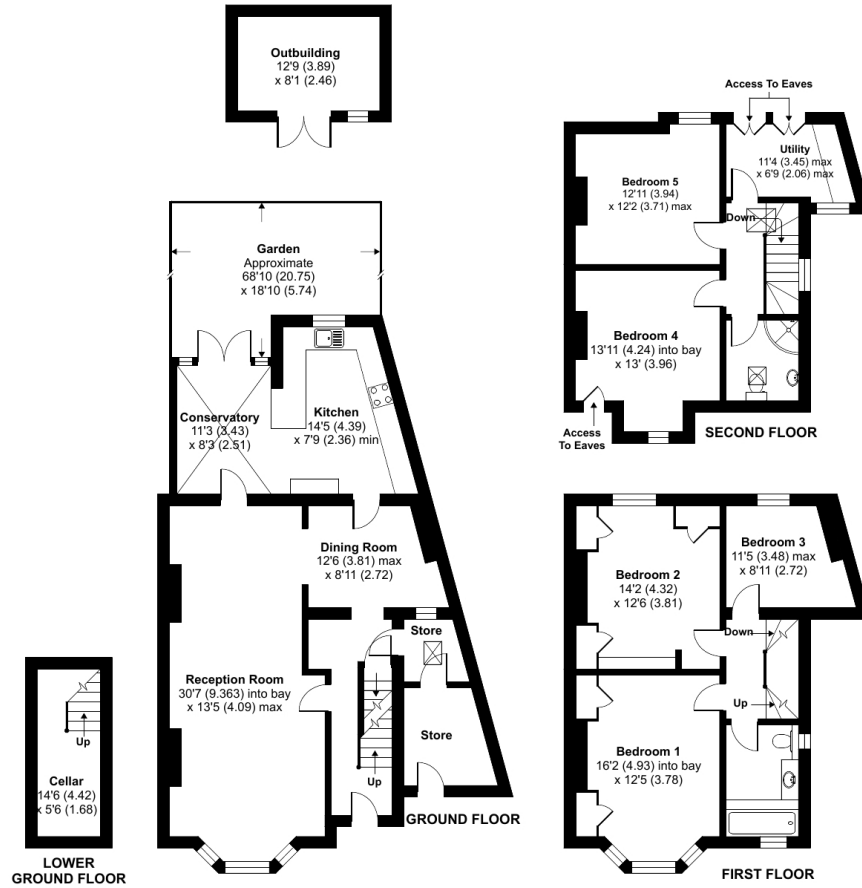

Floor plan produced in accordance with RICS Property Measurement Standards incorporating International Property Measurement Standards (IPMS2 Residential). © nchecon 2023. Produced for Cow & Co Properties Ltd. REF: 942043

Tel: 0208 065 0010
 Email: thehub@cowandco-london.com
 Web: cowandco-london.com

Agents note: All measurements are approximate and whilst every attempt has been made to ensure accuracy they are for general guidance only and must not be relied on. The fixture and fittings referred to have not been tested and therefore no guarantee can be given that they are in working order. Internal photographs are reproduced for general information and it must not be inferred that any item shown is included with the property.

Cow & Co
 LONDON