



£525,000
Dene Avenue, Sidcup, Kent, DA15 9LD

**Christopher
Russell**
PROPERTY SERVICES



AGENTS NOTES: No statement in these particulars is to be relied upon as representations of fact and purchasers should satisfy themselves by inspection, or otherwise, as to the accuracy of the statements contained herein. These details do not constitute any part of any offer or contract. Christopher Russell have not tested any equipment or heating system mentioned and purchasers are advised to satisfy themselves as to their working order. Great care is taken when measuring but measurements should not be relied upon for ordering carpets, equipment etc.

Christopher Russell LLP. Registered in Cardiff. Partnership No. OC329088

Christopher Russell Property Services

33 The Oval, Sidcup, Kent DA15 9ER • Tel: 020 8300 1234 Fax: 020 8300 6530 • sales@christopher-russell.co.uk

Rare opportunity to purchase a three-bedroom semi-detached house situated on a wider than average plot in a highly sought-after cul-de-sac, offering significant potential to refurbish and extend into a substantially larger family home.

Many of the properties in Dene Avenue have been extended to include full-width double-storey extensions, highlighting the excellent development potential on offer.

The property is ideally located for Sidcup train station, as well as a range of highly regarded primary, secondary and grammar schools, making it an excellent choice for families and commuters alike.

Offered to the market with no onward chain, the accommodation currently comprises an entrance hall, lounge, kitchen and bathroom on the ground floor, with three bedrooms on the first floor.

Externally, there is a driveway providing off-street parking to the front and access to a detached garage.

The secluded rear garden extends to approximately 100ft, providing excellent outdoor space and further potential.

Council Tax Band D.



GROUND FLOOR
543 sq.ft. (50.5 sq.m.) approx.

1ST FLOOR
282 sq.ft. (26.2 sq.m.) approx.

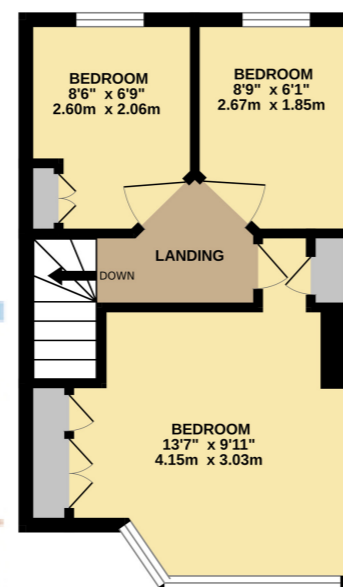
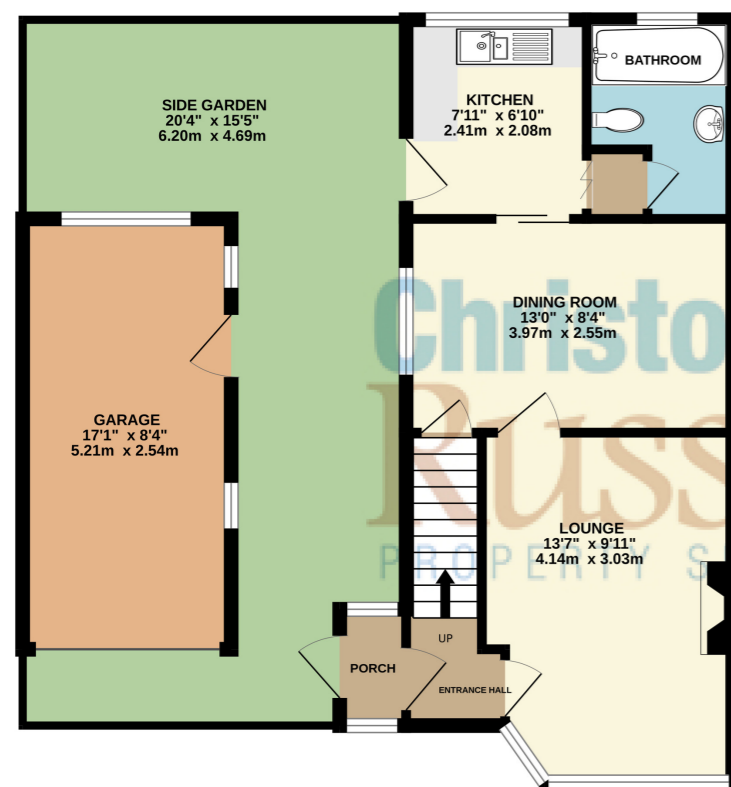

Christopher Russell
PROPERTY SERVICES

TOTAL FLOOR AREA : 825 sq.ft. (76.7 sq.m.) approx.
Whilst every attempt has been made to ensure the accuracy of the floorplan contained here, measurements of doors, windows, rooms and any other items are approximate and no responsibility is taken for any error, omission or mis-statement. This plan is for illustrative purposes only and should be used as such by any prospective purchaser. The services, systems and appliances shown have not been tested and no guarantee as to their operability or efficiency can be given.
Made with Metropix ©2026



Energy Efficiency Rating		Current	Potential
Very energy efficient - lower running costs			
(92+)	A		
(81-91)	B		
(69-80)	C		
(55-68)	D	60	78
(39-54)	E		
(21-38)	F		
(1-20)	G		
Not energy efficient - higher running costs			
EU Directive 2002/91/EC			
England, Scotland & Wales			