



Eddleston Way, Tilehurst, Reading, Berkshire.
RG30 4GY.

£1,750 pcm

Arins Property Services - Offered to the rental market and available from the 25th October is this well presented unfurnished three bed roomed mid terrace property. The property is situated close to local amenities and bus route into Reading Town centre. The property offers accommodation to include a lounge, refitted modern kitchen/breakfast room. Further benefits include family bathroom with shower over bath, a ground floor W/C and a low maintenance enclosed rear garden.

- Three Bedrooms
- En Suite to Master
- Residents Parking
- Close to Bus Routes
- Downstairs W/C
- EPC Rating B
- Unfurnished
- Available 25th October





GROUND FLOOR
398 sq.ft. (37.0 sq.m.) approx.

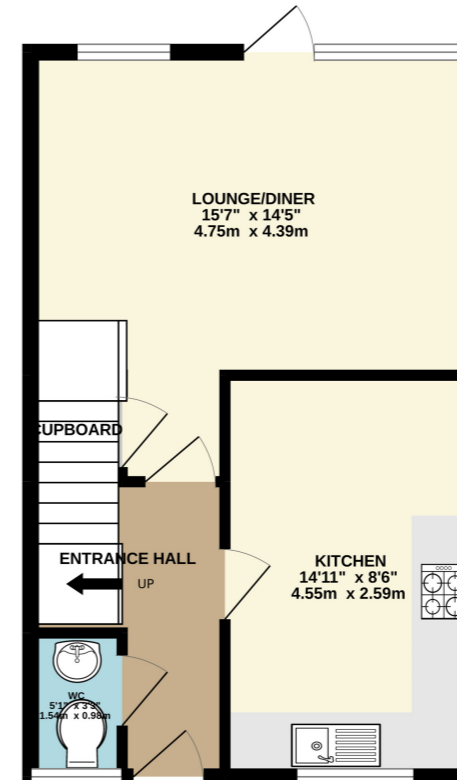

1ST FLOOR
398 sq.ft. (37.0 sq.m.) approx.

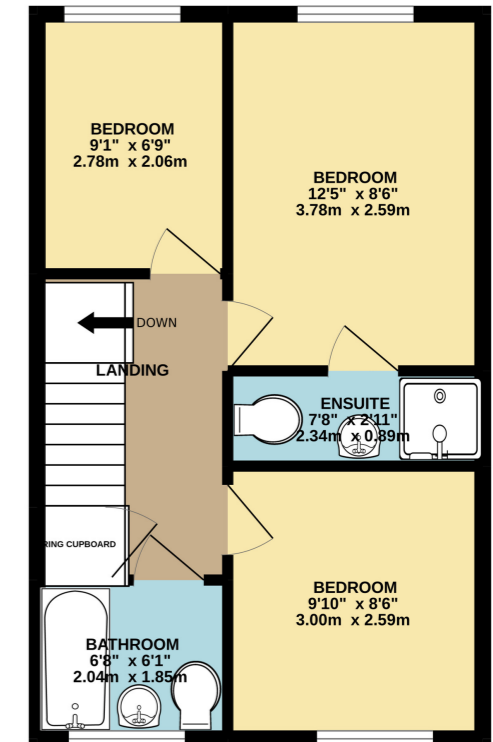

TOTAL FLOOR AREA : 797 sq.ft. (74.0 sq.m.) approx.
Whilst every attempt has been made to ensure the accuracy of the floorplan contained here, measurements of doors, windows, rooms and any other items are approximate and no responsibility is taken for any error, omission or mis-statement. This plan is for illustrative purposes only and should be used as such by any prospective purchaser. The services, systems and appliances shown have not been tested and no guarantee as to their operability or efficiency can be given.
Made with Metroix 5/2022

Property Description

Ground Floor

Entrance Hall

W/C

3' 0" x 4' 11" (0.91m x 1.50m)

Kitchen

8' 6" x 14' 11" (2.59m x 4.55m)

Lounge

15' 7" x 14' 5" (4.75m x 4.39m)

First Floor

Master Bedroom

8' 6" x 12' 5" (2.59m x 3.78m)

En Suite

7' 8" x 2' 11" (2.34m x 0.89m)

Bedroom Two

8' 6" x 9' 10" (2.59m x 3.00m)

Bedroom Three

6' 9" x 9' 1" (2.06m x 2.77m)

Bathroom

6' 8" x 6' 1" (2.03m x 1.85m)

Note:

Advertising photos taken December 2022 before last Let.

Council Tax Band

C

