



**Walton Cardiff**

**01684 293246**



## 8 Honeysuckle Crescent, Walton Cardiff, Tewkesbury, GL20 7FQ

Built less than 6 years ago and still retaining the remaining NHBC warranty this modern semi-detached home is immaculately presented.

On the ground floor an entrance hall leads into the lounge. From here a door leads into the spacious and light kitchen/dining room which is fitted with a range of wall and base units with integrated double oven, electric hob and extractor over.

There are glazed patio doors out to the rear garden and an opening into a useful utility area with access to a downstairs wc.

On the first floor there are three bedrooms and family bathroom. The main bedroom has the advantage of fitted wardrobes and a modern ensuite shower room.

The family bathroom again is modern, fitted with a white suite comprising of a panel bath with shower over, pedestal wash basin and low level wc.



Outside the garden has been designed with low maintenance in mind with gated side access which leads to the drive at the side. At the side is the single garage with ample driveway parking in front.

Being a modern build, it has excellent energy efficient ratings with gas fired central heating, upvc double glazing and cavity wall insulation.

Located on the new phase of this popular residential area, it is within easy walking distance of local convenience stores and eateries and the town centre which is less than 1 mile away.

Tewkesbury is a popular Abbey town with a wealth of leisure, health, and education facilities including hospital, theatre, swimming pool and sports centre all within easy walking distance of Cotswold Gardens.

Centrally situated between Cheltenham, Worcester, Gloucester and Evesham it is an excellent commuting base, with Birmingham and other major cities made easy with the motorway and rail networks readily accessible.

### Ground Floor

Entrance Hall  
 Lounge 14'3"X11'11"  
 Kitchen/Dining Room 12'2"x12'  
 Utility  
 Wc

### First Floor

Bedroom 1 9'9"x9'5"  
 Ensuite 8'4"x3'11"  
 Bedroom 2 10'2"x8'10"  
 Bedroom 3 6'10"x6'6"  
 Bathroom 7'8"x5'6"

### Outside

Single Garage  
 Driveway Parking

**Tewkesbury Borough Council Tax Band C**

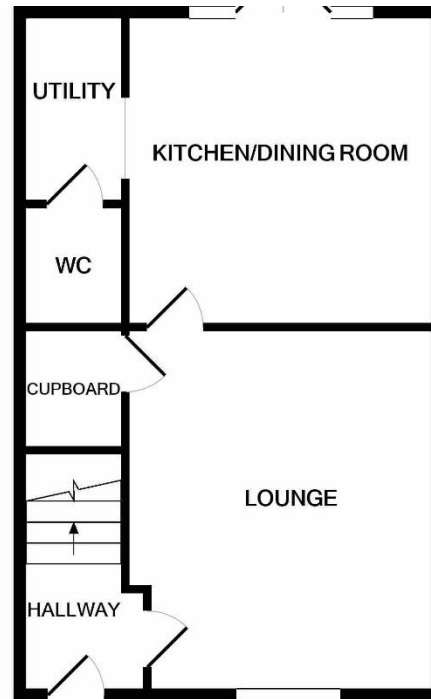

GROUND FLOOR

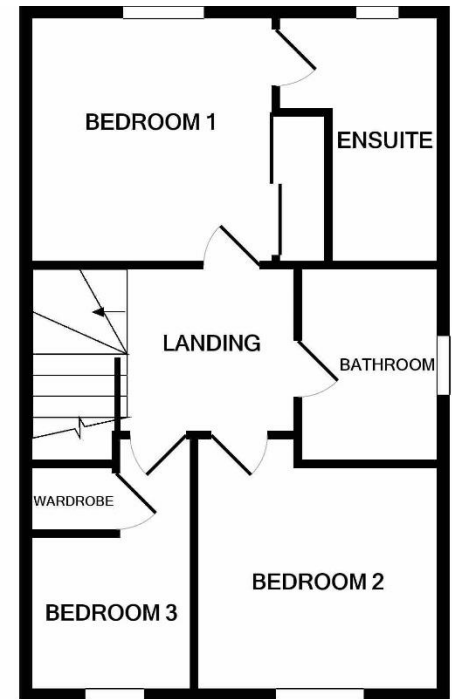

1ST FLOOR



**Guide Price £315,000 Freehold**

Viewing strictly by arrangement with Engall Castle Ltd  
 155 High Street Tewkesbury Gloucestershire GL20 5JP  
 Office hours: Mon – Fri 9am to 6pm, Sat 9am to 4pm  
 email: [sales@engallcastle.com](mailto:sales@engallcastle.com)

**01684 293 246**  
[www.engallcastle.com](http://www.engallcastle.com)

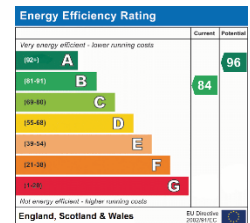

This floorplan is provided for guidance only as an approximate layout of the property and should not be relied upon as a statement of fact.

### Agents Note

These property details are set out as a general outline only and do not constitute any part of an Offer or Contract. Any services equipment, fittings or central heating systems have not been tested and no warranty is given or implied by Engall Castle Ltd that these are in working order. Buyers are advised to obtain verification from their solicitor or surveyor. Fixtures and fittings or other items are not included unless specifically described. All measurements, distances and areas are approximate and for guidance only and should not be relied upon for the purposes of fitting carpets or furniture etc. These property details and all statements within this document are provided without responsibility on behalf of Engall Castle Ltd or its employees or representatives and should not be relied on as statements of fact. Prospective purchasers must satisfy themselves as to the accuracy of all details pertaining to the property.

