



Chestnut Walk, Little Baddow, CM3 4SP

Council Tax Band F (Chelmsford City Council)



£750,000 Freehold

ACCOMMODATION

Located in one of the most requested and sought after private lanes in Little Baddow, this detached bungalow is offered for sale with no onward chain and offers scope for further improvement and extension (stpp).

The accommodation comprises an entrance porch, spacious entrance hall, 19ft living room with feature fireplace, dining area, fitted kitchen with integrated appliances, UPVC conservatory, two double bedrooms, fully tiled shower room/wc and a separate cloakroom. The property also has gas central heating, double glazing to most windows and UPVC soffits.

Outside the property enjoys an overall plot of 0.15 acres and is set back from the road with a lawned front garden with mature tree and shrubs. There is a driveway providing off road parking for 2/3 cars as well as access to the detached garage. There is side pedestrian access leading to the rear garden which has an easterly facing aspect and extends to approximately 35ft x 60ft. The enclosed garden features a patio area to the rear of the bungalow with a central lawn area with flower and shrub borders.

LOCATION

The property is located in highly sought after private lane within the attractive village of Little Baddow. Little Baddow has a thriving community and is situated between Danbury to the South and Hatfield Peverel to the North. The village is a haven for walkers as it is surrounded by open countryside and woodland, much of which is protected by the Essex Wildlife Trust and the National Trust. The neighbouring village of Danbury and offers a range of local facilities which are within walking distance of the property. Local schools include private education at Elm Green and Heathcotes and state schools of Danbury Park and St Johns C of E Primary School. Amenities within the village of Danbury include a local co-op supermarket, public houses and a parish church. For the commuter, Chelmsford's mainline station lies approximately 6 miles to the west of Little Baddow with Chelmsford city centre offering a more extensive range of shopping and leisure activities with both state and private schooling available.

AGENTS NOTE

This property sale is subject to probate application being completed. Interested parties are therefore advised that the transaction could be subject to delays until probate has been granted.

- Established detached bungalow
- 19ft living room with feature fireplace
- Fitted kitchen with integrated appliances
- Fully tiled shower room with separate cloakroom/wc
- 0.15 acre plot
- Two double bedrooms
- Dining area
- Conservatory
- Detached garage and driveway parking for 2/3 cars
- No onward chain









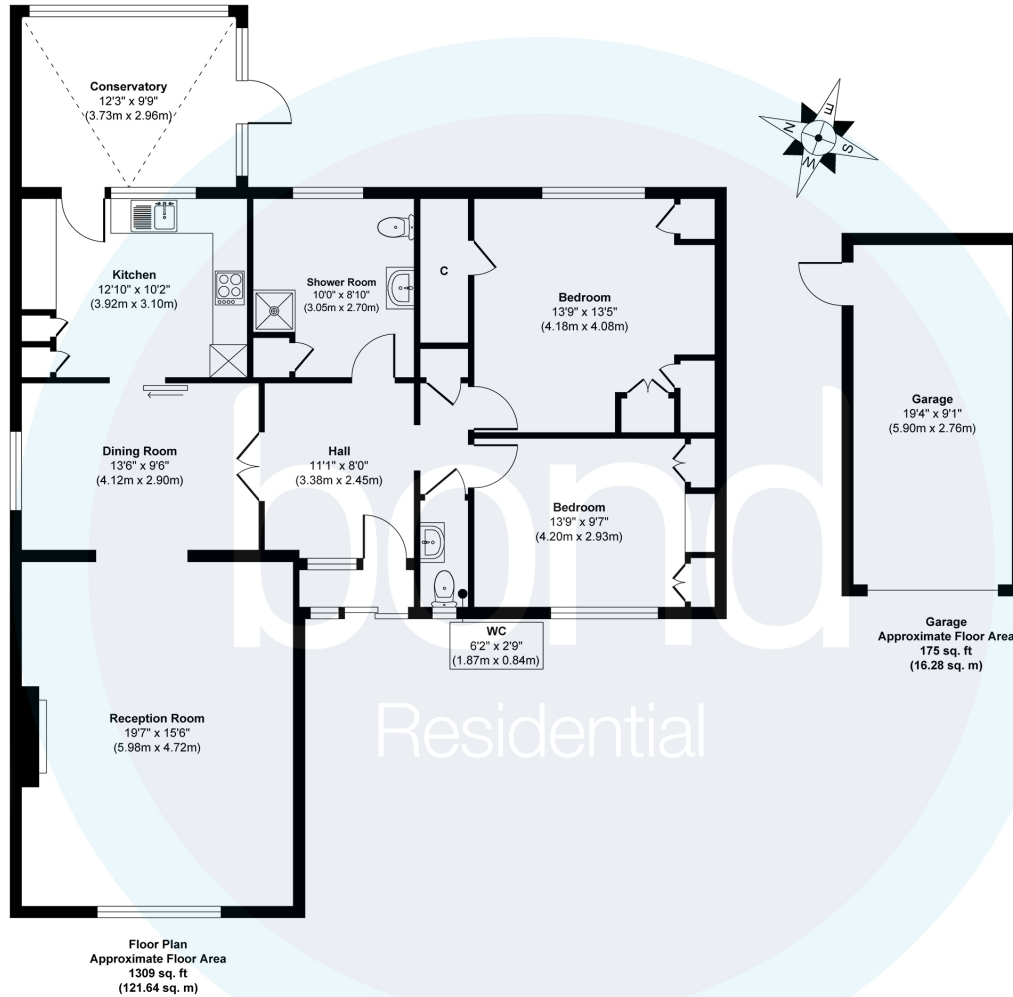

Approx. Gross Internal Floor Area 1484 sq. ft / 137.92 sq. m

Illustration for identification purposes only, measurements are approximate, not to scale.

Produced by Elements Property

10, Maldon Road,
Danbury, Essex, CM3 4QQ
Telephone: 01245 222856
Website: www.bondresidential.co.uk

Consumer Protection from Unfair Trading Regulations 2008 and the Business Protection from Misleading Marketing Regulations 2008. Bond Residential have made every effort to ensure that consumers and/or businesses are treated fairly and provided with accurate material information as required by law. We have not tested any apparatus, equipment, fixture, fitting or any services and as such are unable to verify they are in working order, fit for their purpose, or within the ownership of the seller or landlord. Neither have we been able to check the legal documentation to verify the legal status of the property. We therefore advise potential buyers or tenants to verify these matters with their own solicitors or other advisers.

