

Truuli



Osborne Road, Thornton Heath, Surrey, CR7 8PB

£375,000 Freehold

- Two separate reception rooms
- Large rear private garden
- Easily accessible to Thornton Heath mainline station
- Close to Grangewood Nature park
- Chain free family home
- Guide price £375,000 - £400,000

Southbridge Place, Surrey, CR0 4HA

Tel: 0330 043 0002

Email: save@truuli.co.uk Web: www.truuli.co.uk

Osborne Road, Thornton Heath, Surrey, CR7 8PB

£375,000 Freehold

*** Guide price £375,000 - £400,000 *** A chain-free two-bedroom family home on Osborne Road, Thornton Heath. The property is ready to move in and still offers the chance to add personal touches.

Ground Floor
367 sq. ft. (34.1 sq.m.) approx.

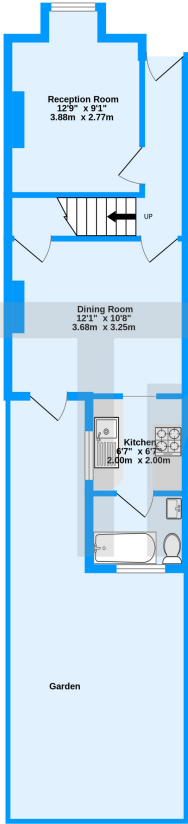

1st Floor
288 sq. ft. (26.8 sq.m.) approx.

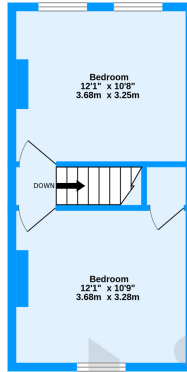

Osborne Road, Thornton Heath, CR7

TOTAL FLOOR AREA: 655 sq. ft. (60.9 sq.m.) approx.
Measurements are approximate. Not to scale. Illustrative purposes only
Made with MetroPix ©2023

