



5 The Maltings, Norton Road, Letchworth Garden City, Hertfordshire, SG6 1AR

£275,000

Lane & Bennetts are pleased to present this two double bedroom bungalow, located in the beautiful surroundings of Norton Hall Farm. This established development is aimed at the over 50's, providing comfortable independent living.

The property has a large lounge/diner with modern sliding doors affording access to a rear patio facing lawn & trees, the entrance hall has ample storage and doors to all rooms. The kitchen is fitted, with space for washing machine and fridge freezer, again with pleasant rear view. The dual aspect main bedroom has a useful en suite WC, complimented by the main bathroom with bath & shower. The second bedroom has a fine range of fitted furniture.

Lane &
BENNETTS

5 The Maltings, Norton RA SG6 1AR

Approximate Gross Internal Area

697 sq ft - 65 sq m

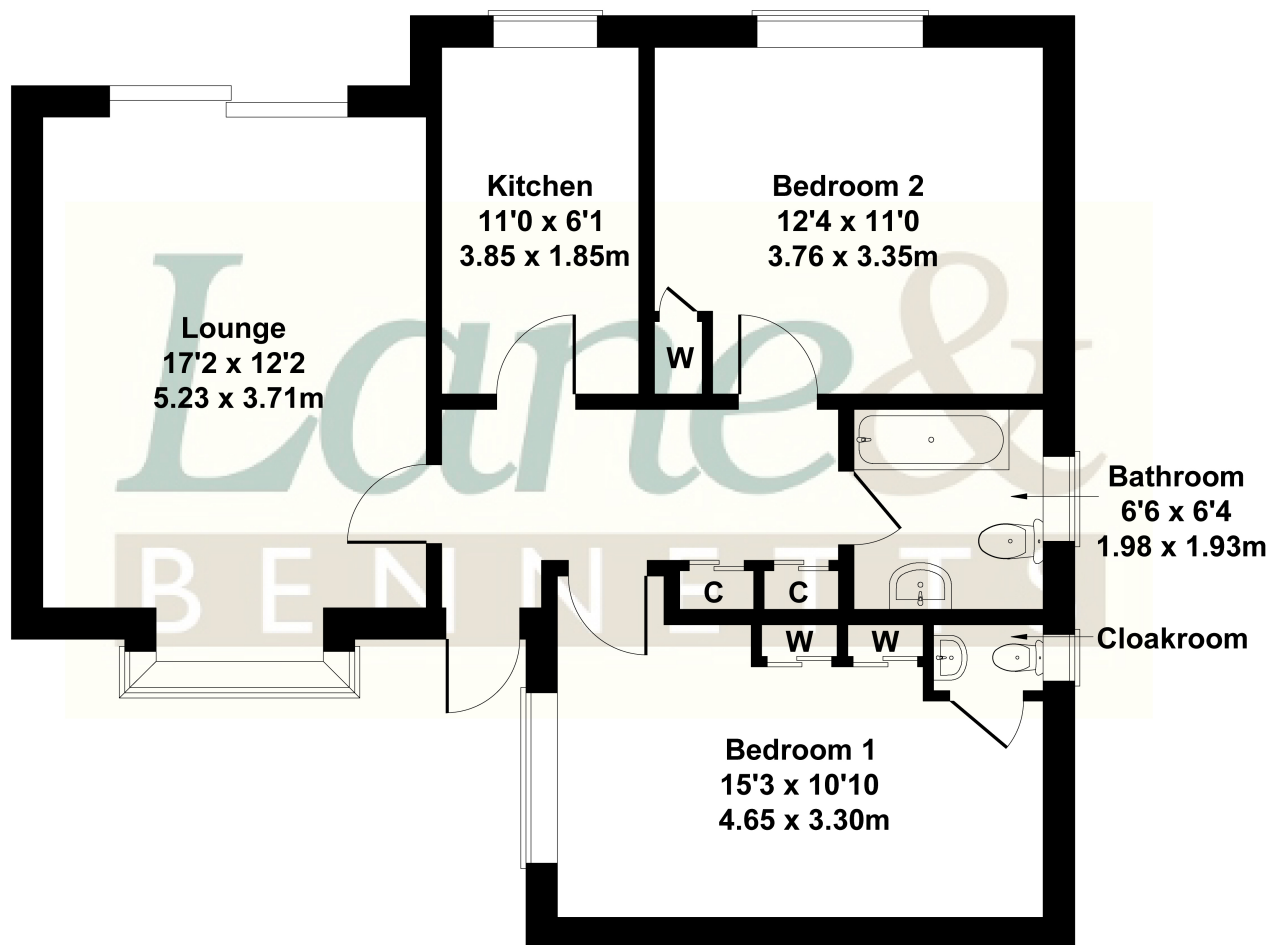

Not to Scale. Produced by The Plan Portal 2023
For Illustrative Purposes Only.

- COMMUNAL GARDENS & FACILITIES
- CLOSE TO AMENITIES
- LARGE LOUNGE WITH FRENCH DOORS TO GARDEN
- FITTED KITCHEN
- EN SUITE WC TO MAIN BEDROOM
- MAIN BATHROOM
- WELL MAINTAINED GARDENS & EXTERIOR
- LARGE LOUNGE WITH SLIDING DOOR TO PATIO
- SOUGHT AFTER F DEVELOPMENT FOR OVER 55's
- COUNCIL TAX: C | EPC: D | TENURE: LEASEHOLD
(A NEW 90 YEAR LEASE IS OFFERED TO EACH NEW OCCUPIER)

