



Emlyn Road, London, W12 9TB

Cow & Co
LONDON



A fully refurbished stunning two bedroom apartment with its own private garden and private entrance. Comprising of a large eat in kitchen/diner, two double bedrooms and a luxury new bathroom, this stunning property is situated in one of West London's most sought after locations. Close to Wendell Park and with easy access to Turnham Green and Chiswick High Road and the ever improving Askew Road, home of The Ginger Pig butcher/deli, Gail's and The Eagle gastro pub, plus numerous other cafes and independent shops.

This beautiful property is offered to the market chain free.

Local transport links include both Stamford Brook tube and Turnham Green tube stations, numerous bus routes leading to Shepherds Bush and Westfield and the A40/M40 for routes in and out of London.



- Chain free
- Two bedroom ground floor apartment offering exceptionally spacious accommodation
- Luxurious family bathroom
- Private Garden
- Fully refurbished throughout
- Close proximity to local transport links and amenities
- Highly sought after location

Emlyn Road, London, W12

Approximate Area = 714 sq ft / 66.3 sq m

For identification only - Not to scale

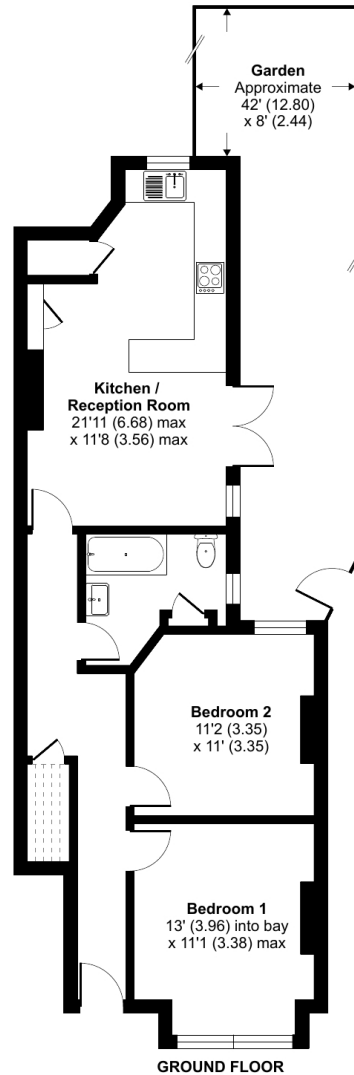

Floor plan produced in accordance with RICS Property Measurement Standards incorporating International Property Measurement Standards (IPMS2 Residential). © nchecon 2023. Produced for Cow & Co Properties Ltd. REF: 1041318

Tel: 0208 065 0010
Email: thehub@cowandco-london.com
Web: cowandco-london.com

Agents note: All measurements are approximate and whilst every attempt has been made to ensure accuracy they are for general guidance only and must not be relied on. The fixture and fittings referred to have not been tested and therefore no guarantee can be given that they are in working order. Internal photographs are reproduced for general information and it must not be inferred that any item shown is included with the property.

Cow & Co

LONDON