

46 Jeffery Street,  
Gillingham, ME7 1BZ

Tel: 01634 780760  
info@cobblestoneestates.co.uk



**27 St Georges Road, Gillingham, Kent, ME7 1JG**

**£1,500 pcm Freehold**

- AVAILABLE MID MAY
- END OF TERRACE HOUSE
- 3/4 BEDROOMS
- REAR GARDEN
- DOUBLE GLAZING
- GAS CENTRAL HEATING
- CLOSE TO GILLINGHAM HIGH STREET & TRAIN STATION
- EPC Rating E





Available now is this spacious 3/4 bedroom end of terrace house. Featuring 3 / 4 bedrooms and 2 receptions (reception 2 currently used as bedroom 4), modern kitchen, family shower room and separate WC. Too the first floor are three good sized bedrooms. At the rear of the property is a garden. the property also benefits from gas central heating and double glazing and there is a cellar that can be utilized for storage. Epc grade E.  
 \*Terms & conditions apply.

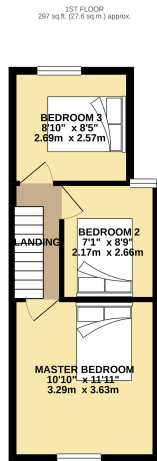
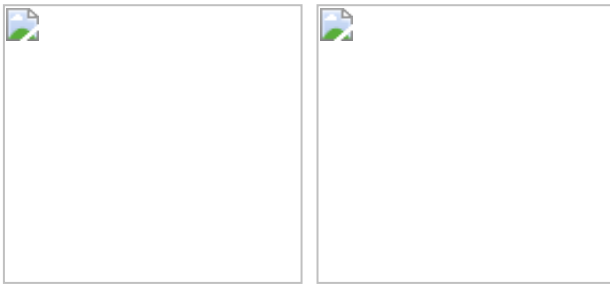

TOTAL FLOOR AREA: 686 sq ft, (63.8 sq m) approx.  
 Whilst every effort has been made to ensure the accuracy of the foregoing comparative floor measurements, it should be noted that these are approximate and not intended to be used as a basis for any legal or financial transaction. The plan is for illustrative purposes only and should be treated as such by any prospective purchaser. The actual, accurate and appropriate floor area will be determined by the quantity surveyor or other professional as to the quantity or efficiency can be given.  
 Made with Measure 1/2022