



- Two Bedroom, First Floor Apartment
- Share Of Freehold (No Service Charge Or Ground Rent Payable)
- Offered With No Onward Chain
- Well-Maintained Communal Areas With Storage
- Two Large Double Bedrooms
- Separate W.C. & Bathroom
- Kitchen-Breakfast Room
- Garage & Communal Front Gardens

2, Alexandra Court, Victoria Road, Lexden, Colchester, Essex. CO3 3NX.

Michaels Property Consultants are pleased to offer to the open market this excellent two bedroom, first floor apartment situated in the heart of 'Old Lexden' - one of Colchester city's most desirable districts. Offering secure and peaceful living within moments from Colchester's vibrant and historic city centre, this home is in close proximity to an array of useful shops, amenities and public transport links. Key highlights of this apartment include; well-maintained communal areas servicing only two first floor apartments, welcoming entrance hall, two large double bedrooms, kitchen-breakfast room, sizeable reception room, separate W.C, bathroom, garage and communal front gardens. Residents on road permit parking is also available, with visitors permits also available.



Property Details.

First Floor Apartment

Entrance Hall

Bedroom One



3.81m x 3.83m (12' 6" x 12' 7")

Bedroom Two



2.8m x 3.83m (9' 2" x 12' 7")

Living Room



4.01m x 5.05m (13' 2" x 16' 7")

Kitchen-Breakfast Room



3.15m x 3.76m (10' 4" x 12' 4")

Bathroom



Property Details.

W.C.



Lease & Share Of Freehold Information



This property is offered with favourable leasehold terms, with the lease length 5000 years from 17 September 1970. Alexandra Court is made up of 3 apartments and each resident has the added luxury of owning 1/3 of the freehold, with this property being offered on a share of freehold basis. No ground rent or service charge is payable, with the residents agreeing to a right to manage scheme. We do however advise all interested parties to confirm this information with their legal representative at an early stage of their conveyance to prevent any discrepancy.

Property Details.

Floorplans

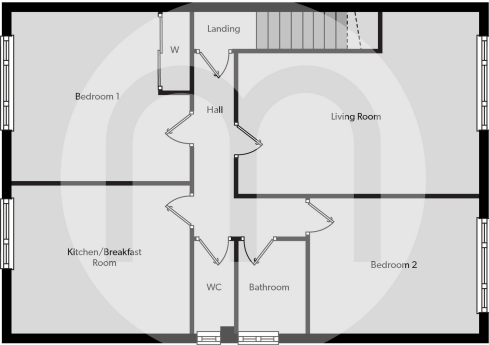

Location

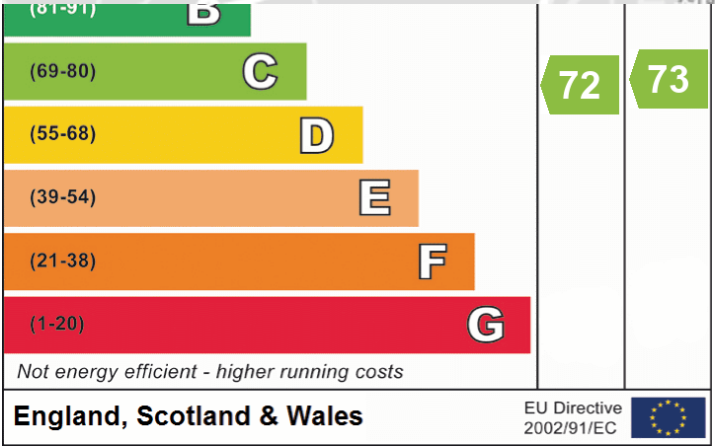
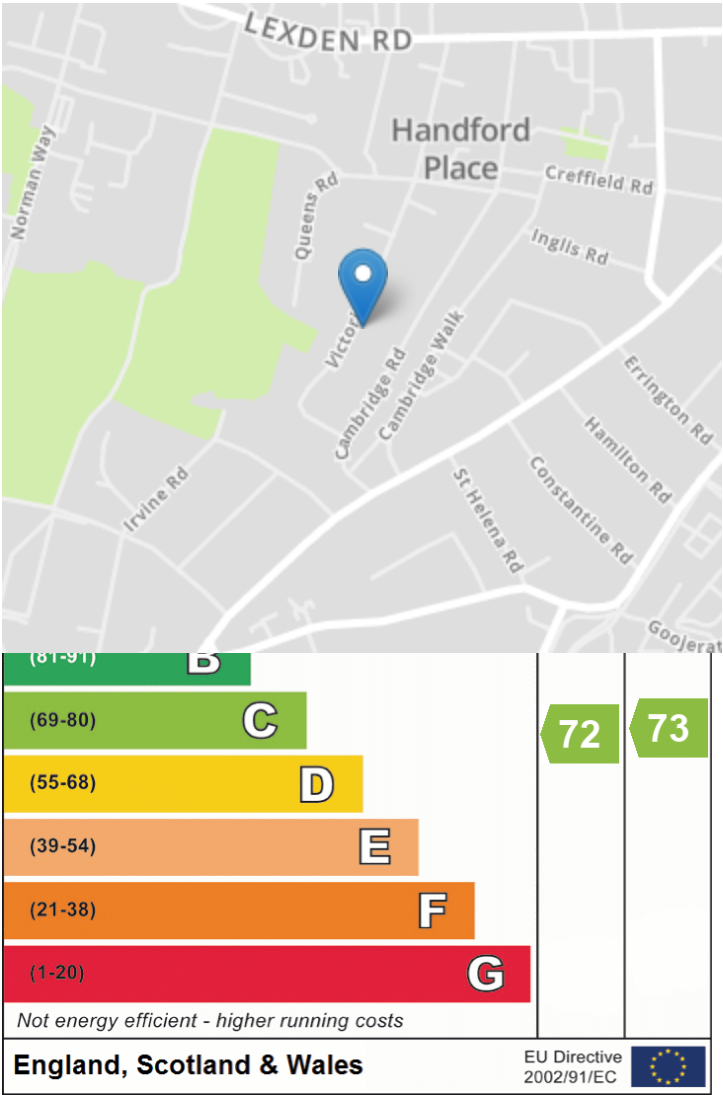

We have not carried out a structural survey and the services, appliances and specific fittings have not been tested. All photographs, measurements, floor plans and distances referred to are given as a guide only and should not be relied upon for the purchase of carpets or any other fixtures or fittings. Gardens, roof terraces, balconies and communal gardens as well as tenure and lease details cannot have their accuracy guaranteed for intending purchasers. Lease details, service ground rent (where applicable) are given as a guide only and should be checked and confirmed by your solicitor prior to exchange of contracts.