



Day & Co  
ESTATE AGENTS

28 Cavendish Street  
Keighley  
BD21 3RG



33 Cherry Tree Rise, Long Lee,  
Keighley, West Yorkshire, BD21  
4RY

£139,995

T: 01535 664609

W: [www.dayandcoestateagents.co.uk](http://www.dayandcoestateagents.co.uk)

E: [keighley@dayandcoestateagents.co.uk](mailto:keighley@dayandcoestateagents.co.uk)

- Mid Town House
- Gas Central Heating & Double Glazing
- EPC Rating C

- Two Double Bedrooms
- Modern Kitchen & Bathroom

## SUMMARY

**\*\*A TWO BEDROOM MID TOWN HOUSE, POPULAR LOCATION OF LONG LEE WITH EXCELLENT ACCESS TO THE PRIMARY SCHOOLS & FAR REACHING VIEWS TO THE REAR!!\*\*** Gas central heating, Double glazing, modern kitchen and bathroom, Garage (50% share of a double garage), EPC RATING C

## FULL DESCRIPTION

Of interest to a variety of buyers is this two bedroom mid town house, situated in the popular residential location of Long Lee with excellent access to the primary school and having far reaching views to the rear. The property comprises of an entrance hall, the lounge has double glazed window to the front, radiator. The dining kitchen has a range of modern base and wall mounted units, integrated oven, hob and extractor fan, double glazed window and door to the rear, and a pantry. To the first floor there are two double bedrooms, and the bathroom which has a modern three piece suite in white comprising of a bath with shower over, WC, wash hand basin, double glazed window to the rear. Externally there are front and rear gardens, and a garage (50% share of a double garage). EPC Rating C

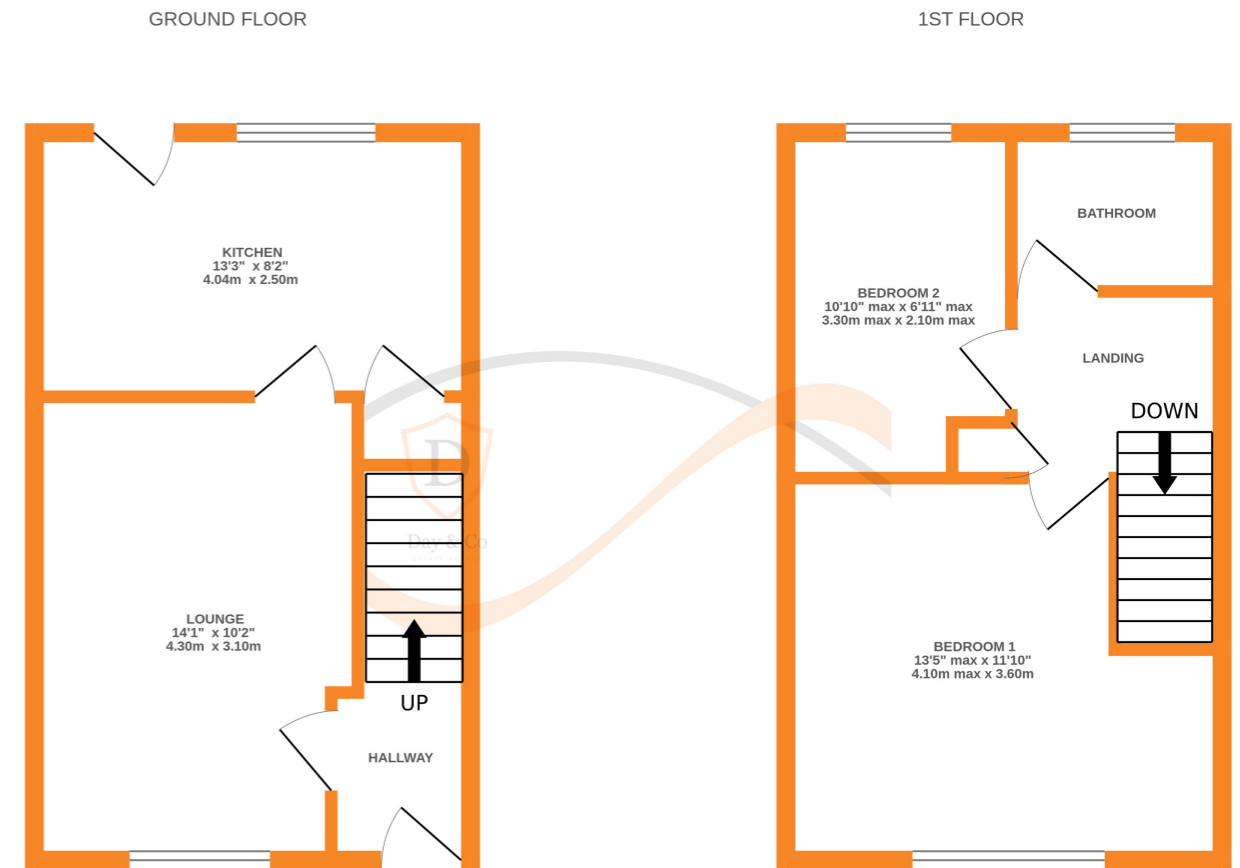

Whilst every attempt has been made to ensure the accuracy of the floorplan contained here, measurements of doors, windows, rooms and any other items are approximate and no responsibility is taken for any error, omission or mis-statement. This plan is for illustrative purposes only and should be used as such by any prospective purchaser. The services, systems and appliances shown have not been tested and no guarantee as to their operability or efficiency can be given.  
Made with Metropix ©2026