

£195,000 Leasehold

Pater Court, Portland Way, Knowle, Hampshire PO17 5GN



- Ground Floor
- Semi-Open-Plan Kitchen/Reception Room
- Parking Space
- Approx. 716 Sqft Gross Internal Area
- Modern Double Glazing and Gas Central Heating
- Attractive Communal Grounds

GENERAL DESCRIPTION

A well-presented, ground-floor flat in the village of Knowle. Pater Court is part of a modern development constructed in a period style to compliment the converted Victorian-era hospital that it surrounds. The property available features a dual-aspect reception room with bay window. There is a sleek, semi-open-plan kitchen, an eighteen-foot main bedroom, a second, comfortable, double bedroom and a bathroom with travertine-style tiles. The bedrooms, kitchen and living room side window all face a pleasant area of lawn, hedgerow and trees. A pair of storage/utility cupboards have been provided in the entrance hallway and well insulated walls, modern double glazing and gas central heating make for a good energy-efficiency rating. The flat comes with use of a parking space or, alternatively, Fareham Station can be reached by bus and offers services to a number of destinations including Portsmouth, Southampton, Brighton and London Waterloo.

Tenure: Leasehold (125 years from 01/05/2010).

Service Charge: £168.26 per month (subject to annual review).

Council Tax: Band C, Winchester City Council.

Please Note: This property is currently part-owned by A2Dominion Housing Association but is offered as a 100% open-market sale. Upon completion, the full leasehold title would transfer to the buyer.

This property is offered for sale in the condition seen. As a general rule, fitted domestic appliances are included in the sale; non-fitted appliances are not. If you require confirmation, you must request this in writing from Urban Moves. The information in this document supersedes any information given verbally either in person or by telephone. Pets not permitted (except assistance animals).

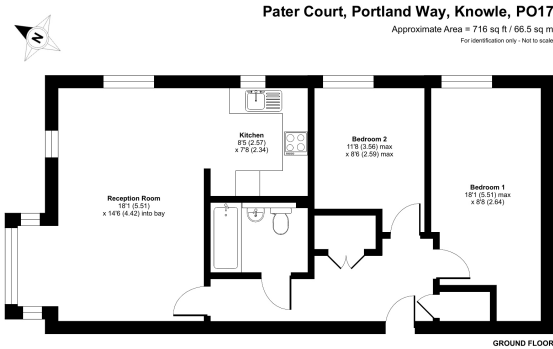

Certified Property Measure Floor plan produced in accordance with RICS Property Measurement Standards incorporating International Property Measurement Standards (IPMS) Standard - Gradebook 2014 Produced for Urban Moves REF: 1144205

DIMENSIONS

GROUND FLOOR

Entrance Hallway

Reception Room

18' 1" x 14' 6" into bay (5.51m x 4.42m)

Kitchen

8' 5" x 7' 8" (2.57m x 2.34m)

Bedroom 1

18' 1" max. x 8' 8" (5.51m x 2.64m)

Bedroom 2

11' 8" max. x 8' 6" max. (3.56m x 2.59m)

Bathroom

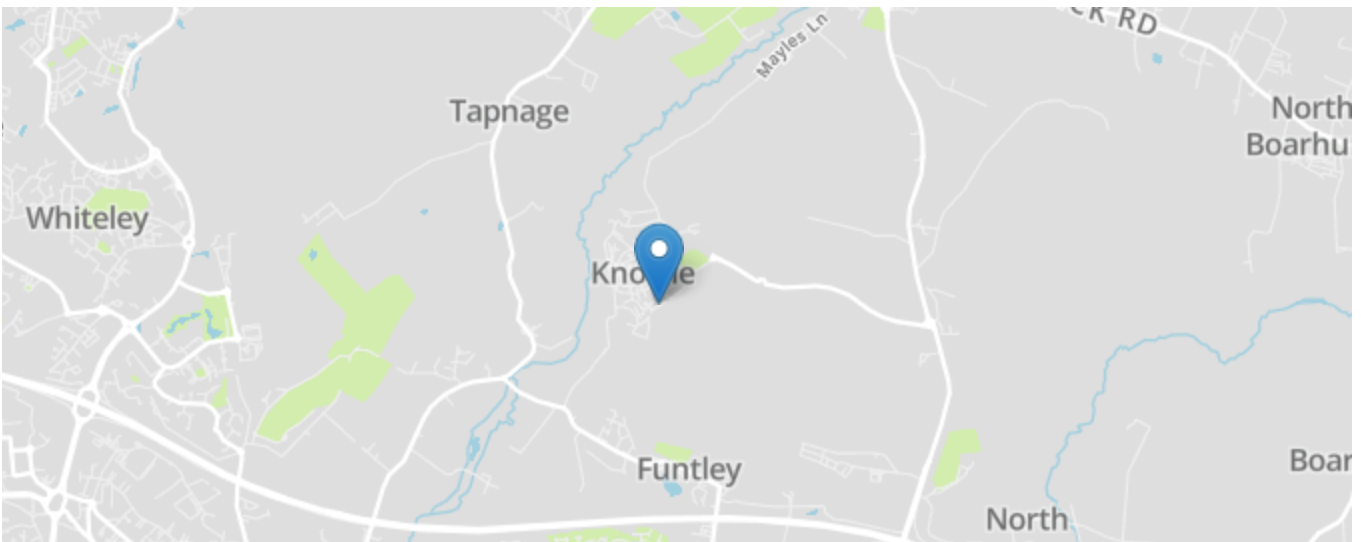
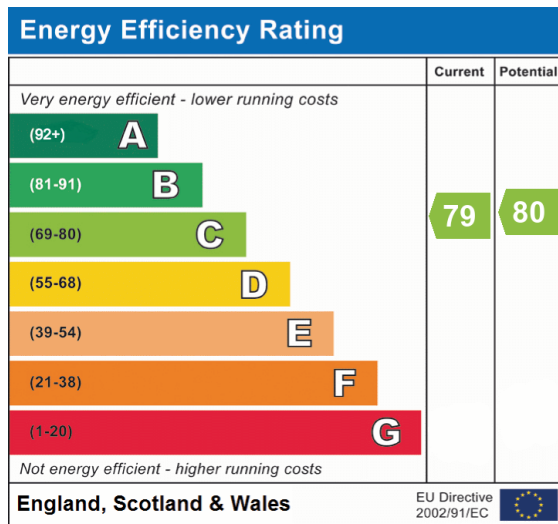

All content shown is to be used as a general guideline for the property. None of the contents of this document constitute part of an offer or contract. All measurements, photographs, floor-plans and data provided are only a guideline and should not be relied upon.