



Meadow View, Kew,
Southport, PR8 6PW

Offers Over £100,000

SM

STEPHANIE MACNAB
ESTATE AGENT

Enjoying a peaceful ground-floor position within this well-maintained development, this one-bedroom flat at Meadow View offers comfortable, low-maintenance living with the added benefit of access to communal gardens and resident parking.

The property is ideally suited to downsizers, first-time buyers or those seeking a well-located bolt-hole close to local amenities and transport links, as well as Southport General Hospital.

Internally, the accommodation is well-presented and ready for immediate occupation. A bright hallway with useful storage leads to a generous double bedroom and a modern bathroom with a white suite. The living room is a lovely, light-filled space with a pleasant outlook, and the separate kitchen features an electric oven and hob, ample cupboard space, and room for appliances.

Outside, residents enjoy attractively landscaped communal gardens and off-road parking within the development.

With its well-maintained surroundings, secure communal entrance, and friendly neighbourhood feel, Meadow View continues to be a popular choice for those seeking convenience, comfort, and a sense of community.

Call today to arrange a viewing on 01704 516 626. Follow us on Facebook and Instagram.





Ground Floor

Approx. 39.0 sq. metres (419.4 sq. feet)

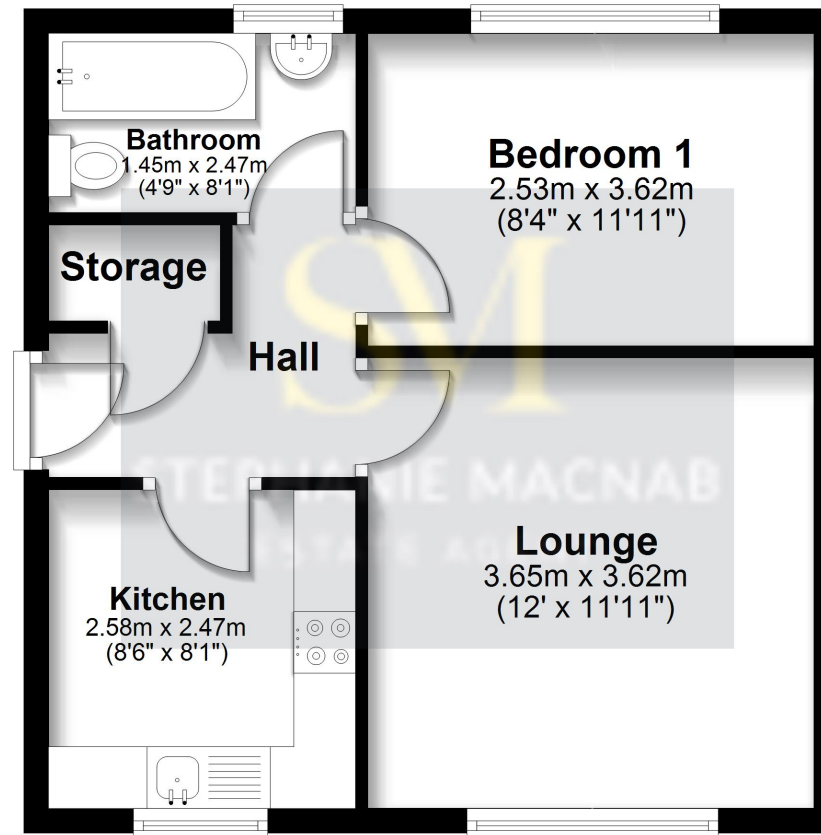

Total area: approx. 39.0 sq. metres (419.4 sq. feet)

This floorplan is for illustrative purposes only and is not to scale.
Plan produced using PlanUp.

Energy Efficiency Rating		
	Current	Potential
Very energy efficient - lower running costs		
(92+)	66	76
A		
(81-91)		
B		
(69-80)		
C		
(55-68)		
D		
(39-54)		
E		
(21-38)		
F		
(1-20)		
G		
Not energy efficient - higher running costs		
England, Scotland & Wales		
EU Directive 2002/91/EC		

