



Two Bedroom Bungalow  
Maidstone Road, Wigmore, Gillingham, Kent, ME8 0LQ

Guide Price £350,000  
Freehold

Maidstone Road, Wigmore, Gillingham, Kent, ME8 0LQ

Guide Price £350,000

Freehold

## Description

Guide Price - £350,000 - £375,000.

Offered with no forward chain, this well presented two bedroom semi detached bungalow is located in the sought after area of Wigmore. Move in with confidence, as the owners installed a new Ideal combination boiler in 2023 covered by a five-year guarantee, and they also updated pipework and radiators in the lounge, kitchen, hallway, and both bedrooms,. Step inside to a spacious hallway that leads you to a generously sized main bedroom with a charming bay window, a second double bedroom, and a modern shower room with a Mira electric shower fitted in 2023. The bright and inviting lounge features a stylish fireplace and sliding doors that open onto the garden, while the shaker-style kitchen is equipped with a built-in fridge/freezer, oven, and electric hob. Outside, the rear garden offers a peaceful retreat, with a patio area, well-maintained lawn, and attractive plant and shrub borders. Side access leads to the front of the property, where you'll find a neatly presented garden, a private driveway, and a garage that includes a brand-new fuse board. Ideally situated on a bus route with excellent access to the M2 motorway, this home is also conveniently close to local amenities, including Hempstead Valley Shopping Centre and a range of shops in Wigmore.

Don't miss out, contact the Greyfox Sales Team in Rainham today to arrange your viewing.

## Key Features

- No Forward Chain
- Semi Detached Bungalow in Popular Wigmore
- Two Double Bedrooms
- Ideal Combination Boiler Fitted 2023
- Driveway & Garage
- Ready To Move In
- Close To Shops, Public Transport, Schools & Local Amenities
- Flat Garden 30ft x 50ft approx

## Local Area

Wigmore is a popular residential area to the south of Gillingham and east of Hempstead, Initially a small holding area the location has grown and offers a variety of amenities, good connections to the A2/M2, M25 and Bluewater. The local rail station is located at Rainham with good access to London.

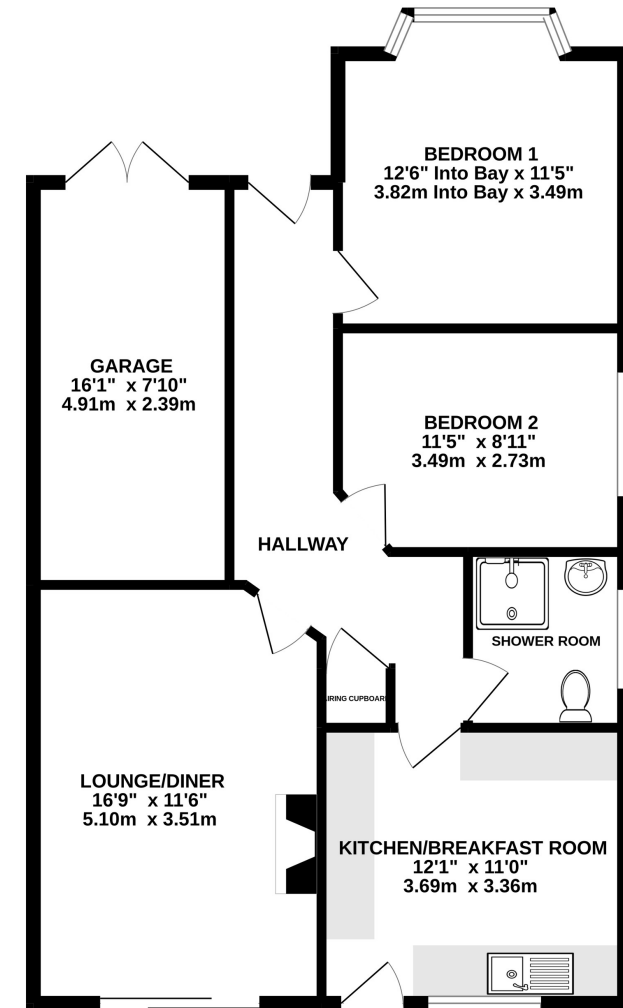

TOTAL FLOOR AREA : 837 sq.ft. (77.8 sq.m.) approx.

Whilst every attempt has been made to ensure the accuracy of the floorplan contained here, measurements of doors, windows, rooms and any other items are approximate and no responsibility is taken for any error, omission or mis-statement. This plan is for illustrative purposes only and should be used as such by any prospective purchaser. The services, systems and appliances shown have not been tested and no guarantee as to their operability or efficiency can be given.  
Made with Metropix ©2022



### Property Location

Maidstone Road, Wigmore, Gillingham, Kent, ME8 0LQ

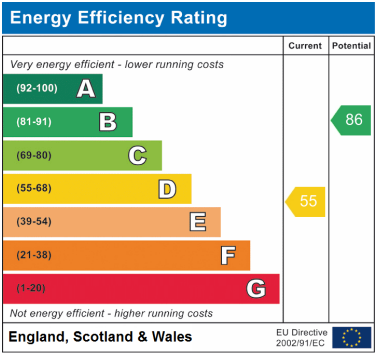
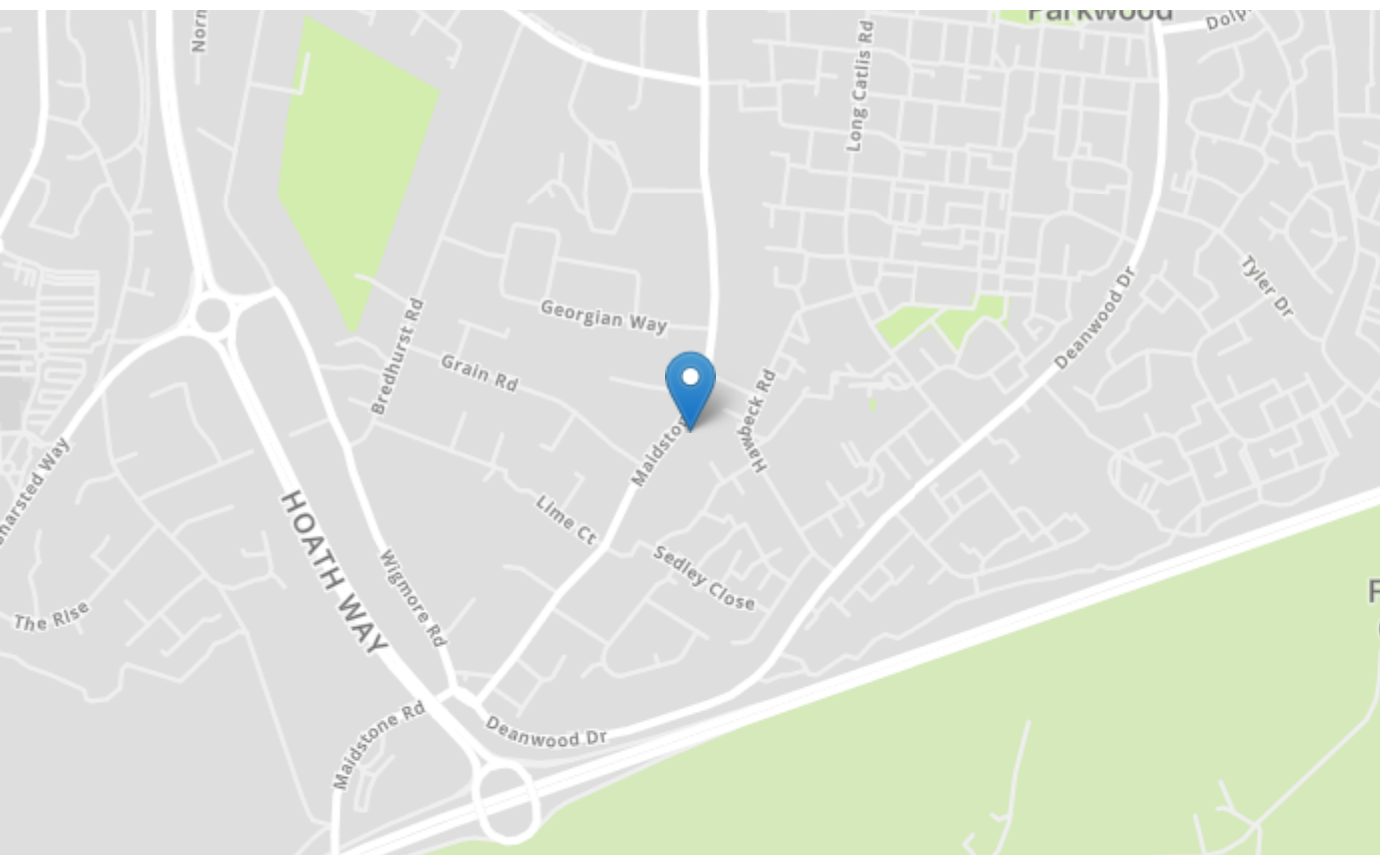

Tenure	Freehold
Lease Term	N/A
Ground Rent	N/A
Service Charge	N/A
Local Authority	Medway
Council Tax	Band D

**Greyfox Walderslade**  
 Unit 2, Thetford House  
 Walderslade Village Centre  
 Walderslade Road  
 Chatham  
 Kent  
 ME5 9LR  
 Tel: 01634 672227 Email:  
 walderslade@greyfox.co.uk

**Greyfox Rainham**  
 67C High Street  
 Rainham  
 Kent  
 ME8 7HS  
 Tel: 01634 377737 Email:  
 rainham@greyfox.co.uk

**Agent Notes**  
 These particulars are prepared as a general guide to a broad description of the property and should not be relied upon as a statement or representation of fact and do not constitute part of an offer or contract. The seller does not make or give nor do our employees or Greyfox have authority to make or give any representation or warranty to the property. We have not carried out a structural survey and the services, appliances and specific fittings have not been tested. All photographs, measurements, floorplans and distances referred to are given as a guide only and should not be relied upon for the purchase of carpets or any other fixtures or fittings. Lease details, service charges and ground rent (where applicable) and council tax are given as a guide only and should be checked and confirmed by you on inspection and your solicitor prior to exchange of contracts. If there are any points of particular importance to you we will be pleased to check the information for you and to confirm that the property remains available. This is particularly important should you be travelling some distance to view and where statements have been made by us to the effect that the information has not been verified. The copyright of all details, photographs and floorplans remain exclusive to Greyfox. For details of our privacy policy and referral fee arrangements with any of our selected partner companies please visit <https://www.greyfox.co.uk/legal/privacy> and <https://www.greyfox.co.uk/referral-fees>.