



5 Mill View Road, Bexhill-on-Sea, East Sussex,  
TN39 5HD

**£395,000**



- Modern & Immaculate Decor Throughout
- Internal lobby - Hall with Sky lantern
- Fitted kitchen with central island unit
- Spacious main reception with feature sky lantern
- Separate family dining room plus sitting room
- Ground floor WC and utility area
- Courtyard style entrance
- Immaculate and contemporary decor throughout
- Four bedroom detached family home
- ( Annex with wet room style en-suite)
- Two first floor bedrooms plus attic room
- First floor bathroom and separate shower room
- Offering flexible and versatile accommodation
- An immaculately Presented Detached Family Home
- Newly fenced and lawned rear garden
- Enclosed parking area to the front
- Offered for sale with no onward chain
- Situated close to excellent shops and transport
- Three family bedrooms and self-contained annex
- Call our Bexhill Team on 01424 224488
- Internal viewing highly recommended



GROUND FLOOR  
1375 sq.ft. (127.5 sq.m.) approx.

1ST FLOOR  
438 sq.ft. (40.7 sq.m.) approx.

2ND FLOOR  
214 sq.ft. (19.9 sq.m.) approx.

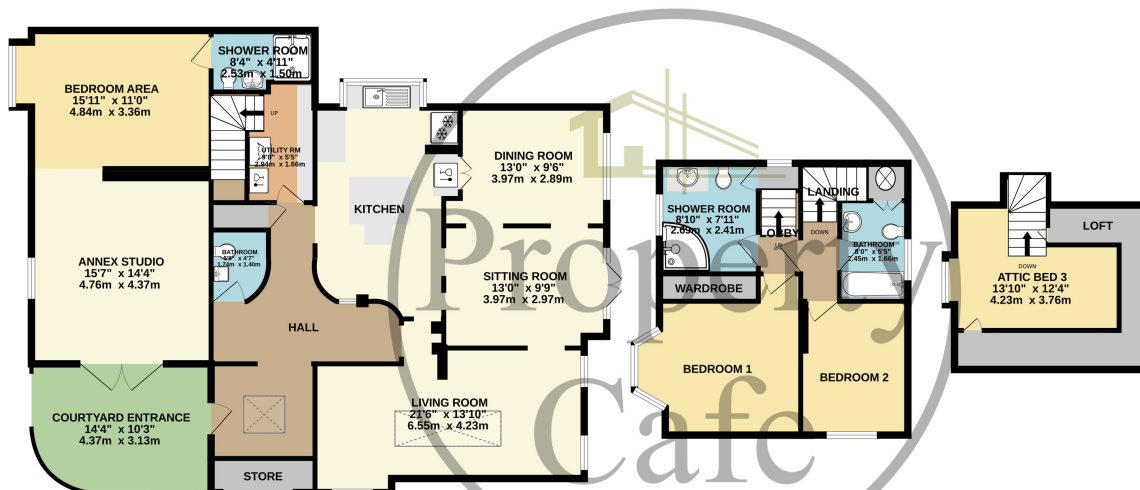

TOTAL FLOOR AREA : 2025 sq.ft. (188.1 sq.m.) approx.

Whilst every attempt has been made to ensure the accuracy of the floorplan contained here, measurements of doors, windows, rooms and any other items are approximate and no responsibility is taken for any error, omission or mis-statement. This plan is for illustrative purposes only and should be used as such by any prospective purchaser. The services, systems and appliances shown have not been tested and no guarantee as to their operability or efficiency can be given.

Made with Metropix ©2024

