

ROBINSONS MEADOW

£199,950

Key Features

- ✓ Set in a cul-de-sac location with no passing traffic.
- ✓ A Mid-Terraced House.
- ✓ Two Bedrooms.
- ✓ Enclosed Garden.
- ✓ Off Road Parking.
- ✓ No Onward Chain.



GROUND FLOOR
286 sq.ft. (26.6 sq.m.) approx.

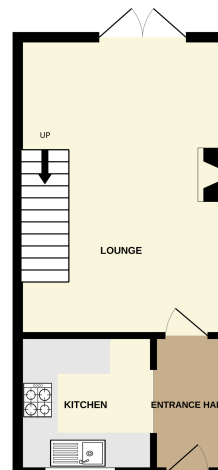

1ST FLOOR
290 sq.ft. (27.0 sq.m.) approx.

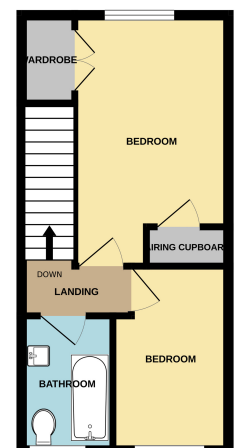

TOTAL FLOOR AREA: 577 sq.ft. (53.6 sq.m.) approx.
Made with MergeX 2025