

Arora Tower, 2 Waterview Drive, Greenwich. SE10 0TW.

£2,000

One bedroom Apartment - Set on the bank of the River Thames beside the O2 Arena. The Arora Tower introduces a whole new concept in luxury, private residences to London. The Arora Tower residents can take advantage of a range of premier services provided by the adjacent 5-star hotel, including full access to its pool, gym, spa, restaurants and bars.

Viewing by appointment with 1st avenue.

Call: 020 8293 8600

1st avenue, 128 Metcalfe Court, West Parkside, London SE10 0EL
email: info@1stavenue.co.uk

23 Arora Tower, 2 Waterview Drive, £2,000 Greenwich, . SE10 0TW.

1stavenue
Real Estate Services

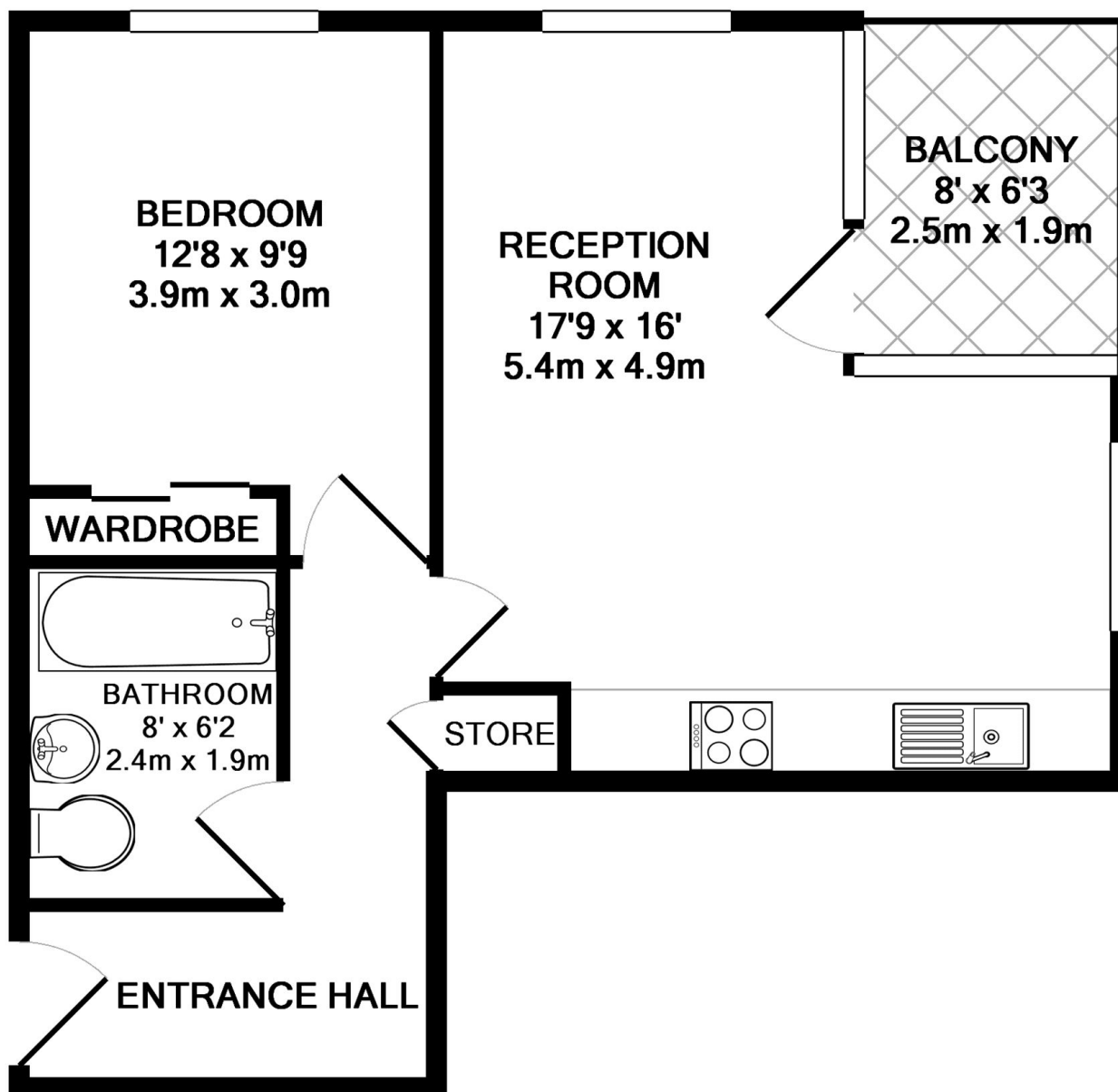

TOTAL APPROX. FLOOR AREA 476 SQ.FT. (44.2 SQ.M.)

Whilst every attempt has been made to ensure the accuracy of the floor plan contained here, measurements of doors, windows, rooms and any other items are approximate and no responsibility is taken for any error, omission, or mis-statement. This plan is for illustrative purposes only and should be used as such by any prospective purchaser. The services, systems and appliances shown have not been tested and no guarantee as to their operability or efficiency can be given

Made with Metropix ©2016

Viewing by appointment with 1st avenue.

Call: 020 8293 8600

1st avenue, 128 Metcalfe Court, West Parkside, London SE10 0EL
email: info@1stavenue.co.uk

1stavenue
Real Estate Services